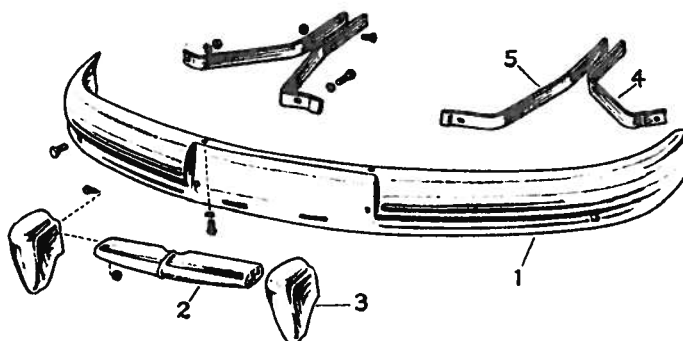
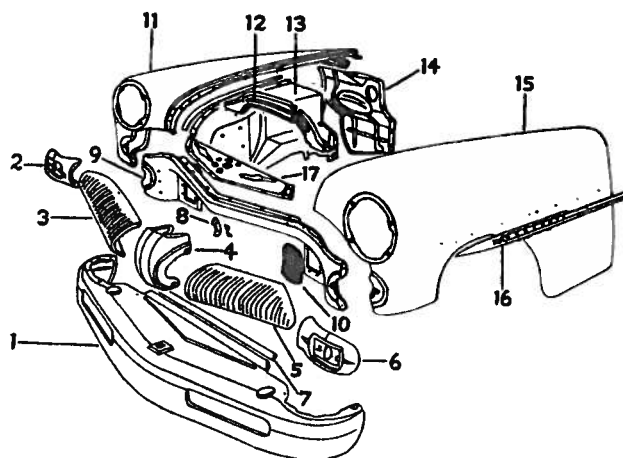

MERCURY 1949 thru 1951 BODY PARTS**Models 9M, 0M and 1M. ALL BODY STYLES****Front Bumper***All Models**See Fig. 1*

1 BUMPER IMPACT BAR	
0M-17757—1949 to 1950.....	34.50
1M-17757—1951	43.00
2 RADIATOR GRILLE GUARD	
0M-17768-A—1949 to 1950 ...	3.10
3 BUMPER GUARD	
8M-17996-A—1949 to 1950....	7.75
1M-17996-A—1951	9.50
4 BUMPER OUTER HANGER	
8M-17754—1949 (right*)	2.29
0M-17754—1950 (right*)	2.53
1M-17754—1951 (right*)	4.28
5 BUMPER INNER HANGER	
0M-17766—1949 (right*)	3.00
0M-17766—1950 (right*)	3.00
1M-17766—1951 (1951 inner bumper brkt. is one piece)...	8.60

**Fig. 1—Front Bumper****Front End Sheet Metal***All Models**See Fig. 2*

1 FRONT BUMPER STONE DEFLECTOR	
8M-17744-C—1949 to 1950, 9M, 0M	22.85
1M-17744—1951, 1M	22.85
2 GRILLE EXTEN. ASSY.	
0M-8224—1950 (right)	3.83
1M-8376-A—1951 (right)	5.60
3 RADIATOR GRILLE	
8M-8150-B—1949 to 1950 (right)	14.05
1M-8150—1951 (right*)	15.80
4 GRILLE CENTER ORNAMENT	
8M-8158—1949	9.50
0M-8158—1950	6.90
1M-8363-A—1951, center bar..	3.35
5 RADIATOR GRILLE	
8M-8150-B—1949 to 1950 (right*)	14.05
1M-8150-A—1951 (right*)....	15.80
6 GRILLE EXTENSION	
0M-8225—1950 (left)	3.83
1M-8377—1950 (left)	5.60
7 FRONT STONE DEFLECTOR SEALER	
8M-17740-C—1949 to 195122
8 HOOD CATCH HOOK	
8M-16896—1949 to 195133

**Fig. 2—Front End Sheet Metal**

9 GRILLE-OPENING PANEL		14 FRONT FENDER APRON SPLASH APRON	
8M-8190-B—1949	18.65	8M-16032-B—1949 (right*) ...	4.7
0M-8190—1950	18.62	8M-16032-C—1950 to 1951 (right*)	4.7
1M-8190-A—1951	11.50		
10 VENT. AIR SCREEN		15 FRONT FENDER	
8M-8716—194912	8M-16006-B—1949, 9M (left) ..	38.5
0M-7201900—1950 to 195112	0M-16006-B—1950, 0M (left) ..	38.5
11 FRONT FENDER		0M-16006-B—1950, 0M (left) ..	38.5
8M-16005-B—1949, 9M (right) ..	38.35	1M-16006-A—1951, 1M (left) ..	38.5
0M-16005-B—1950, 0M (right) ..	38.35		
0M-16005-B—1950, 0M (right) ..	38.35	16 FRONT FENDER MLDG.	
1M-16005-A—1951, 1M (right) ..	38.35	8M-16003—1949, 9M (right*) ..	4.0
12 RAD. CENTER AIR DEFLECTOR		0M-16003—1950, 0M exc. 72C (right*)	3.9
8M-8327-A—194990	0M-16003-B—1950, 0M, 72C (right*)	3.9
1M-8327—1950 to 1951	2.33	1M-16003-A—1951, 1M (right*)	3.9
13 FRONT FENDER APRON		17 HOOD LOCKING PLATE	
8M-16054-A—1949, 9M (right*)	17.50	8M-8162-B—1949 to 1950, 9M, 0M	4.2
8M-16054-B—1949, 9M (right*)	17.50	1M-8162—1951, 1M	4.2
0M-16054—1950, 0M (right*) ..	17.50		
1M-16054—1951, 1M (right*) ..	17.50		

* Opposite side one part number higher

BODY PARTS 1949 thru 1951 MERCURY

Models 9M, 0M and 1M. ALL BODY STYLES

Hood Assembly

All Models

See Fig. 3

1 LOWER HOOD ORNAMENT 0M-16606—1950, used with 0M-16611 hood	5.47
2 HOOD FRONT ORNAMENT 8M-16607—1949 to 1950	4.07
1M-16607—1951	9.91
3 HOOD TOP ORNAMENT 8M-16850—1949 to 1951, exc. 72C	8.00
0M-16850—1950 to 1951, 72C, 0M72C, 1M72C	11.55
4 HOOD ASSY. 1M-16611—1949 to 1951.....	75.45
Note: Use ornament 1M-16607 for 1949-50 cars.	
5 REINFMT. TO HOOD ANTI- RATTLER 8M-16739-B—1949 to 195118
6 HOOD REAR REINFMT. & BRACKET 8M-16672—1949 to 1951	11.11
7 HOOD HINGE LINK & BRKT. 8M-16796—1949 to 1951.....	2.60
8 HOOD SUPPORT SPRING 99A-16789—1949 to 1951.....	.24
9 HOOD SUPT. ASSY. 8M-16782—1949 to 1951 (right*)	2.25

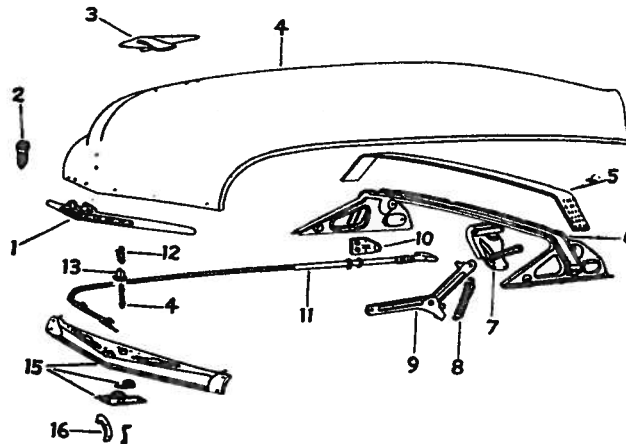

Fig. 3—Hood—1950—All Models

Note—With the exception of hood ornaments, all other parts are used on 1949 models.

10 HOOD CONTROL BRKT. 8M-16930-C—1949 to 1951, exc. 7633
8M-16930-D—1949 to 1950, 9M76, 0M7633
0M-16930—1951, 1M7630
11 HOOD CONTROL CABLE ASSY. 8M-16916—1949 to 1951.....	1.64
12 HOOD LOCK SPRING 8M-16925—1949 to 1951.....	.10
13 HOOD LOCK SPRING GUIDE 11A-16927—1949 to 195117
14 HOOD LOCK DOWEL 0M-16929—1949 to 195117
Note: This item is marked No. 4 on picture.	
15 GRILLE HOOD LOCKING PLATE ASSY. 8M-8162-B—1949 to 1950, 9M, 0M	4.23
1M-8162—1951, 1M	4.23

Parking Lamp

All Models

See Fig. 4

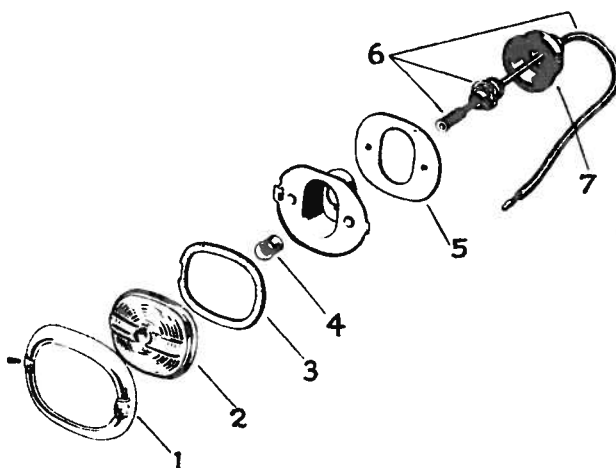

Fig. 4—Parking Lamp—1949 Illustrated

PARKING LAMP ASSY. 7RA-13200—1949, one wire... 8M-13200-A—1949, two wire.. 0M-13200-A—1950 (right*) .. 1M-13200-A—1951 (right*) ..	6.90 6.90 6.90 8.60
1 PARKING LAMP RIM OR DOOR 7RA-13210—1949	1.70
0M-13236-A—1950 (right*) ..	2.25
1M-13210—1951 (right*)	3.45
2 PARKING LAMP LENS 7RA-13208—1949 "MPT-48" .. 0M-13208—1950 "MPT-50" ... 1M-13208—1951 "MPT-51-R" (right*)33 .52 .93
3 LENS GASKET 7RA-13211—194908
0M-13211—195012
1M-13211—195112
4 PARKING LAMP BULB (21-3 CP) 11A-13465—1949 to 1951, off- set pin base.....	.36
5 PARKING LAMP PAD 7RA-13217—194912

* Opposite side one part number higher

MERCURY 1949 thru 1951 BODY PARTS

Models 9M, 0M and 1M. ALL BODY STYLES

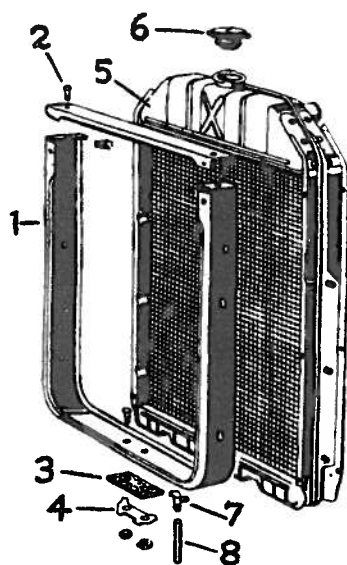

Fig. 5

Radiator & Braces

All Models

See Fig. 5

1 RADIATOR SUPT. ASSY.	
0M-16138—1949, 1950 and 1951	5.83
2 RADIATOR & FENDER SUPT. BAR	
8M-16156—1949 to 1951	1.12
3 RAD. SUPT. PAD	
8M-16186—1949 to 1951	.05
4 SUPT. LOCKING PLATE	
356595-S—1949 to 1951	.05
5 RADIATOR ASSY.	
0CM-8005-A—1949 to 1951	86.20
1CM-8005-A—1950 to 1951	
w/Merc-o-matic	86.20
6 RAD. CAP	
26H-8100-B—1949 to 1951	1.71
1M-8100-B—1950 to 1951	
w/Merc-o-matic	1.08

7 RAD. DRAIN COCK	
48-8115—1949 to 1951, offset handle	.83
8CM-8115-A—1949 to 1951, wing type handle	.50

8 CYL. DRAIN COCK EXTEN. HOSE	
8M-8081—1949 to 1951	.05

Head Lamp

All Models

See Fig. 6

1 HEADLAMP RIM	
0A-13045-B—1949 to 1950	2.15
1A-13045-B—1951	2.59
2 HEADLAMP BULB RETAINER RING	
0A-13018-B—1949 to 1951	1.33
3 SEALED BEAM UNIT (Bulb)	
09A-13007—1949 to 1951	1.43
4 HEADLAMP ADJ. SCREW	
8A-13032—1949 to 1951	.06
5 HEADLAMP BALL RING SPRING	
11A-13031—1949 to 1951	.05
6 HEADLAMP ASSY. (Less Bulb)	
8M-13002—1949 to 1950, early	7.33
0M-13002—1949 to 1950, late	7.33
1M-13002—1951	7.33
7 HEADLAMP WIRING ASSY.	
51A-13076-B—1949 to 1950	1.28
1M-13076-A—1951	1.02
8 HEADLAMP WIRE GROMMET	
Serviced with wiring assy. 51A-13076-B	1.28
9 HEADLAMP TO FENDER GASKET	
11A-13044-A—1949 to 1951	.29

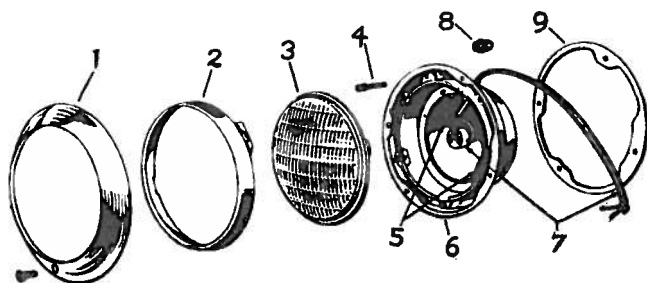

Fig. 6—Head Lamp, All Models

* Opposite side one part number higher

Windshield

All Models

See Fig. 7

1 CENTER WTHSTP. RETAINER	
8L-7003078—1949, exc. 79	1.1
8M-7903078—1949, 9M79	1.1
0M-7203078—1950 to 1951, 1M72A gray	1.1
8L-7003078—1950 to 1951, 1M72B, 74, 76	1.1
8M-7903078—1950 to 1951, 1M79, 0M79	1.1
2 OUTER FINISH MLDG.	
8L-7003088—1949, exc. 79 (right*)	4.1
8M-7903088—1949 to 1952, 79 (right*)	2.1
8L-7003088—1950 to 1951, exc. 79 (right*)	4.1
3 WDSHD. GLASS	
8M-7003100—1949 to 1951, exc. 79	15.3
7A-7903100—1949 to 1951, 79..	16.9
4 WDSHD. WTHSTP.	
8M-7003110-A—1949, 72, 74 (right*)	9.1
8M-7603110-A—1949, 76 (right*)	7.1
8M-7903110-A—1949, 79 (right*)	3.7
0M-7203110—1950 to 1951, 72A	6.9
8M-7003110-A—1950 to 1951, 72B, 74	9.0
8M-7603110-A—1950 to 1951, 76	7.1
8M-7903110-A—1950 to 1951, 79 (right*)	3.7
5 WDSHD. OPENING FINISH STRIP	
8M-7003590-AP—1949, 72, 74, blue (right*)	2.4
8M-7603590-AP—1949, 76 (right*)	2.4
8M-7903590-AB—1949, 79 (right*)	3.1
0M-7203590-AP—1950, 72A, B, 74, prime (right*)	2.4
0M-7603590-AP—1950, 76, prime (right*)	2.4
8M-7903590-AB—1950, 79, mahogany (right*)	3.1

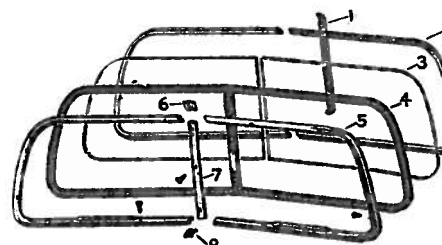

Fig. 7

BODY PARTS 1949 thru 1951 MERCURY

Models 9M, 0M and 1M. ALL BODY STYLES

0M-7203590-BP—1951, 72A, B, 74, prime (right*)	2.47	8 COWL SIDE PILLAR & PANEL ASSY.		15 LUGGAGE COMPT. DOOR	
0M-7603590-BP—1951, 76 (right*)	2.47	8M-7002042—1949 (right*) ...	15.42	0M-7240112-A—1949-50	45.10
0M-7903590-AA—1951, 79, mahogany (right*)	3.33	0M-7202042-A—1950 (right*) ..	23.43	1M-7240112-A—1951	38.05
Note: Other color strips are available.		0M-7202042-B—1951 (right*) ..	23.43	16 REAR FLOOR PAN ASSY.	
6 UPPER FINISH STRIP PLATE		9 DOOR UPPER HINGE ASSY.		8M-7011215—1949	33.45
8M-7003084—1949, exc. 7612	8M-7022800—1949 (right*) ...	2.79	8M-7911215—1950	65.50
8M-7603084—1949, 7629	0M-7222800—1950 (right*) ..	2.79	0M-7911215—1951	62.45
8M-7003084-AP—1950 to 1951, 72A, B, 74, prime12	0M-7222800—1951 (right*) ...	2.79	17 FRONT FLOOR PAN ASSY.	
8M-7603084-AP—1950 to 1951, 76, prime29	10 DOOR LOWER HINGE ASSY.		8M-7011135—1949 to 1951....	22.50
8M-7903084-AP—1950, 79, mahogany24	0M-7022810—1949 (right*) ...	2.59	18 FLOOR TRANS. COVER PLATE ASSY.	
8M-7903084-AB—1951, 79, mahogany19	0M-7222810—1950 (right*) ...	2.59	8M-7012115-A—1949, tunnel width 10½ in.; 1951	6.57
7 CENTER WTHSTP. INNER RETAINER		0M-7222810-B—1951 (right*) ..	2.59	8M-7012115-B—1949, tunnel width 15 in.	5.67
8M-7003076-A—1949, 72, 74 ...	1.71	11 DOOR ASSY. (Prime, less trim & hdw.)		1M-7212115-A—1951	7.78
8M-7903076—1949, 79	1.79	8M-7020122-C—1949 (right*) ..	77.50	1M-7212115-B—1951, Merc-o-matic	7.81
0L-7203076-AP—1950 to 1951, 72A, prime	1.54	0M-7220122-B—1950 (right*) ..	77.50	19 FLOOR SIDE MEMBER	
8M-7003076-A—1950 to 1951, 72B, 74	1.71	0M-7220122-B—1951 (right*) ..	77.50	7A-7010118—1949 to 1951	7.71
0M-7903076-AA—1950 to 1951, 7986	12 QUARTER PANEL COMPLETE ASSY.		20 BODY ROCKER PANEL	
8 CENTER LOWER FINISH STRIP		8M-7227700-B—1949 (right*) ..	69.54	8M-7010128—1949 to 1951 (right*)	12.95
8M-7603086—1949, 7622	0M-7227700-D—1950 (right*) ..	62.05	21 REAR FENDER ASSY.	
8M-7603086-AP—1950 to 1951, 7622	1M-7227700-A—1951 (right*) ..	76.65	8M-16312-A—1949 to 1950 (right*)	17.00
		13 FUEL TANK FILLER LID ASSY.		1M-16312-C—1951 (right*) ...	12.06
		8M-7028611—1949 to 1950....	2.65	FUEL TANK ASSY.	
		1M-7228611—1951	1.29	8M-9002-A—1949 to 1951, wedge shaped	24.95
		14 LOWER BACK BODY PANEL			
		8M-7240320—1949 to 1950 (right*)	6.71		
		1M-7240320—1951 (right*) ..	6.71		

Sheet Metal

Body Type—72—6-Pass. Coupe

See Fig. 8

1 ROOF PANEL ASSY.	
0M-7250200—1949 to 1950	125.20
1M-7250200-B—1951	125.15
2 ROOF DRIP MLDG.	
8M-7251700—1949 to 1951 (right*)	1.53
3 ROOF SIDE RAIL REINFMT.	
1M-7051196—1949 to 1950 (right*)	1.71
1M-7251196—1951 (right*) ..	1.71
4 WDSHD. OPENING REINFMT. EXTEN.	
8M-7003618—1949 to 1951 (right*)	2.60
5 ROOF SIDE RAIL	
7A-7251184—1949 (right*) ..	8.10
7A-7951184—1950 to 1951 (right*)	5.09
6 DASH TO FRAME BRACE	
8M-7001726—1949	1.54
8M-7001714—1950 to 1951	2.66
7 DASH PANEL & BRACE ASSY.	
8M-7001614—1949	14.12
0M-7201614—1950	12.52
1M-7201614-E—1951	11.69

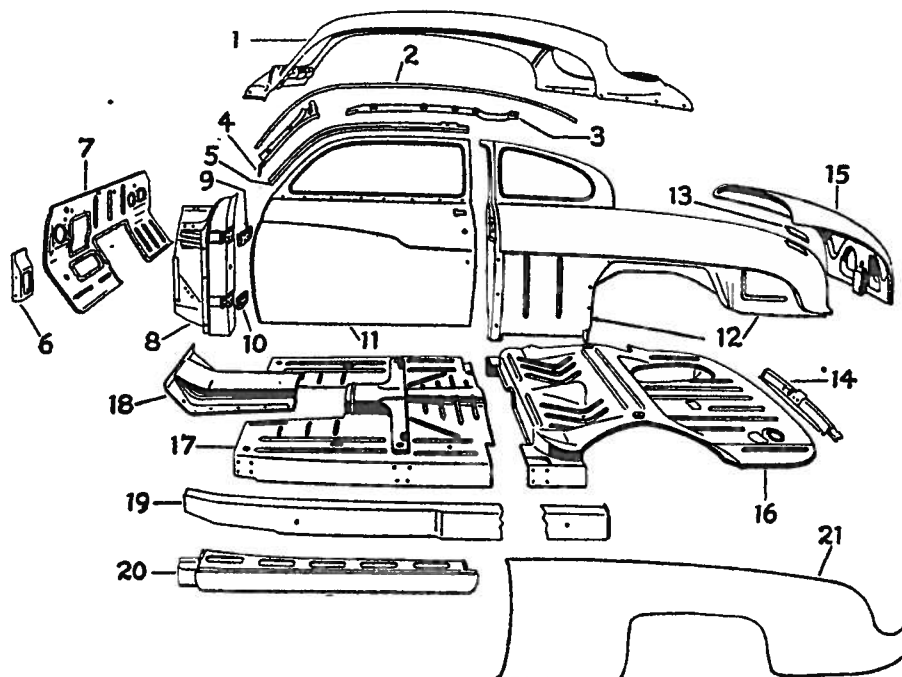

Fig. 8—Sheet Metal—Coupe Models

* Opposite side one part number higher

MERCURY 1949 thru 1951 BODY PARTS

Models 9M, 0M and 1M. ALL BODY STYLES

Door Assembly

Body Type—72—Coupe

See Fig. 9

1 DOOR ASSY. (Prime, less trim & hdw.)		
8M-7020122-C—1949 (right*)	77.50	
0M-7220122-B—1950 (right*)	77.50	
0M-7220122-B—1951 (right*)	77.50	
2 DOOR BELT MLDG.		
8M-7020934—1949 to 1950 (right*)	2.03	
8M-7020934—1951 (right*)	2.03	
3 DOOR TRIM MLDG. ASSY.		
8M-7020942-A—1949 (right*)	1.67	
0M-7220942-A—1950 (right*)	1.48	
1M-7220942—1951 (right*)	2.40	
4 DOOR TRIM LOWER MLDG. ASSY.		
8M-7020956-A—1949	1.38	
0M-7220956-A—1950	1.48	
5 W/W REVEAL MLDG. & WTHSTP.		
8M-7020984-B—1949 (right*)	4.72	
0M-7220984—1950 to 1951 (right*)	5.66	
6 SEE ITEM NO. 5		
7 VENT. WINDOW & FINISH STRIP		
8M-7021402-G—1950 (right*)	19.00	
8M-7021402-C—1949 (right*)	19.00	
7 VENT. WINDOW & FINISH STRIP		
0M-7221402—1951 (right*)	25.75	
8 DOOR GLASS LOCK SIDE RUN		
7A-7021550—1949 to 1951	.85	
9 DOOR WINDOW GLASS		
8M-7021410-A—1949 to 1951	9.25	
10 DOOR VENT. GLASS		
8M-7021412-A—1949	2.71	
8M-7021412-B—1950 to 1951	2.71	
11 DOOR GLASS CHAN. & BRKT.		
8M-7021458-A—1949 (right*)	1.47	
8M-7021458-A—1950 to 1951, manual (right*)	1.47	
8M-7021458-B—1950 to 1951, 72B, hydra. (right*)	1.26	
12 DOOR LOCK ASSY.		
8M-7021812—1949 (right*)	5.29	
0A-7021812—1950 to 1951 (right*)	3.36	
13 DOOR LOCK REMOTE CONTROL		
8M-7021818—1949 (right*)	2.62	
0M-7221818—1950 (right*)	.97	
1M-7221818—1951 (right*)	1.09	
14 DOOR LOCK SAFETY CATCH ROD		
8M-7021852-A—1949 (right*)	.09	
0M-7221852-A—1950 to 1951 (right*)	.05	

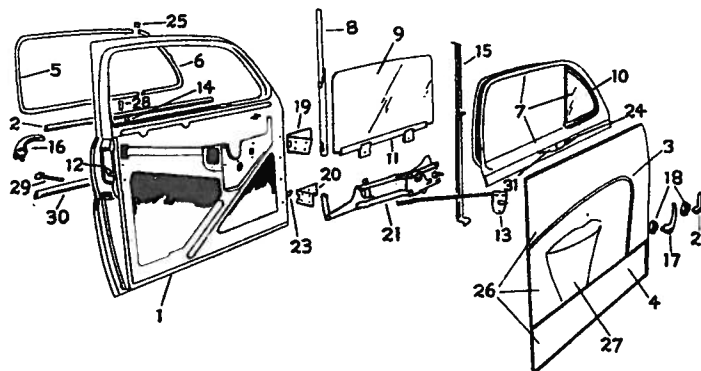

Fig. 9—Door Assembly—Body Type 72—Coupe

15 DOOR VENT. DIV. BAR & BRKT.		26 DOOR TRIM ASSY.	
8M-7022296-B—1949 (right*)	4.59	8M-7023942-C—1949, blue	
8M-7022204—1950 (right*)	6.98	(right*)	27.51
0M-7222204—1951 (right*)	3.85	0M-7223942-AN—1950, 72A,	
		dark blue (right*)	24.91
16 OUTER DOOR HANDLE		0M-7223942-AB—1950, 72B,	
8M-7022400-C—1949	3.26	dark blue (right*)	24.91
0M-7222400-A—1950 (right*)	2.50	1M-7223942-AE—1951, 72A,	
0M-7222400-B—1951 (right*)	2.50	light blue (right*)	24.91
		1M-7223942-AB—1951, 72B,	
17 INNER DOOR HANDLE		dark blue (right*)	24.91
8M-7022614-A—1949	1.26	Note: Other color trims are	
8M-7022614-B—1950	1.19	available.	
1M-7222600—1951	1.66		
18 INNER DOOR HANDLE		27 DOOR ARM REST ASSY.	
ESCUTCHEON		8M-7024140-C—1949, blue	
0M-7022618—1949 to 1951	4.0	(right*)	17.28
		0M-7224140-AN—1950, 72A,	
19 DOOR UPPER HINGE ASSY.		tan (right*)	8.61
0M-7222800-A—1949 (right*)	2.79	0M-7224140-AB—1950, 72B,	
0M-7222800-A—1950 (right*)	2.79	blue (right*)	8.60
0M-7222800-B—1951 (right*)	2.79	1M-7224140-AE—1951, 72A,	
		gray (right*)	5.58
20 DOOR LOWER HINGE ASSY.		1M-7224140-AB—1951, 72B,	
0M-7022810—1949 (right*)	2.59	blue (right*)	5.58
0M-7222810—1950 (right*)	2.59	Note: Other color rests are	
0M-7222810-B—1951 (right*)	2.59	available.	
21 DOOR WINDOW REGLTR.		28 DOOR LOCKING ROD KNOB	
8M-7023200-A—1949 (right*)	5.72	8A-7021850—1949	28
8M-7023200-C—1950 (right*)	5.84	8A-7021850-B—1950 to 1951	28
8M-7023200-B—1950 to 1951,			
hydra. (right*)	20.14		
1M-7223200—1951 (right*)	5.83		
22 DOOR WINDOW REGLTR.		29 DOOR LOCK CYL. & SLEEVE	
HANDLE		8H-7321984—1949 (right*)	2.21
8M-7023342-A—1949	2.15	0M-7221984-B—1950 (right*)	1.66
8M-7023342-B—1950	2.15	0M-7221984-B—1951 (right*)	1.66
1M-7223342	1.59		
23 DOOR CHECK ARM ASSY.		30 DOOR OUTER LOWER MLDG.	
8M-7023500—1949 to 1951	4.5	8M-7020938—1949 to 1951	
		(right*)	2.48
24 GARNISH MLDG. NAME INSERT		31 GARNISH MLDG. INSERT	
8M-7020988-A—1949	.90	RETAINER	
0M-7220988-B—1950	1.00	8M-7020946-A—1949	1.62
25 WINDOW REVEAL MLDG. CLIP			
7A-7020925—1949	.04		
8M-7020925—1950 to 1951	.04		

* Opposite side one part number higher

BODY PARTS 1949 thru 1951 MERCURY

Models 9M, 0M and 1M. ALL BODY STYLES

Moldings, Wheels & Glass

Body Type—72—Coupe
See Fig. 10

1 PARKING LAMP ASSY.	
7RA-13200—1949, one wire...	5.20
8M-13200-A—1949, two wire...	6.90
0M-13200-A—1950 (right*) ..	6.90
1M-13200—1951 (right*)	8.60
2 HEADLAMP SEALED BEAM UNIT	
09A-13007—1949 to 1951.....	1.43
3 HEADLAMP RIM	
0A-13045-B—1949 to 1951.....	2.15
1A-13045-B—1951	2.59
4 HOOD TOP ORNAMENT	
8M-16850—1949 to 1951, exc.	
72C	8.00
0M-16850—1950 to 1951, 72C ..	11.55
5 WDSHD. CENTER OUTER WTHSTP. RETAINER	
0M-7203078—1950 to 1951, 72A	1.12
8L-7003078—1950 to 1951, 72B	1.88
6 WDSHD. OUTER FINISH MLDG.	
8M-7203088—1949 to 1951 (right*)	2.24
6 WDSHD. OUTER FINISH MLDG.	
8L-7003088—1950 to 1951, 72B (right*)	4.19
7 WDSHD. GLASS	
8M-7003100—1949 to 1951	15.31
8 DOOR VENT. GLASS & FRAME ASSY.	
8M-7021407-A—1949 (left) ...	10.45
8M-7021406-B—1950 to 1951 (right*)	10.71
9 VENT. GLASS	
8M-7021412-A—1949	2.71
8M-7021412-B—1950 to 1951 ..	2.71
10 ROOF DRIP MLDG.	
8M-7251700—1949 to 1951	1.53
11 DOOR WINDOW OUTER REVEAL MLDG. & WTHSTP.	
8M-7020984-B—1949 (right*) ..	4.72
0M-7220984—1950 to 1951 (right*)	5.66
12 DOOR WINDOW GLASS	
8M-7021410-A—1949 to 1951 ..	9.25
13 QUARTER W/W FRAME & GLASS ASSY.	
7A-7230506—1949 to 1951 (right*)	20.24
14 QUARTER WINDOW GLASS	
8M-7229710-A—1949; 1950 to 1951, 72B	6.21
0M-7229710-A—1950 to 1951, 72A	7.26
15 BACK W/W OUTER END MLDG.	
8M-7242430-A—1949 (right*) ..	1.86

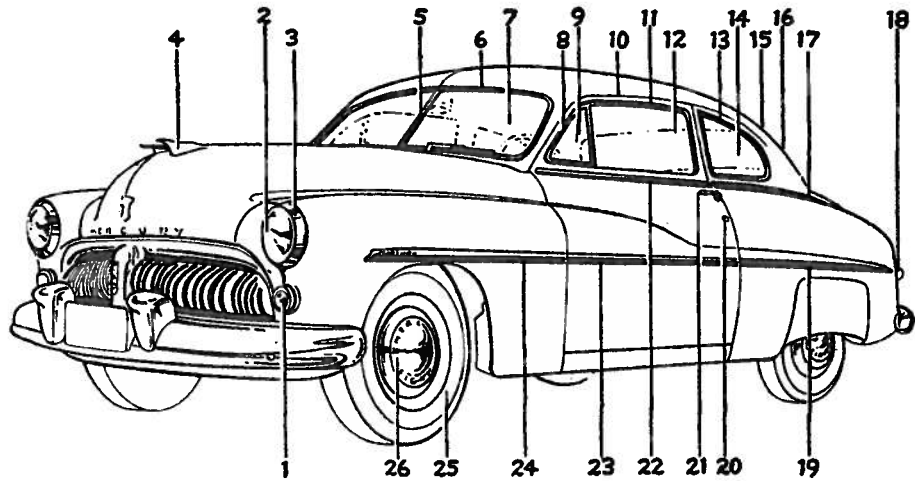

Fig. 10—Moldings, Wheels & Glass—Coupe Models

8M-7242430-C—1950 (right*) ..	1.86	25 FRONT WHEEL	
1M-7242430—1951, upper	2.57	0M-1015-AP—1949 to 1950 ...	8.19
		0M-1015-AP—1951	8.19
16 BACK W/W GLASS		26 WHEEL HUB CAP	
8M-7242018—1949, end	6.02	8M-1130—1949, stamped	
8M-7242016—1949, center	21.32	Mercury	3.00
8M-7242006—1950, one piece ..	34.29	26 WHEEL HUB CAP	
1M-7242006-A—1951, one piece	28.70	0M-1130-B—1950, not	
17 QUARTER BELT MLDG.		stamped	2.85
8M-7229034—1949 to 1951		1M-1137-A—1951	3.10
(right*)	1.78		
18 REAR LAMP ASSY.			
8M-13404-A—1949 to 1950....	9.90		
1M-13404-A—1951	10.10		
19 REAR FENDER MLDG.			
8M-16382-A—1949 to 1951, exc.			
0M72C (right*)	2.80		
0M-16382—1950, 0M72C			
(right*)	2.47		
20 DOOR LOCK ASSY.			
8M-7021812—1949 (right*) ...	5.29		
0A-7021812—1950 to 1951			
(right*)	3.36		
21 DOOR OUTER HANDLE			
(Complete)			
8M-7022400-C—1949	3.26		
0M-7222400-A—1950 (right*) ..	2.50		
0L-7222400-B—1951 (right*) ..	3.78		
22 DOOR BELT MLDG.			
8M-7020934—1949 to 1951			
(right*)	2.03		
23 DOOR LOWER SIDE MLDG.			
8M-7020938—1949 to 1951			
(right*)	2.48		
24 FRONT FENDER SIDE MLDG.			
8M-16003—1949 (right*)	4.00		
0M-16003—1950, exc. 72C			
(right*)	3.97		
0M-16003-B—1950, 72C			
(right*)	3.97		
1M-16003-A—1951 (right*) ...	3.97		

25 FRONT WHEEL	
0M-1015-AP—1949 to 1950 ...	8.19
0M-1015-AP—1951	8.19
26 WHEEL HUB CAP	
8M-1130—1949, stamped	
Mercury	3.00
26 WHEEL HUB CAP	
0M-1130-B—1950, not	
stamped	2.85
1M-1137-A—1951	3.10

Quarter Window

Body Type—72—Coupe

See Fig. 11

COMPLETE WINDOW ASSY.

8M-7229700-C—1949, blue	
(right*)	33.74
8M-7229700-AP—1950, prime	
(right*)	33.74
8M-7229700-BP—1951, prime	
(right*)	33.74

Note: For 1949 other colors are available.

1 WINDOW FINISH STRIP

8M-7229002-AP—1949, blue	
(right*)	9.76
0M-7229002-BP—1950 to 1951,	
72A, prime (right*)	10.80

continued

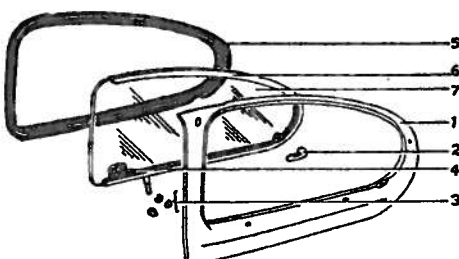

Fig. 11—Quarter Window

* Opposite side one part number higher

MERCURY 1949 thru 1951 BODY PARTS**Models 9M, 0M and 1M. ALL BODY STYLES****Quarter Window—
continued**

8M-7229002-AP—1950 to 1951, 72B, prime (right*)	10.80
Note: For 1949 other colors are available.	
2 GLASS FRAME HANDLE 78-735280—1949 to 1951	.39
3 GLASS FRAME PIVOT STOP 8M-7330552—1949 to 1951	.12
4 GLASS FRAME LOW. PIVOT CLAMP 8M-7030548—1949 to 1951	.12
5 WINDOW GLASS WTHSTP. 7A-7229904-A—1949 to 1951 (right*)	4.36
6 WINDOW FRAME & GLASS ASSY. 7A-7230506—1949 to 1951 (right*)	20.24
7 QUARTER W/W GLASS 8M-7229710-A—1949; 1950 to 1951, 72B	6.21
0M-7229710-A—1950 to 1951, 72A	7.26

Sheet Metal*Body Type 74—4 Door Sedan**See Fig. 12*

1 ROOF PANEL ASSY. 0M-7450200—1949	127.60
0M-7450200—1950	127.60
1M-7450200—1951	127.51
2 ROOF DRIP MLDG. 8M-7451700—1949 to 1951 (right*)	1.45
3 ROOF SIDE RAIL REINFMT. 8M-7451196—1949-50 (right*)	2.03
1M-7451196—1951 (right*)	2.03
4 QUARTER HINGE PILLAR ASSY. 8M-7428104-B—1949 (right*)	11.69
8M-7428104-B—1950-51 (right*)	11.69
8L-7428104—1950-51, hydra. (right*)	11.69
5 WDSHD. OPENING REINFMT. EXTEN. 8M-7003618—1949 to 1951 (right*)	2.60
6 ROOF SIDE RAIL 8M-7451142-B—1949 (right*)	11.40
8M-7451142-B—1950-51 (right*)	11.40
7 DASH TO FRAME BRACE 8M-7001726—1949 (right*)	1.54
8M-7001714—1950-51 (right*)	2.66
8 DASH PANEL ASSY. 8M-7001614-B—1949	14.12
0M-7201614—1950	12.52
1M-7201614-E—1951	11.69

9 COWL SIDE PILLAR & PANEL ASSY. 8M-7002042—1949 (right*)	15.42
0M-7202042-A—1950 (right*)	23.43
0M-7202042-B—1951 (right*)	23.43
10 FRONT DOOR UP. HINGE 0M-7022800-A—1949 (right*)	2.79
0M-7222800-A—1950 (right*)	2.79
0M-7222800-B—1951 (right*)	2.79
11 FRONT DOOR LOW. HINGE 0M-7022810—1949 (right*)	2.59
0M-7222810—1950 (right*)	2.59
0M-7222810-B—1951 (right*)	2.59
12 FRONT DOOR ASSY. (Prime, less trim & hdw.) 8M-7320122-C—1949 (right*)	77.50
0M-7420122-A—1950 (right*)	77.50
0M-7420122-A—1951 (right*)	77.50
13 CENTER PILLAR ASSY. 8M-7324300—1949	11.72
0M-7424300—1950-51	11.57
14 REAR DOOR ASSY. (Prime, less trim & hdw.) 8M-7424622-D—1949 (right*)	67.25
0M-742622-B—1950 (right*)	67.25
0M-7424622-B—1951 (right*)	67.25
15 REAR DOOR UP. HINGE 8M-7326800—1949 (right*)	2.21
0M-7426800—1950-51 (right*)	2.33
16 REAR DOOR LOW. HINGE 8M-7326810—1949 (right*)	2.40
0M-7426810—1950-51 (right*)	2.54
17 QUARTER PANEL COMPLETE 8M-7427700—1949 (right*)	53.60

0M-7427700-C—1950 (right*)	53.60
1M-7427700-A—1951 (right*)	66.24
18 LOWER BACK PANEL ASSY. 8M-7240820—1949-50 (right*)	6.71
1M-7240820—1951 (right*)	6.71
19 FUEL TANK FILLER LID 8M-7028611—1949-50	2.67
1M-7228611-B—1951	1.29
20 LUGGAGE COMPT. DOOR 0M-7240112-A—1949	45.10
0M-7240112-A—1950	45.10
1M-7240112-B—1951	38.05
21 REAR FLOOR PAN ASSY. 8M-7011215-A—1949-50	33.45
1M-7211216-A—1951	68.72
22 FRONT FLOOR PAN & REINFMT. 8M-7011135—1949 to 51	22.50
23 FLOOR TRANS. COVER PLATE 8M-7012115-A—1949, tunnel width 10½"	6.57
8M-7012115-B—1949 and 1950 tunnel with 15"	5.67
1M-7212115-A—1951, std. trans.	7.78
1M-7212115-B—1951, merc-o- matic	7.81
24 FLOOR SIDE MEMBER 7A-7010110—1949 to 1951 (right*)	7.76
25 ROCKER PANEL ASSY. 8M-7310128-A—1949 to 1951 (right*)	18.10

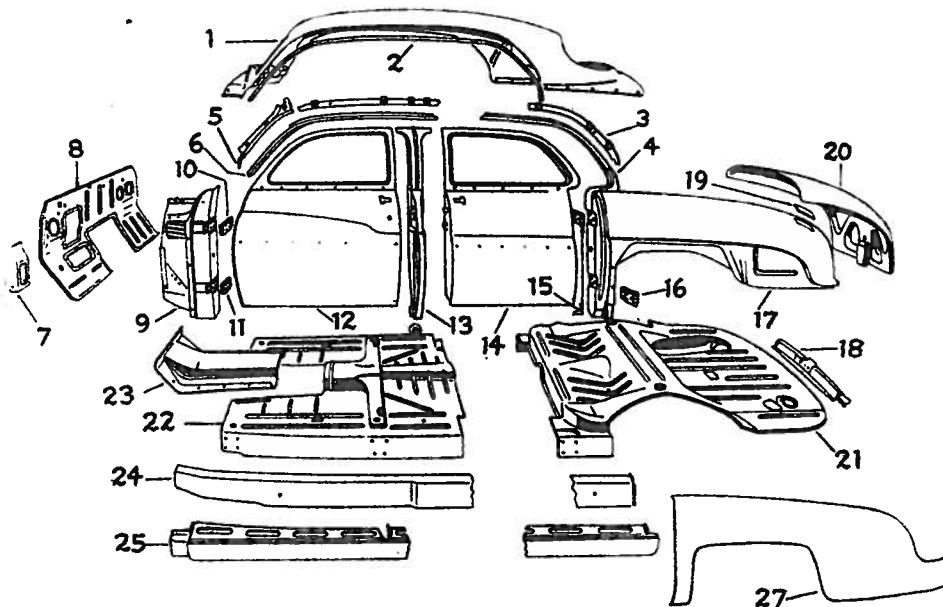
**Fig. 12—Sheet Metal—4 door models**

* Opposite side one part number higher

BODY PARTS 1949 thru 1951 MERCURY

Models 9M, 0M and 1M. ALL BODY STYLES

27 REAR FENDER		
8M-16312-B—1949-50 (right*)	17.00	
1M-16312-B—1951 (right*)	19.00	

FUEL TANK ASSY.

8M-9002-A—1949 to 1951, wedge shaped	24.95	
Fits station wagon only.		

Moldings, Wheels & Glass

Body Type—74—4 Door Sedan

See Fig. 13

1 PARKING LAMP ASSY.		
7RA-13200—1949, one wire...	5.20	
8M-13200-A—1949, two wire..	6.90	
0M-13200-A—1950 (right*)	6.90	
1M-13200-A—1951 (right*)	8.60	
2 SEALED BEAM UNIT (Bulb)		
09A-13007—1949 to 1951.....	1.43	
3 HEADLAMP RIM		
0A-13045-B—1949-50	2.15	
1A-13045-B—1951	2.59	
4 HOOD TOP ORNAMENT		
8M-16850—1949 to 1951.....	8.00	
5 WDSHD. OUTER CENTER WTHSTP. RETAINER		
8L-7003078—1949	1.88	
8L-7003078—1950-51	1.88	
6 WDSHD. OUTER FINISH MLDG.		
8L-7003088—1949 (right*)	4.19	
8L-7003088—1950-51 (right*)	4.19	
7 WDSHD. GLASS		
8M-7003100—1949 to 1951	15.31	
8 FRONT DOOR VENT. FRAME & GLASS		
8M-7021406-A—1949 (right*)	10.45	
8M-7021406-B—1950-51 (right*)	10.71	

9 FRONT DOOR VENT. GLASS		
8M-7021412-A—1949	2.71	
8M-7021412-B—1950-51	2.71	
10 FRONT DOOR W/W REVEAL MLDG. & WTHSTP.		
8M-7320984-B—1949 (right*)	4.02	
0M-7420984—1950-51 (right*)	4.14	
11 FRONT DOOR GLASS		
8M-7321410-A—1949 to 1951...	5.76	
12 ROOF DRIP MLDG.		
8M-7451700—1949 to 1951 (right*)	1.45	
13 REAR DOOR GLASS		
8M-7425712-A—1949 to 1951	5.33	
14 REAR DOOR REVEAL MLDG. & WTHSTP.		
8M-7425588—1949 (right*)	3.84	
0M-7425588—1950-51 (right*)	4.02	
15 REAR DOOR VENT. GLASS & FRAME		
8M-7426868-B—1949 to 1951 (right*)	9.88	
16 REAR DOOR VENT. GLASS		
8M-7426870-A—1949 to 1951...	3.02	
17 BACK W/W OUTER END MLDG.		
8M-7242430—1949 (right*)	1.86	
8M-7242430-C—1950 (right*)	1.86	
1M-7242430—1951, upper	2.57	
18 BACK W/W DIV. MLDG.		
8M-7242420-A—1949 (right*)	1.16	
19 BACK W/W END GLASS		
8M-7242018—1949 (right*)	6.02	
20 BACK W/W CENTER GLASS		
8M-7242016—1949	21.32	
8M-7242006—1950, one piece	34.29	
1M-7242006-A—1951	28.70	

21 BACK W/W MLDG. JOINT COVER		
8M-7242432-A—1949	.09	
8M-7242432-A—1950	.09	
22 LUGGAGE COMPT. DOOR HANDLE		
8M-7043500-B—1949	18.00	
0M-7243508-B—1950	6.70	
1M-7243508-C—1951	13.02	
22 LUGGAGE COMPT. HANDLE MEDALLION		
0M-7242530—1950	1.21	
1M-7242530-B—1951	1.52	
22 LUGGAGE COMPT. LOCK ASSY.		
8H-7343200—1949 to 1951	3.34	
23 REAR LAMP ASSY.		
8M-13405-A—1949-50	9.90	
1M-13404-A—1951	10.10	
24 REAR FENDER MLDG.		
8M-16352-B—1949 to 1951	2.07	
25 QUARTER PANEL OUTER MLDG.		
8M-7429034-A—1949 (right*)	1.48	
8M-7429034-B—1950-51 (right*)	1.48	
26 REAR DOOR BELT MLDG.		
8M-7425554-A—1949 (right*)	1.28	
8M-7425554-B—1950-51 (right*)	1.28	
27 REAR DOOR LOW. MLDG.		
8M-7325556—1949 to 1951 (right*)	1.72	
28 OUTER DOOR HANDLE		
8M-7022400-C—1949	3.26	
0M-7222400—1950	2.50	
28 OUTER DOOR HANDLE		
0M-7222400-A—1950-51, early	250	
0L-7222400-B—1951, late	3.78	
29 DOOR LOCK CYL. & SLEEVE ASSY.		
8H-7321984—1949 (right*)	2.21	
0M-7221984—1950 (right*)	1.66	
0M-7221984-B—1951 (right*)	1.66	
30 FRONT DOOR BELT MLDG.		
8M-7320934—1949 to 1951 (right*)	1.45	
31 FRONT DOOR LOW. MLDG.		
8M-7320938—1949 to 1951 (right*)	2.14	
32 FRONT FENDER MLDG.		
8M-16003—1949 (right*)	4.00	
0M-16003—1950 (right*)	3.97	
1M-16003-A—1951 (right*)	3.97	
33 WHEEL ASSY.		
0M-1015-AP—1949 to 1951	8.19	
34 WHEEL HUB CAP		
8M-1130—1949, stamped Mer- cury	3.00	
0M-1130-B—1950, not stamped	2.85	
1M-1137-A—1951	3.10	

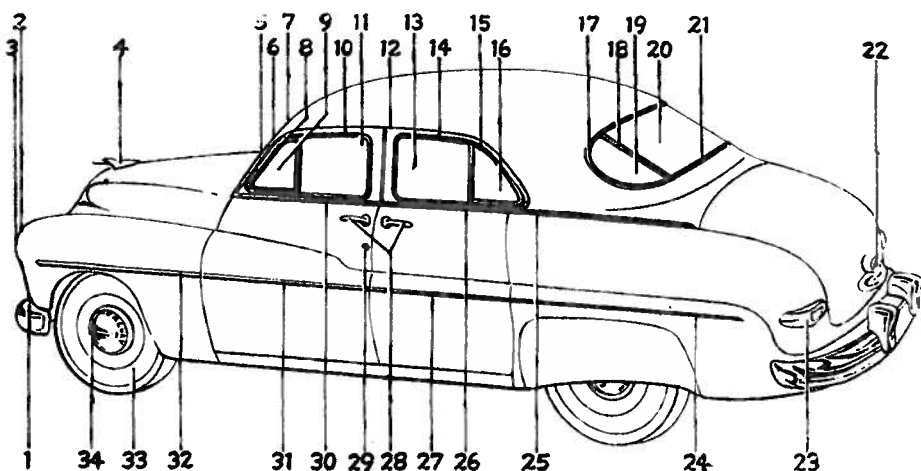
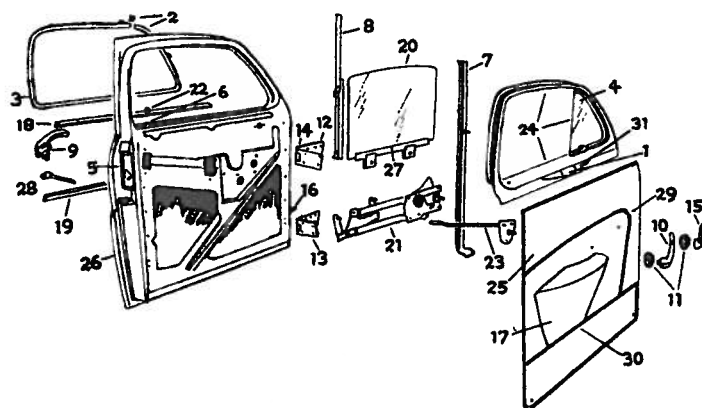

Fig. 13—Moldings, Wheels & Glass—4 door

* Opposite side one part number higher

MERCURY 1949 thru 1951 BODY PARTS**Models 9M, 0M and 1M. ALL BODY STYLES****Front Door***Body Type—74—4 Door Sedan**See Fig. 14*

1 WINDOW GARNISH MLDG. INSERT 8M-7020988-A—194990
1 WINDOW GARNISH MLDG. ORNAMENT 0M-7220988—1950	1.00
2 DOOR W/W REVEAL MLDG. & WTHSTP. 8M-7320984-B—1949 (right*) ..	4.02
0M-7420984—1950-51	4.14
3 SEE ITEM #2	
4 DOOR VENT. GLASS 8M-7021412-A—1949	2.71
8M-7021412-B—1950-51	2.71
5 DOOR LOCK ASSY. 8M-7021812—1949	5.29
0A-7021812—1950-51	3.36
6 DOOR LOCK CATCH ROD 8M-7021852-A—1949 (right*) ..	.09
0M-7221852-A—1950 (right*) ..	.05
7 DOOR W/W DIV. BAR & BRKT. 8M-7022296-B—1949 (right*) ..	4.59
0M-7022204—1950 (right*) ...	3.85
0M-7222204—1951 (right*) ...	3.85
8 DOOR GLASS RUN 7A-7021550—1949 to 195185
9 OUTER DOOR HANDLE 8M-7022400-C—1949	3.26
0M-7222400-A—1950	2.50
0M-7222400-A—1951	2.50
10 INNER DOOR HANDLE 8M-7022614-A—1949	1.26
8M-7022614-B—1950	1.19
1M-7222600—1951	1.66
11 DOOR HANDLE ESCUTCHEON 0M-7022618—1949-50, inner ..	.40
12 DOOR UP. HINGE 0M-7222800-A—1949 (right*) ..	2.79
0M-7222800-A—1950 (right*) ..	2.79
0M-7222800-B—1951 (right*) ..	2.79
13 DOOR LOWER HINGE 8M-7022810—1949 (right*) ...	2.59
0M-7222810—1950 (right*) ...	2.59
0M-7222810—1951 (right*) ...	2.59
14 DOOR HINGE PIN 8M-7022840-B—194907
0M-7222840—1950-5104
15 DOOR REGLTR. HANDLE 8M-7023342-A—1949	2.15
8M-7023342-B—1950	2.15
1M-7223342—1951	1.59
16 DOOR CHECK ARM 8M-7023500—1949 to 195145

**Fig. 14—Front Door—Body Type—74—4 door**

17 DOOR ARM REST 8M-7024140-C—1949, blue stripe (right*)	17.28
0M-7224140-AB—1950, blue (right*)	8.60
1M-7224140-AB—1951, blue (right*)	5.53
Note: Other color arm rests are available.	
18 DOOR BELT MLDG. 8M-7320934—1949 to 1951 (right*)	1.45
19 DOOR LOWER OUT. MLDG. 8M-7320938—1949 to 1951 (right*)	2.14
20 DOOR W/W GLASS 8M-7321410-A—1949 to 1951 ..	5.76
21 DOOR WINDOW REGLTR. 8M-7323200-A—1949 (right*) ..	5.72
8M-7323200-C—1950 (right*) ..	5.84
8M-7023200-B—1950, hydra. (right*)	20.14
1M-7423200—1951 (right*) ...	5.83
22 DOOR LOCKING CONTROL ROD KNOB 8A-7021850—194928
8A-7021850-B—1950 to 195128
23 DOOR W/W REMOTE CONTROL 8M-7321818—1949 (right*) ...	2.57
0M-7421818—1950 (right*)86
1M-7421818—1951 (right*)97
24 DOOR VENT. W/W & FINISH STRIP 8M-7321402-C—1949, blue (right*)	27.79
8M-7021402-G—1950 (right*) ..	19.00
0M-7221402—1951 (right*) ...	25.75
25 DOOR TRIM ASSY. 8M-7323942-C—1949, blue (right*)	20.72
0M-7423942-AB—1950, blue (right*)	23.10
1M-7423942-AB—1951, dark blue (right*)	23.1
Note: Other colors of trim are available.	
26 DOOR ASSY. (Prime, less trim & hdw.) 8M-7320122-C—1949 (right*) ..	77.5
0M-7420122-A—1950 (right*) ..	77.5
0M-7420122-B—1951 (right*) ..	77.6
27 DOOR GLASS CHAN. & BRKT. ASSY. 8M-7321458—1949 (right*)9
8M-7321458-A—1950 to 1951 (right*)9
8M-7321458-B—1950 to 1951, hydra. (right*)	1.0
28 DOOR LOCK CYL. & SLEEVE 8H-7321984—1949 (right*) ...	2.2
0M-7221984-A—1950 (right*) ..	1.6
0M-7221984-B—1951 (right*) ..	1.6
29 DOOR TRIM MLDG. 8M-7320942-A—1949 (right*) ..	1.2
0M-7420942-A—1950 (right*) ..	1.1
1M-7420942—1951 (right*) ...	1.1
30 DOOR TRIM LOWER MLDG. 8M-7320956-A—1949	1.0
0M-7420956-A—1950	1.1
31 DOOR TRIM MLDG. RETAINER Service with No. 29 as shown above.	

Rear Door*Body Type—74—4 Door Sedan**See Fig. 15*

1 DOOR LOWER OUTER MLDG. 8M-7325556—1949 to 1951 (right*)	1.5
2 DOOR LOWER TRIM MLDG. 8M-7325578-A—19495
0M-7425578-A—19505
1M-7425578—19515

* Opposite side one part number higher

BODY PARTS 1949 thru 1951 MERCURY

Models 9M, 0M and 1M. ALL BODY STYLES

3 DOOR TRIM MLDG. ASSY.	
8M-7325558-A—1949 (right*) ..	1.28
0M-7425558-A—195076
1M-7425558—195178
4 DOOR REMOTE CONTROL	
8M-7326404—1949 (right*) ...	2.29
0M-7426404—1950 (right*)86
1M-7426404—1951 (right*)86
5 DOOR UPPER HINGE	
8M-7326800—1949 (right*) ...	2.21
0M-7426800—1950 to 1951 (right*)	2.33
6 DOOR LOWER HINGE	
8M-7326810—1949 (right*) ...	2.40
0M-7426810—1950 to 1951 (right*)	2.54
7 DOOR CHECK ARM	
8M-7327200-B—194940
8M-7327200-B—1950 to 1951 ..	.40
8 DOOR TRIM ASSY.	
8M-7327406-C—1949, blue (right*)	17.00
0M-7427406-AB—1950, dark blue (right*)	18.34
1M-7427406-AB—1951, dark blue (right*)	18.36
Note: Other color trim available.	
9 DOOR TRIM MLDG. ASSY.	
8M-7325558-A—1949 (right*) ..	1.28
0M-7425558-A—195076
1M-7425558—195178
10 SEE ITEM NO. 9	
11 WINDOW DIV. BAR & BRKT. OR RETAINER	
8M-7222296-B—1949 (right*) ..	4.12
0M-7222204—1950 (right*) ...	3.85
0M-7222204—1951 (right*) ...	3.85
12 DOOR GLASS RUN ASSY.	
7A-7021550—1949 to 195185
13 DOOR ASSY. (Prime, less trim, glass, hdw.)	
8M-7424622-D—1949 (right*) ..	67.25
0M-7424622-B—1950 (right*) ..	67.25
0M-7424622-B—1951 (right*) ..	67.25
14 DOOR BELT MLDG.	
8M-7425554-A—1949 (right*) ..	1.28
8M-7425554-B—1950 to 1951 (right*)	1.28
15 DOOR WINDOW GLASS	
8M-7425712-A—1949 to 1951..	5.33
16 DOOR GLASS CHAN. & BRKT.	
7A-7426228—1949 (right*)86
7A-7426228-A—1950 to 1951 (right*)86
8M-7426228-B—1950 to 1951, hydra. (right*)81
17 DOOR WINDOW ASSY. (Complete)	
8M-7426866-AP—1949, blue (right*)	28.36

0M-7426866—1950 to 1951 (right*)	16.33
18 VENT. GLASS	
8M-7426870-A—1949 to 1951 ..	3.02
19 VENT. FRAME & GLASS ASSY.	
7A-7426868—1949 (right*) ...	11.62
8M-7426868-B—1950 to 1951 (right*)	9.88
20 WINDOW REGLTR. ASSY.	
8M-7427000-A—1949 (right*) ..	5.57
8M-7427000-B—1950 (right*) ..	5.57
8M-7023200-B—1950 to 1951, hydra. (right*)	20.14
1M-7427000—1951 (right*) ...	5.22
21 WINDOW REVEAL MLDG. CLIP	
7A-7020925—194904
8M-7020925—1950 to 195104
22 DOOR OUTER HANDLE	
8M-7022400-C—1949	3.26
0M-7622400-A—1950	2.50
0M-7222400-B—1951	2.50
23 LOCK CONTROL ROD KNOB	
8A-7021850—194928
8A-7021850-B—1950 to 1951..	.28
24 INNER DOOR HANDLE ESCUTCHEON	
0M-7222618—1949 to 195040
25 INNER DOOR HANDLE	
8M-7022614-A—1949	1.26
8M-7022614-B—1950	1.19
1M-7222600—1951	1.66
26 WINDOW REGLTR. HANDLE	
8M-7023342-A—1949	2.15
8M-7023342-B—1950	2.15
1M-7223342—1951	1.59

27 DOOR GARNISH MLDG. IN- SERT OR ORNAMENT	
8M-7020988-A—1949, insert...	.90
0M-7220988-B—1950, ornament	1.00
28 GARNISH MLDG. INSERT RETAINER	
8M-7020946-A—1949	1.62

Ventilation System

All Models

Not Illustrated

VENT. AIR DUCT ASSY.	
8M-8702-B—1949 (right*)	2.31
VENT. SCREEN	
8M-8716—194912
0M-7201900—1950 to 195112
VENT. AIR DUCT SEAL	
8M-8721—194913
8M-7001928—1950 to 1951, rear	.29
AIR CONDUCTOR VALVE ASSY.	
8M-7301850—1949 (right*) ...	6.12
8M-7201850-A—1950 to 1951, w/heater (right*)	3.88
0M-7201850-B—1950 to 1951, w/o heater (right*)	4.57
AIR VALVE TO DASH GASKET	
8M-18570-A—1949 to 195110
AIR INLET REGISTER	
8M-7301814—1949 to 1951 (right*)	2.59
AIR INLET CABLE ASSY.	
8M-7301890-D—1949 (right*) ..	2.76
0M-7201890-C—1950 to 1951 (right*)88

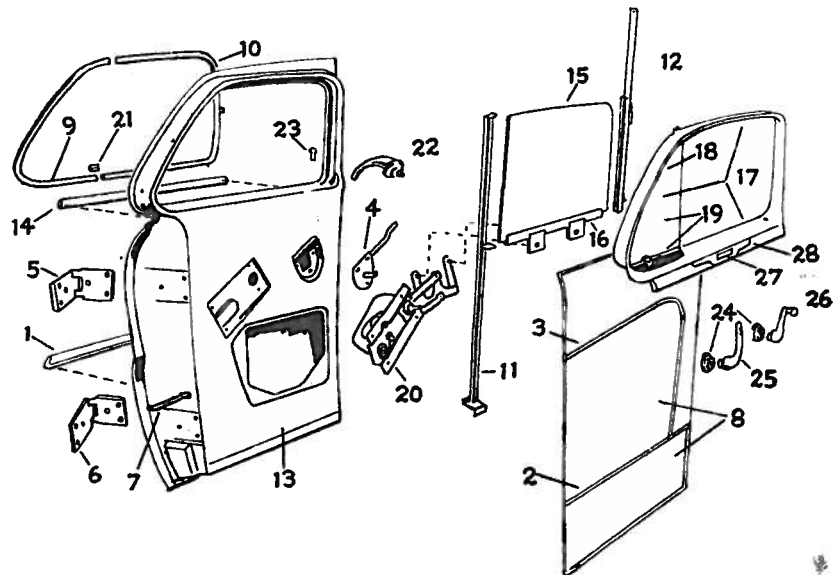

Fig. 15—Rear Door—Body Type 74—4 door

* Opposite side one part number higher

MERCURY 1949 thru 1951 BODY PARTS**Models 9M, 0M and 1M. ALL BODY STYLES**

Fig. 16

Sheet Metal*Body Type—76—Convertible**See Fig. 16***1 DASH PANEL ASSY.**

8M-7601610-B—1949	13.82
0M-7601614—1950	15.90
1M-7601614—1951	15.90

2 BODY FRONT ASSY.

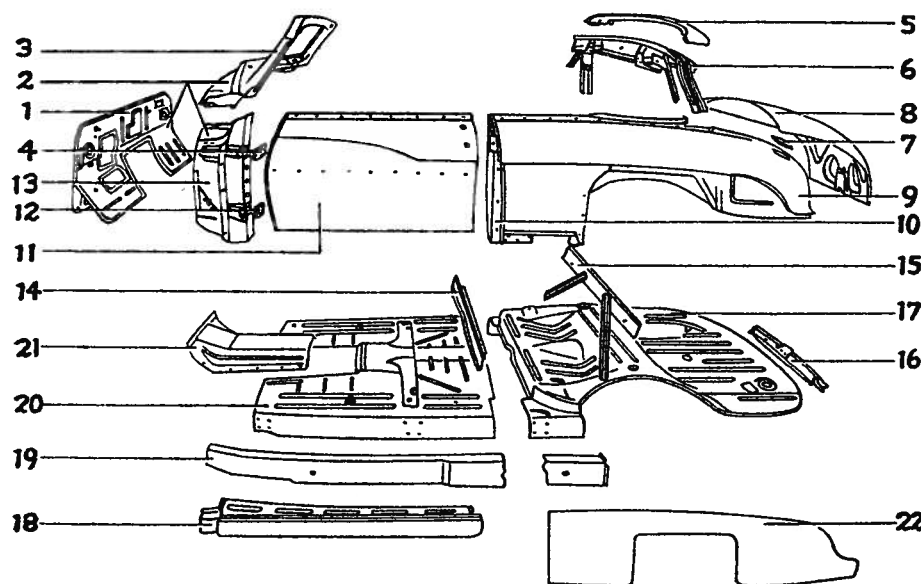
8M-7600120-B—1949	161.05
0M-7600120—1950	161.05
1M-7600120—1951	161.05

3 COWL TOP PANEL ASSY.

7A-7602010—1949	21.94
0M-7602010—1950 to 1951	23.15

4 DOOR UPPER HINGE

8M-7022800—1949	2.79
0M-7222800-A—1950	2.79
0M-7222800-B—1951	2.79

5 UPPER BACK PANEL ASSY.

0M-7640314—1949	8.85
0M-7640310—1950	8.85
1M-7640310—1951	9.25

6 BELT FLANGE STRIP REINFMT.

0M-7641716—1949 to 1951	27.88
-------------------------	-------

7 FUEL TANK FILLER LID

8M-7028611—1949 to 1950	2.65
1M-7228611-B—1951	1.29

8 LUGGAGE COMPT. DOOR

0M-7240112-A—1949	45.10
0M-7240112-B—1950	38.36
1M-7240112-B—1951	38.05

9 QUARTER PANEL ASSY.

8M-7627840—1949 to 1950	39.88
1M-7627840-C—1951	60.41

10 QUARTER LOCK PILLAR ASSY.

7A-7628160—1949 (right*)	32.88
0M-7628160-A—1950 (right*)	32.93
0M-7628160-B—1951 (right*)	32.93

11 DOOR ASSY. (Prime, less trim & hdw.)

8M-7620122—1949 (right*)	77.50
0M-7620122—1950 (right*)	77.50
1M-7620122—1951 (right*)	77.50

12 DOOR LOWER HINGE

0M-7022810-B—1949 (right*)	2.59
0M-7222810-B—1950 (right*)	2.59
0M-7222810-B—1951 (right*)	2.59

13 COWL SIDE PILLAR & PANEL ASSY.

8M-7602042—1949	35.57
0M-7602042-A—1950	35.90
0M-7602042-B—1951	35.90

14 REAR SEAT FRONT RISER

8M-7660648-B—1949 to 1951	4.97
---------------------------	------

15 REAR SEAT BACK FRAME SUPT.

8M-7662332-B—1949 to 1951	4.53
---------------------------	------

16 LOWER BACK PANEL ASSY.

8M-7240320—1949 to 1950	6.71
1M-7240320—1951	6.71

17 REAR FLOOR PAN ASSY.

8M-7611216-B—1949	58.34
8M-7611216-C—1950	60.81
1M-7611216—1951	51.26

18 ROCKER PANEL ASSY.

8M-7610128—1949 to 1951 (right*)	12.21
----------------------------------	-------

19 FLOOR SIDE MEMBER

7A-7610110—1949 to 1951 (right*)	10.0
----------------------------------	------

20 FRONT FLOOR PAN & REINFMT.

8M-7611135—1949 to 1951	29.5
-------------------------	------

21 TRANS. COVER PLATE ASSY.

8M-7012115-A—1949, 10½ in. tunnel front	6.1
8M-7012115-B—1949, 15 in. tunnel front	5.1
8M-7012115-A—1950	6.1
1M-7212115-A—1951, std. trans.	7.1
1M-7212115-B—1951, Merc-o-matic	7.1

22 REAR FENDER ASSY.

8M-16312-A—1949 to 1950 (right*)	16.1
1M-16312-C—1951 (right*)	12.0

Door Assembly*Body Type—76—Convertible**See Fig. 17***1 DOOR WINDOW REGLTR.**

8M-7623200—1949 to 1951, hydra. (right*)	19.1
--	------

2 COMPLETE VENT. W/W & FINISH STRIP

8M-7621402-A—1949 (right*)	48.1
8M-7621402-E—1950 (right*)	51.1
0M-7621402—1951 (right*)	53.1

3 REGLTR. SW. & HOUSING

8H-7223302-A—1949, single sw.	2.1
8H-7223303—1949, four sw.	9.1
0H-7223302—1950 to 1951, single sw.	2.1
0H-7223303—1950 to 1951, four sw.	9.1

4 DOOR TRIM LOWER MLDG.

8M-7020956-A—1949	1.1
0M-7020956-A—1950	3.1
1M-7220942—1951, panel (right*)	2.1

5 DOOR LOCK ASSY.

8M-7021812—1949 (right*)	5.1
0A-7021812—1950 to 1951 (right*)	3.1

6 OUTER DOOR HANDLE

8M-7022400-C—1949 (right*)	3.1
0M-7622400-A—1950 (right*)	3.1
0M-7622400-B—1951 (right*)	3.1

7 INNER DOOR HANDLE

8M-7022614-A—1949	1.1
8M-7022614-B—1950	1.1
1M-7222600—1951	1.1

8 INNER DOOR HANDLE ESCUTCHEON

0M-7222618—1949 to 1950	1.1
-------------------------	-----

* Opposite side one part number higher

BODY PARTS 1949 thru 1951 MERCURY

Models 9M, 0M and 1M. ALL BODY STYLES

9 DOOR UPPER HINGE					
0M-7222800-A—1949 (right*)	2.79				
0M-7222800-A—1950 (right*)	2.79				
0M-7222800-B—1951 (right*)	2.79				
10 DOOR LOWER HINGE					
0M-7022810-B—1949 (right*)	2.59				
0M-7222810-B—1950 (right*)	2.59				
0M-7222810-B—1951 (right*)	2.59				
11 DOOR ARM CHECK					
8M-7023500—1949 to 195145				
12 DOOR ASSY. (Prime, less trim & hdw.)					
8M-7620122—1949 (right*)	77.50				
0M-7620122-B—1950 (right*)	86.86				
1M-7620122—1951 (right*)	77.50				
13 DOOR GLASS LOCK SIDE RUN (Complete)					
7A-7621508—1949 to 1950 (right*)	2.52				
1M-7621508—1951 (right*)	3.14				
14 LOCK SAFETY CATCH ROD					
8M-7621852-A—1949 (right*)	.17				
0M-7621852-A—1950 to 1951 (right*)	.05				
15 DOOR ARM REST ASSY.					
8M-7624140-C—1949, green (right*)	24.05				
0M-7624140-AF—1950, black (right*)	16.00				
1M-7624140-AJ—1951, ivory (right*)	24.05				
Note: Other color rests are available.					
16 DOOR TRIM ASSY.					
8M-7623942-C—1949, green (right*)	28.78				
0M-7623942-AF—1950, black & red (right*)	25.24				
1M-7623942-AG—1951, black & red (right*)	25.03				
Note: Other color trims are available.					
17 DOOR LOW. OUTER MLDG.					
8M-7020938—1949 to 1951 (right*)	2.48				
18 DOOR TRIM MLDG. ASSY.					
8M-7020942-A—1949 (right*)	1.67				
0M-7220942-A—1950 (right*)	1.48				
1M-7220942—1951 (right*)	2.40				
19 DOOR GLASS CHAN. & BRKT.					
8M-7621458-B—1949 to 1951	2.66				
20 DOOR VENT. FRAME & GLASS ASSY.					
8M-7621228—1949 (right*)	14.12				
8M-7621228-C—1950 to 1951 (right*)	14.19				
21 DOOR WINDOW GLASS					
8M-7621410-A—1949 to 1951	8.99				
22 DOOR VENT. GLASS					
8M-7621412-A—1949	3.23				
8M-7621412-B—1950 to 1951	3.23				
23 COMPLETE DOOR GLASS FRAME ASSY.					
8M-7622218-B—1949 to 1951 (right*)	34.02				
24 WINDOW REGLTR. TUBE					
8M-7653350—1949 to 1951 (right*)	.97				
25 DOOR LOCK REMOTE CONTROL					
8M-7021818—1949 (right*)	2.62				
0M-7221818—1950 (right*)	.97				
1M-7221818—1951 (right*)	1.09				
26 DOOR WINDOW REVEAL MLDG.					
8M-7620984—1949 (right*)	10.59				
8M-7620984-B—1950 to 1951 (right*)	10.79				
27 LOCK CONTROL ROD KNOB					
8A-7021850—1949	.28				
8A-7021850-B—1950 to 1951	.28				
28 W/W REGLTR. SW. MTG. PLATE					
8H-7224232—1949 to 1951, single sw.	.35				
8H-7224233—1949 to 1951, four sw.	.42				
29 REGLTR. TO SOLENOID WIRING ASSY.					
8H-14508—1949 to 1950, 29 in. long	.67				
0H-14508—1950 to 1951	.19				
30 W/W SW. TO BODY HARNESS					
8M-13708—1949 to 1951	5.76				
31 DOOR LOCK CYL. & SLEEVE ASSY.					
8H-7321984—1949	2.21				
0M-7621984-A—1950	2.16				
0M-7621984-B—1951	2.16				
32 WINDOW REGLTR. HYDRA. CYL.					
8L-7323244—1950 to 1951	9.36				
33 HYDRA. W/W OUTER SPRING					
8H-7353329—1950	.95				
1H-7253330—1951	.95				
34 HYDRA. W/W INNER SPRING					
8H-7353330—1950	.88				
35 REGLTR. ARM BRKT.					
51A-7123236—1949 to 1951	.12				
36 W/W LOWER FINISH STRIP					
8M-7620964—1949 (right*)	8.12				
0M-7620964-AP—1950 (right*)	7.78				
1M-7620964-AP—1951 (right*)	5.55				
37 GARNISH MLDG. INSERT RETAINER					
8M-7020946—1949	1.62				
38 INSERT OR ORNAMENT GARNISH MLDG.					
8M-7020988—1949, insert	.90				
0M-7220988—1950, ornament	1.00				

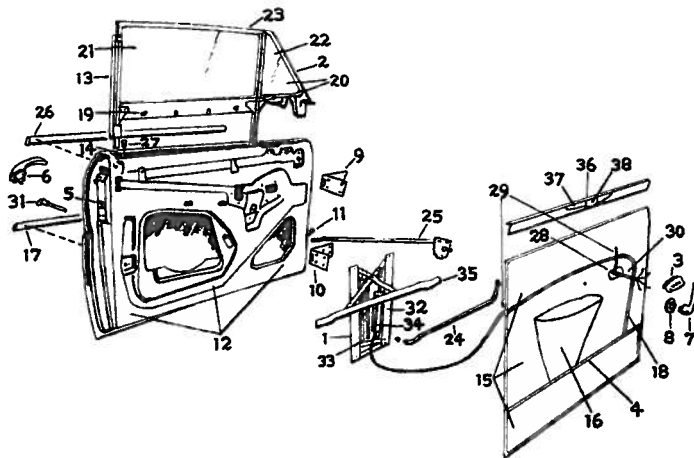

Fig. 17—Door Assembly—Convertible

* Opposite side one part number higher

Folding Top

Body Type—76—Convertible

See Fig. 18

1 NO. 1 BOW HEADER ASSY.			
8M-7651270—1949 to 1950	64.40		
1M-7651270—1951	60.62		
2 SIDE RAIL TO HEADER BRKT.			
8M-7650832—1949 to 1951 (right*)	6.26		
3 LOCK HANDLE SHAFT BUSHING			
8H-7658121—1949 to 1951	.45		
4 LOCKING HANDLE			
8H-7603570—1949 to 1951	2.61		
5 NO. 2 BOW & LINKS ASSY.			
8M-7651264—1949	25.50		
0M-7651264—1950 to 1951	22.69		

continued

MERCURY 1949 thru 1951 BODY PARTS**Models 9M, 0M and 1M. ALL BODY STYLES****Folding Top—continued**

6 NO. 2 BOW CONNECTING LINK BRKT. 8H-7650890—1949 to 1950 (right*)90
7 FRONT SIDE RAIL ASSY. 8M-7653006—1949 to 1951 (right*)	21.57
8 FRONT SIDE RAIL HINGE & LINK 8M-7653008—1950 to 1951 (right*)	10.95
9 SIDE RAIL REAR LINK 8M-7650308—1949 to 1951	3.15
10 SIDE RAIL FRONT LINK 8M-7650310—1949 to 1951	5.40
11 COMPLETE SIDE RAIL 8M-7651154-B—1949 to 1951 (right*)	27.52
12 REAR SIDE RAIL HINGE & LINK 8M-7653010—1949 to 1951 (right*)	9.88

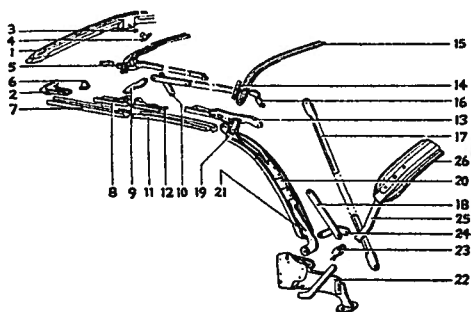

Fig. 18—Folding Top

13 REAR SIDE RAIL REAR HINGE 8M-7653170-B—1949 to 1951 (right*)	7.38
14 NO. 3 BOW TAPPING PLATE 8H-7651256—1949 to 195150
15 NO. 3 BOW ASSY. 8M-7651269-B—1949 to 1951 ..	3.17
16 NO. 1 TOP LINK 8M-7650432—1949 to 1951 (right*)	5.34
17 BALANCE LINK 8M-7650454-B—1949 to 1950...	8.05
18 UPPER POWER LINK 0M-7650368—1951, 49 & 1950..	2.59
19 UPPER QUARTER PILLAR BRKT. 8M-7650378-B—1950 (right*) ..	15.15

20 PILLAR RAIL ASSY. 8M-7653196—1949 to 1951 (right*)	34.33
21 TOP PILLAR HINGE 8M-7624324—1950 to 1951 (right*)	9.88
22 TOP MTG. BRKT. 8M-7653118-B—1949 to 1950 (right*)	10.50
8M-7653118-C—1951 (right*) ..	10.38
23 OPERATING CYL. YOKE 8A-7650774—1949 to 195170
24 LOWER POWER LINK 8M-7650418—1949 to 1951	3.64
25 REAR BOW SLAT IRON 8M-7650340—1949 to 1951 (right*)	5.10
26 REAR BOW ASSY. 8M-7651278-A—1949 to 1951 ..	34.59

Moldings, Wheels & Glass*Body Type—76—Convertible**See Fig. 19*

1 PARKING LAMP ASSY. 7RA-13200—1949, one wire ...	6.90
8M-13200-A—1949, two wire...	6.90
0M-13200-A—1950	6.90
1M-13200—1951	8.60
2 HEADLAMP RIM 0A-13045-B—1949 to 1950	2.15
1A-13045-B—1951	2.59
HEADLAMP ASSY. 8M-13002—1949 to 1950, early cars	7.33
0M-13002—1949 to 1950, late cars	7.33
1M-13002—1951	7.33
3 SEALED BEAM UNIT OR BULB 09A-13007—1949 to 1951	1.43
4 HOOD TOP ORNAMENT 8M-16850—1949 to 1951	10
5 WDSHD. CENTER WTHSTP. RETAINER 8L-7003078—1949	1
8L-7003078—1950	1
8M-7603078—1951	1
6 WDSHD. GLASS 8M-7003100—1949 to 1951 ...	15
7 WDSHD. OUTER FINISH MLDG. 8L-7003088—1949 (right*) ...	4
8L-7003088—1950 (right*) ...	4
8 VENT. GLASS & RETAINER 8M-7621228-A—1949 (right*) ..	14
8M-7621228-C—1950 to 1951 (right*)	14
9 VENT. GLASS 8M-7621412-A—1949	3
8M-7621412-B—1950 to 1951 ..	3
10 COMPLETE DOOR GLASS FRAME 8M-7622219-B—1949 to 1951 ..	34
11 DOOR WINDOW GLASS 8M-7621410-A—1949 to 1951..	8
12 QUARTER WINDOW FRAME & GLASS ASSY. 8M-7629700—1949 (right*) ..	50
0M-7629700—1950 to 1951 (right*)	57
13 QUARTER WINDOW GLASS 8M-7629710-A—1949 to 1951..	7
14 REAR QUARTER BELT MLDG. 8M-7629034—1949 to 1950 (right*)	1
1M-7629034—1951 (right*) ...	1
15 REAR LAMP ASSY. 8M-13404-A—1949 to 1950 ...	9
1M-13404—1951	10

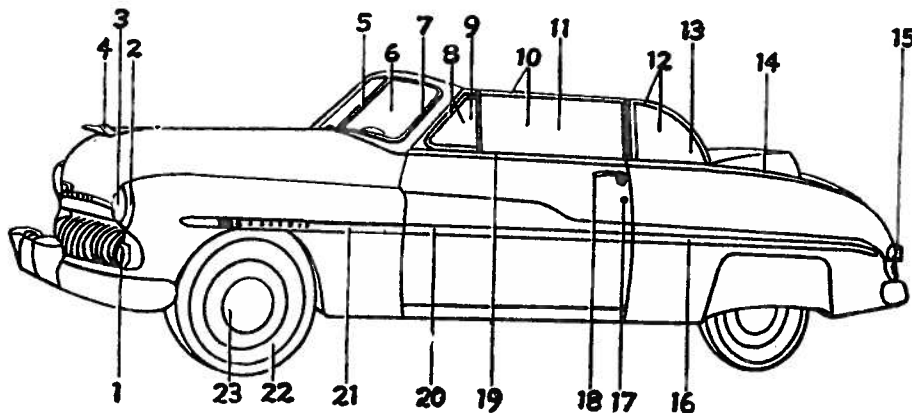

Fig. 19—Moldings, Wheels & Glass—convertible

* Opposite side one part number higher

BODY PARTS 1949 thru 1951 MERCURY

Models 9M, 0M and 1M. ALL BODY STYLES

16 REAR FENDER MLDG. 8M-16382-A—1949 to 1951 (right*)	2.60
17 DOOR LOCK CYL. & SLEEVE 8H-7321984—1949 (right*) ... 0M-7621984-A—1950 (right*) ... 0M-7621984-B—1951 (right*) ...	2.21 2.16 2.16
18 OUTER DOOR HANDLE 8M-7622400-B—1949 (right*) . 0M-7622400-A—1950 (right*) . 0M-7622400-B—1951 (right*) .	3.26 3.67 3.67
19 DOOR WINDOW REVEAL MLDG. & WTHSTP. 8M-7620984-A—1949 (right*) . 8M-7620984-B—1950 to 1951 (right*)	10.59 10.79
20 LOWER OUTER DOOR MLDG. 8M-7620938—1949 to 1951 (right*)	2.48
21 FRONT FENDER MLDG. 8M-16003—1949 (right*) 0M-16003—1950 (right*) 1M-16003-A—1951 (right*) ...	4.00 3.97 3.97
22 WHEEL ASSY. 0M-1015-AP—1949 to 1951 ...	8.19
23 WHEEL HUB CAP 8M-1130-A—1949 0M-1130-B—1950 1M-1137-A—1951	3.00 2.85 3.10

Quarter Window

Body Type—76—Convertible

See Fig. 20

COMPLETE FRAME & GLASS ASSY. 8M-7629700—1949 (right*) .. 0M-7629700-AP—1950 (right*) 0M-7629700-BP—1951 (right*)	50.22 57.47 57.47
--	-------------------------

1 WINDOW FRONT WTHSTP. RETAINER 7A-7629952—1949 to 195131
2 COMPLETE W/W FRONT WTHSTP. 8M-7630106—1949 to 1951 (right*)	3.10

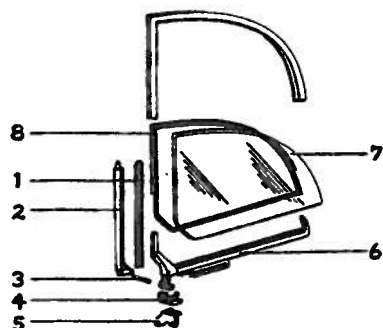

Fig. 20

3 W/W FRAME HINGE PIN 7A-7630556—1949 to 195117
4 WINDOW HINGE 7A-7629948—1949 to 1951	3.07
5 WINDOW BRKT. 7A-7629932—1949 (right*) ... 0M-7629932—1950 to 1951	1.81 1.88
6 W/W FRONT LOW. COR. CHAN. 7A-7629958—1949 to 1951 (right*)	5.67
7 GLASS ASSY. 8M-7629710-A—1949 to 1951 .	7.28
8 GLASS RETAINING STRIP 7A-7629724-A—1949 to 1951 .	3.47

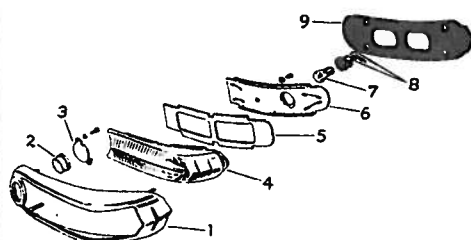

Fig. 21

Rear Lamp

Except Station Wagon

See Fig. 21

REAR LAMP ASSY. 8M-13404-A—1949 to 1950 ... 1M-13404—1951	9.45 10.10
1 LAMP DOOR 8M-13448—1949 to 1950 (right*) 1M-13448—1951 (right*)	4.75 4.75
2 LAMP REFLECTOR 8M-13437—1949 to 1950 1M-13437—195129 .27
3 LAMP REFLECTOR RETAINER 8M-13456—1949 to 1950 1M-13456—195117 .17
4 REAR LAMP LENS 8M-13450-A—1949 to 1950 1M-13450—1951	1.19 1.10
5 LAMP LENS GASKET 8M-13461—1949 to 1950 1M-13461—195120 .22
6 SERVICED WITH COMPLETE LAMP ONLY	
7 REAR LAMP BULB 11A-13465—1949 to 195136
8 LAMP WIRING & SOCKET 8M-13410-A—1949 to 195198
9 LAMP MTG. PAD 8M-13420—1949 to 1950 1M-13420—195145 .35

Rear Lamp

Station Wagon

See Fig. 22

1 REAR LAMP DOOR OR RIM 40-13448—1949 to 195162
2 REAR LAMP RIM SCREW 30170-S13—1949 to 195105
3 NOT LISTED	
4 REAR LAMP LENS 40-13450-A—1949 to 195143
5 LAMP DOOR GASKET 40-13460—1949 to 195114
6 REAR LAMP BULB 11A-13465—1949 to 1951, off- set base36
7 WHITE LENS GASKET 40-13447—1949 to 195106
8 WHITE GLASS LENS 40-13445—1949 to 195121
9 WHITE LENS RETAINER B-13446—1949 to 195103
10 LAMP DOOR SCREW 29546-S13—1949 to 195105
11 REAR LAMP BODY 8A-13408—1949 to 1951	2.88
12 LAMP WIRING & SOCKET 8A-13410-B—1949 to 1951	1.38
13 LAMP MLDG. 8A-13476—1949 to 195178
14 LAMP SHELL ASSY. 8A-13454—1949 to 1951	1.42
15 LAMP HINGE ASSY. 8M-13424—1949 to 1950, wood tailgate (right*) 0A-13424—1950 to 1951, steel tailgate (right*)	2.90 2.79
16 LAMP HINGE BRKT. GASKET 7A-13446—1949 to 195102

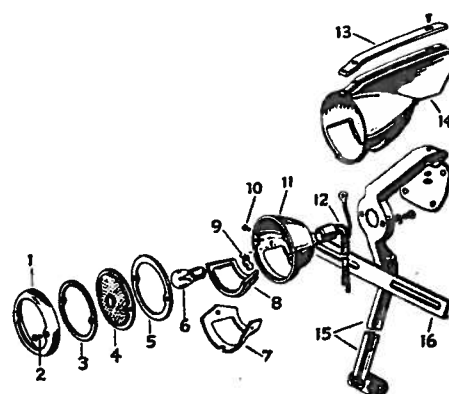
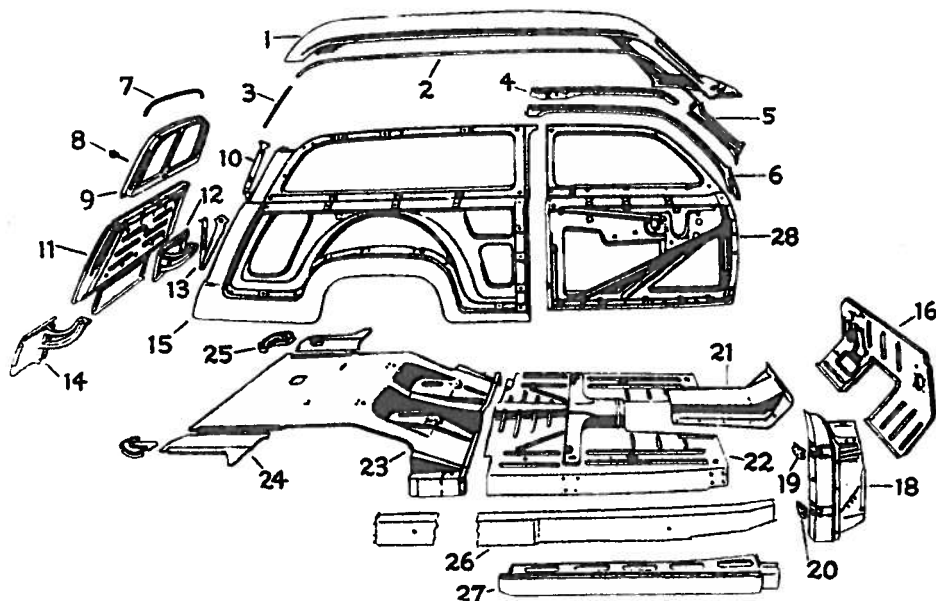

Fig. 22

* Opposite side one part number higher

MERCURY 1949 thru 1951 BODY PARTS**Models 9M, 0M and 1M. ALL BODY STYLES****Sheet Metal***Body Type: 79—Station Wagon**See Fig. 23*

1 ROOF PANEL ASSY.	
8M-7950026—1949	131.29
0M-7950026—1950 to 1951	147.43
2 ROOF SIDE FRONT DRIP MLDG.	
7A-7951710—1949 to 1951 (right*)	1.84
3 ROOF SIDE REAR DRIP MLDG.	
7A-7951714—1949 to 1951 (right*)21
4 ROOF SIDE RAIL REINFMT.	
8M-7951190—1949 to 1951 (right*)	2.13
5 WDSHD. OPENING REINFMT. EXTEN.	
8M-7008818—1949 to 1951 (right*)	2.60
6 ROOF FRONT SIDE RAIL	
7A-7951184—1949 to 1951 (right*)	5.09
7 REAR ROOF DRIP MLDG.	
7A-7951704—1949 to 1951	2.02
8 BACK W/W HANDLE (Less lock & cyl.)	
8A-7943429—1949	2.25
8A-7943429-B—1950 to 1951 ..	3.17
9 BACK WINDOW ASSY. (Less trim)	
8M-7942002-C—1949 to 1951 ..	27.24
10 BACK WINDOW SUPT.	
7A-7942058—1949 to 1950	4.03
0A-7942058-A—1951	4.03
11 COMPLETE TAILGATE ASSY.	
0M-7940200—1949-50	175.80
0M-7940200—1951	210.05
12 LOWER REAR SIDE PANEL	
8M-7940320—1949 (right*) ...	7.04
8M-7940320-B—1950 (right*) ..	7.04
0M-7940320—1951 (right*) ...	7.85
13 TAILGATE SUPT. ROD	
8M-7944400—1949 (right*) ...	10.25
8M-7944400-B—1950 (right*) ..	10.25
0A-7944400—1951 (right*) ...	10.25
14 SEE ITEM NO. 12	
15 DASH PANEL & BRACE ASSY.	
8M-7001614-B—1949	14.12
0M-7201614—1950	15.43
1M-7201614—1951	11.69
16 QUARTER PANEL ASSY.	
8M-7927840—1949 (right*) ...	110.46
0M-7927840—1950 (right*) ...	110.46
0A-7927840—1951 (right*) ...	83.24
17 DASH TO FRAME BRACE	
8M-7001726—1949	1.54
8M-7001714—1950 to 1951	2.66

**Fig. 23—Sheet Metal—Station Wagon**

18 COWL SIDE PILLAR & PANEL	
8M-7902042—1949 (right*) ...	21.36
0M-7902042—1950 (right*) ...	26.39
0M-7902042-B—1951 (right*) ..	26.39
19 DOOR HINGE UPPER	
8M-7922800—1949 (right*) ...	3.22
0M-7922800-A—1950 (right*) ..	2.90
0M-7922800-B—1951 (right*) ..	2.09
20 DOOR HINGE LOWER	
8M-7022810—1949 (right*) ..	2.59
0M-7222810—1950 (right*) ..	2.59
0M-7222810—1951 (right*) ...	2.59
21 FLOOR TRANS. COVER PLATE	
8M-7012115-A—1949, 10½ in. tunnel	6.57
8M-7012115-B—1949, 15 in. tunnel	5.67
8M-7012115-A—1950	6.57
1M-7212115-A—1951, std. trans.	7.78
1M-7212115-B—1951, Merc-o-matic	7.81
22 FRONT FLOOR PAN & REINFMT.	
8M-7911135—1949 to 1950	27.70
0M-7911135—1951	56.51
23 REAR FLOOR PAN	
8M-7911215—1949-50	65.50
0M-7911215—1951	62.45
24 REAR FLOOR PAN REAR EXTEN.	
7A-7911256—1949 to 1951 (right*)	1.69
25 FLOOR PAN DUST COVER PLATE	
8M-7912186—1949 to 1951 (right*)	82

26 FLOOR SIDE MEMBER	
8M-7910110—1949 to 1951 (right*)	8
27 BODY ROCKER PANEL	
8M-7910128—1949 to 1951 (right*)	11
28 DOOR ASSY. (Prime, less trim & hdw.)	
8M-7920122—1949 (right*) ...	85
0M-7920122-B—1950 (right*) ..	81
0M-7920122-B—1951 (right*) ..	81

**Back Window—
3 Piece Type***Early 1949**See Fig. 24*

1 BACK WINDOW END GLASS	
8M-7242018—1949 (right*) ...	6
2 BACK WINDOW CENTER GLASS	
8M-7242016—1949	21
3 WINDOW WTHSTP. ASSY.	
8M-7242082—1949	12

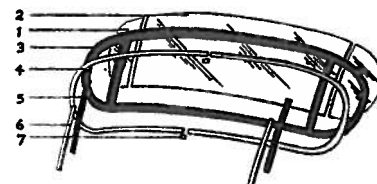
**Fig. 24**

* Opposite side one part number higher

BODY PARTS 1949 thru 1951 MERCURY

Models 9M, 0M and 1M. ALL BODY STYLES

4 WINDOW OUTER END MLDG. 8M-7242430—1949 (right*) ...	1.86
5 WINDOW DIV. BAR MLDG. RETAINER 8M-7242096—194981
6 WINDOW DIV. BAR OUTER MLDG. 8M-7242420—1949 (right*) ...	1.16
7 WINDOW JOINT COVER 8M-7242432—194905

Back Window— 1 Piece Type

All Models

See Fig. 25

1 WINDOW GLASS 8M-7242006—1949	34.29
8M-7242006—1950	28.70
1M-7242006-A—1951	28.70
2 WINDOW GLASS WTHSTP. 8M-7242082-B—1949	13.62
8M-7242084-B—1950	7.83
1M-7242084-C—1951	7.67

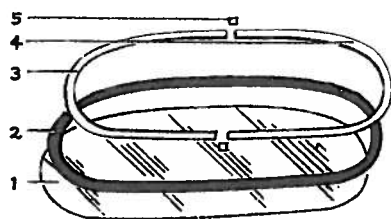

Fig. 25

3 WINDOW OUTER END MLDG. 8M-7242430—1949 (right)	1.86
8M-7242430-C—1950 (right) ..	1.86
1M-7242430—1951 (upper) ...	2.57
4 WINDOW OUTER END MLDG. 8M-7242431—1949 (left)	2.07
8M-7242431-C—1950 (left) ...	2.07
5 WINDOW MLDG. JOINT COVER 8M-7242432—194905
8M-7242432-B—195005

Rear Bumper

Except Station Wagon

See Fig. 26

1 REAR BUMPER IMPACT BAR 8M-17906-A—1949 to 1950 ...	33.50
1M-17906—1951	47.50

2 LICENSE PLATE GUARD 0M-17804—1949 to 1950	5.50
1M-17804—1951	5.50
3 BUMPER GUARD 8M-17984-A—1949 to 1950 (right*)	7.52
1M-17984—1951 (right*)	7.75
4 INNER BUMPER HANGER 8M-17787-A—1949 to 1950 (right*)	2.69
1M-17787—1951	2.38
5 OUTER BUMPER HANGER 8M-17795-A—1949 to 1950 (right*)	1.64
1M-17795—1951 (right*)	2.33

License Plate Lamp

Except 79—Station Wagon

See Fig. 27

LAMP ASSY. 8M-13550—1949 to 1951	2.43
1 LAMP RIM OR DOOR 7RA-13566—1949 to 195109
2 LAMP LENS 7RA-13564—1949 to 195117
3 LAMP LENS GASKET 7RA-13568—1949 to 195102
4 LAMP BULB B-13466—1949 to 195109
5 LAMP WIRING & SOCKET ASSY. 8M-13412—1949 to 195128

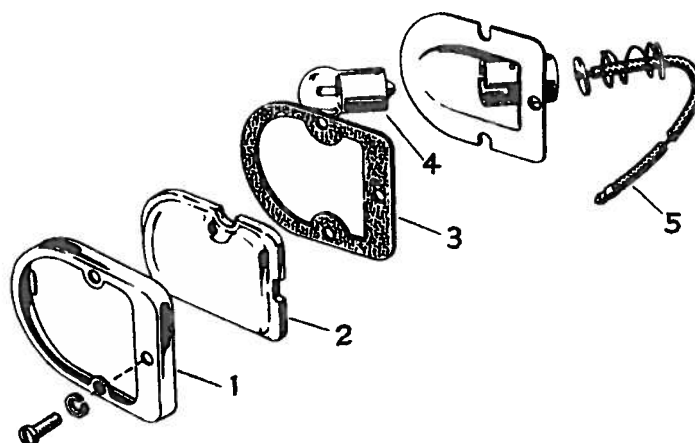

Fig. 27—License Plate Lamp, Except 79—Station Wagon

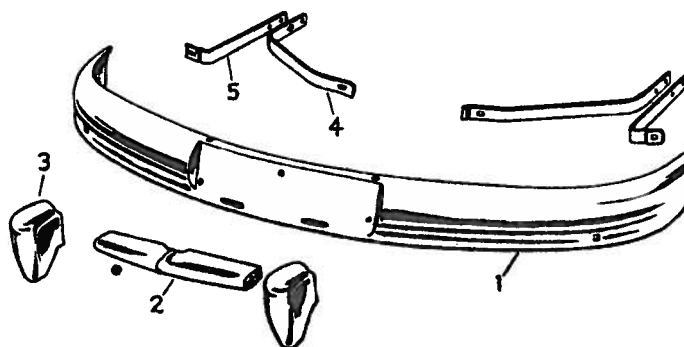
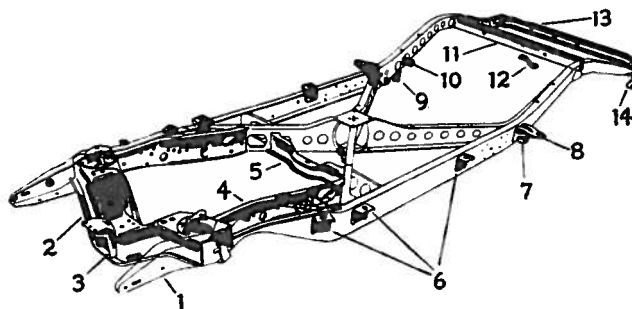

Fig. 26—Rear Bumper, Except Station Wagon

* Opposite side one part number higher

MERCURY 1949 thru 1951 BODY PARTS**Models 9M, 0M and 1M. ALL BODY STYLES****Frame***Body Type—72, 74, 76, 79**See Fig. 28*

1 FRAME ASSY.	
1M-5005-A—1949 to 1951, 72, 74, w/engine supt.	142.50
1M-5005-C—1949 to 1951, 76, w/engine supt.	187.50
1M-5005-B—1949 to 1951, 79..	142.50
2 FRONT CROSSMEMBER	
8M-5019-B—1949 late, to 1951	34.50
3 RADIATOR SUPT. BRKT.	
8M-5073—1949 to 1951	1.52
4 FRAME "K" BAR	
8M-5121—1949 to 1951 (right*)	6.18
5 ENGINE SUPT. BRKT., MEMBER	
1M-5059—1949 late, to 1951 ...	7.75
6 FRONT BODY BRKT.	
8M-5075—1949 to 195164
7 REAR SPRING HANGER FRONT	
8M-5770—1949 to 1951 (right*)	2.35
8 REAR BODY BRKT.	
8M-5078—1949 to 1951	1.41

*Fig. 28—Frame (Typical all models except Station Wagon)*

9 HAND BRAKE CABLE BRKT.	
8M-2530-A—1949 (right*)32
0M-2530—1950 to 195132
10 EXHAUST PIPE BRKT.	
8M-5233—1949 to 195170
11 INTERMEDIATE CROSS MEMBER	
8M-5029-C—1949 to 1951	5.83
12 FUEL TANK FRONT HANGER	
8M-9066—1949 to 195198
13 REAR CROSS MEMBER	
8M-5035-A—1949 to 1951, exc. E & B frames	7.0
8M-5035-B—1949 to 1951, E & B frames	12.0
14 REAR SPRG. SHACKLE HANGER	
8M-5610—1949 to early 1950.	2.1
0M-5610—1950 early to 1951..	1.9

STEERING GEOMETRY**1949 to 1951**

CASTER: 1949-50 $1\frac{1}{2}$ degree negative to $1\frac{1}{2}$ degree positive. 1951 0 to $1\frac{1}{2}$ degrees negative.

CAMBER: 0 to $\frac{3}{4}$ degree positive.

TOE-IN: $\frac{3}{32}$ to $\frac{5}{32}$ inch.

TOE-OUT TURNS (TURNING RADIUS):

Outer Wheel 20 degrees. Inner Wheel 22 degrees.

KING PIN INCLINATION: 1949-50 5 degrees. 1951 $5\frac{3}{4}$ degrees.

ADJUSTMENTS

CASTER: is adjusted by turning sleeve in the lower suspension arm. Turn towards the rear of the car to decrease caster, towards the front to increase.

CAMBER: is controlled by eccentric bushing at upper suspension arm.

TOE-IN: Centralize steering and adjust both tie-rods to give correct toe-in.

BODY PARTS 1949 thru 1951 MERCURY **Models 9M, 0M and 1M. ALL BODY STYLES**

Front Suspension Parts

See Fig. 29

1 UPPER CONTROL INNER SHAFT KIT 8M-3047—1949 to 1951	3.00
2 UPPER ARM & INNER SHAFT 8M-3044—1949 to 1951	8.60
3 UPPER ARM TO SPINDLE BOLT KIT 8M-3049—1949 to 1951	2.30
4 SPINDLE SUPT. ASSY. 8M-3052—1949 to 1951	10.35
5 SPINDLE BOLT & BUSHING KIT 8M-3111—1949 to 1951	4.30
6 SPINDLE BOLT BEARING HB-3123-A—1949 to 195183
7 INCLUDED IN ITEM NO. 5 ONLY	
8 SPINDLE ASSY. (Includes nut) 8M-3105—1949 to 1951	14.20
9 LOWER ARM SPINDLE SUPT. KIT 8M-3050—1949 to 1951	1.90
10 LOWER ARM & INNER SHAFT 8M-3042—1949 to 1951	10.95
11 LOWER INNER SHAFT KIT 8M-3048—1949 to 1951	5.09
12 SEE ITEM NO. 11	
13 FRONT SPRING 8M-5310-C—1949 to 1951, exc. 79 (yellow)	11.10
8M-5310-D—1949 to 1951, 79 (green)	11.10

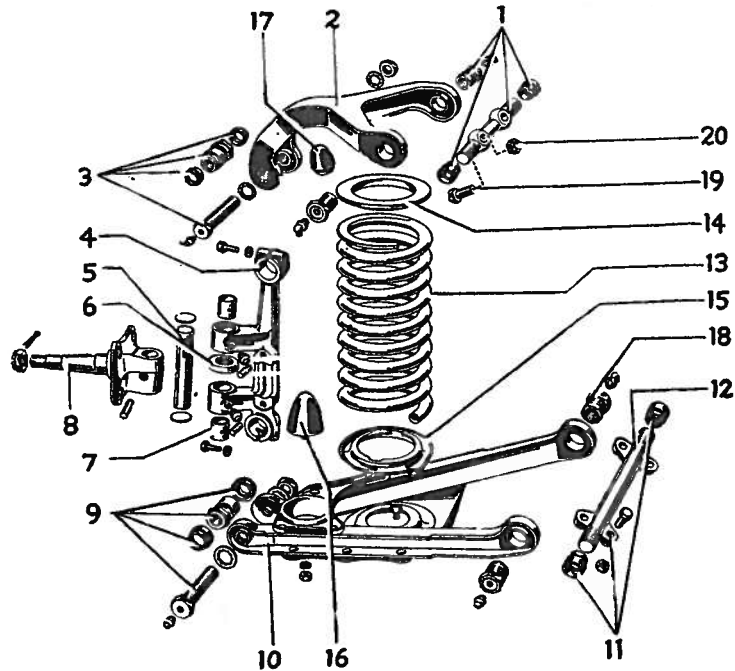

Fig. 29—Front Suspension Parts

14 SPRING UPPER INSULATOR 8M-5415-A—1949 to 195128	18 LOWER INNER SHAFT BUSHING 8M-3063—1949 to 195160
15 SPRING LOWER INSULATOR 8M-5415-A—1949 to 195132	19 UPPER ARM TO FRAME BOLT 350790-S7—1949 to 195117
16 LOWER ARM BUMPER 8M-3020-A—1949, early cars... 8M-3020-B—1949 late, to 1951.	.50 .50	20 UPPER ARM TO FRAME BOLT LOCKNUT 34451-S—1949 to 195112
17 UPPER REBOUND BUMPER 8M-3025—1949 to 195138		

* Opposite side one part number higher



MERCURY FRAMES

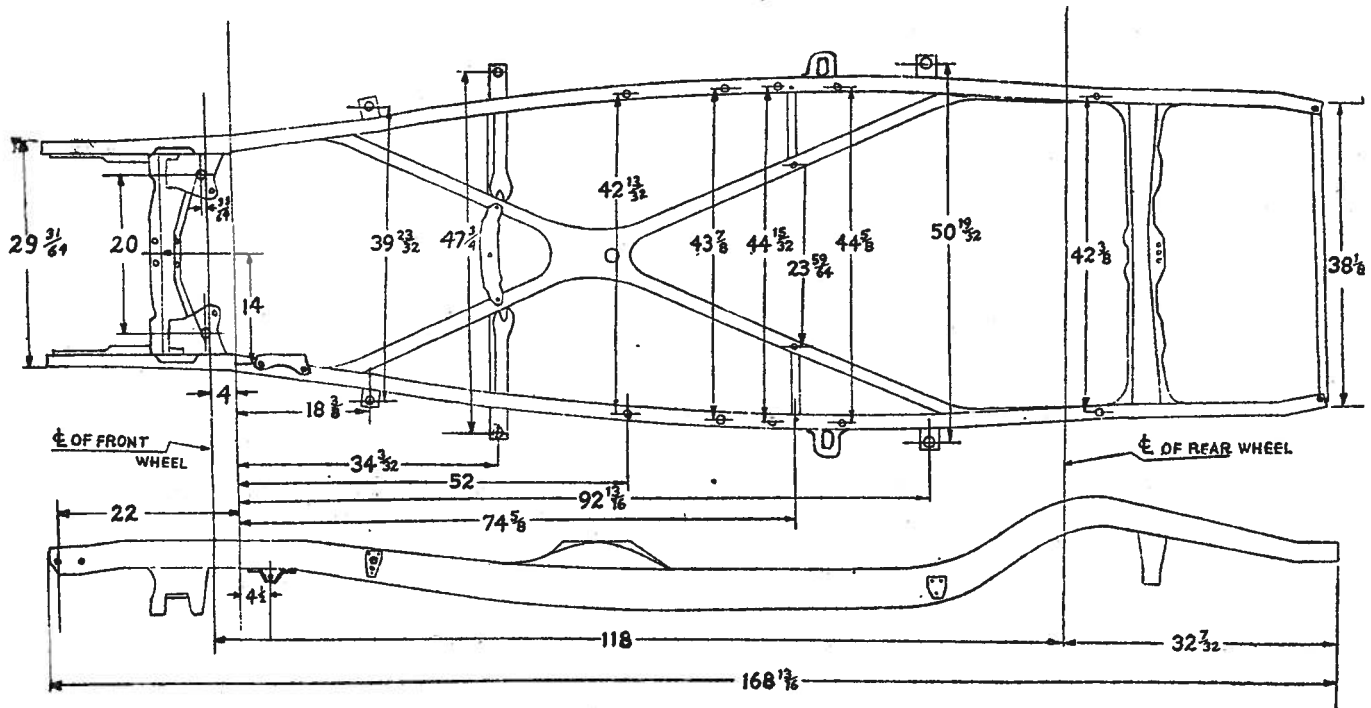

1946-48 passenger frame

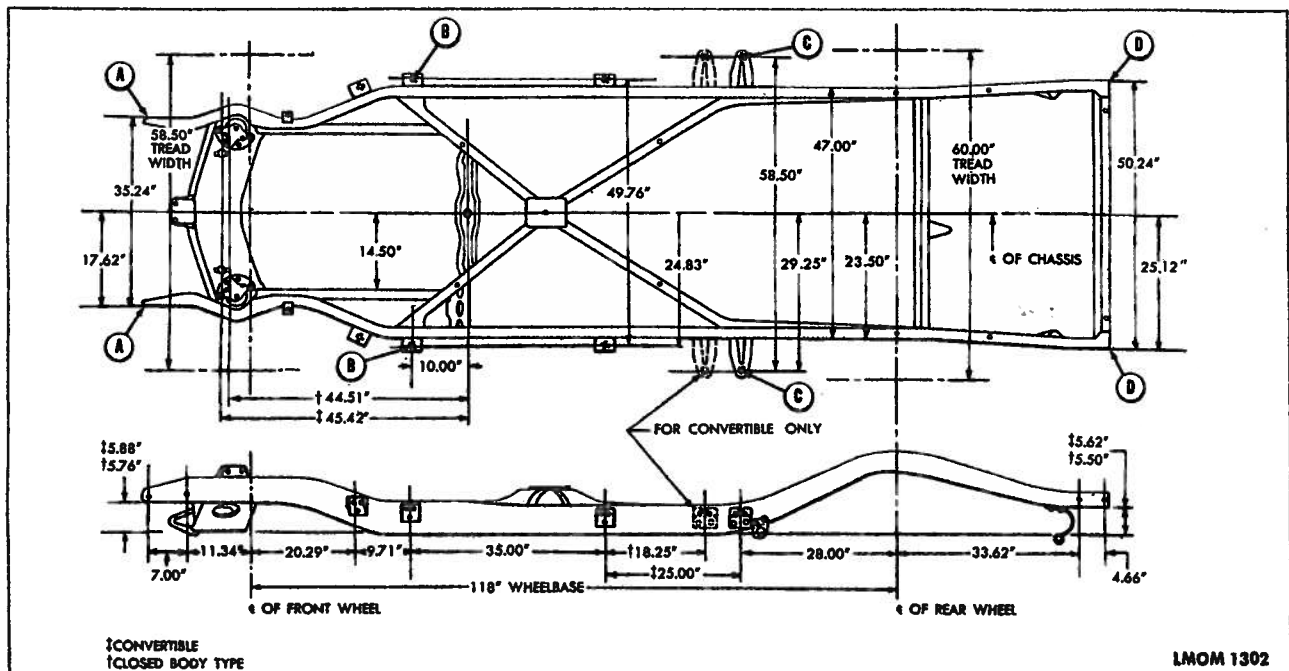

↑ CONVERTIBLE
↑ CLOSED BODY TYPE

LMOM 1302

Frame Dimensions