

LINCOLN and CONTINENTAL 1946 to 1948 BODY PARTS

Series 66H, 76H, 876H. ALL BODY STYLES

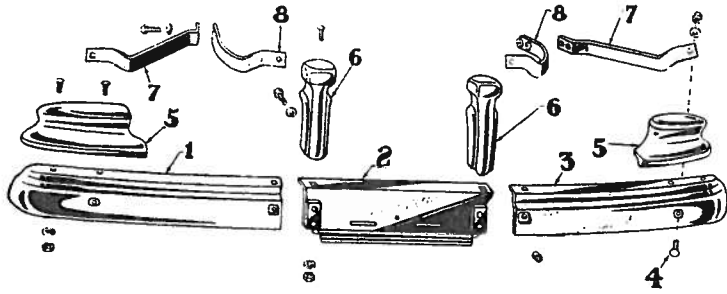

FRONT BUMPER ALL MODELS

Item	Part No.	Description	Price	Item	Part No.	Description	Price
	5EH-17748	Bumper & guard assy.	92.50	6	5EH-17997	Guard assy., L. H.	10.21
1	5EH-17756	Bar, outer, R. H.	16.00	6	5EH-17996	Guard assy., R. H.	10.21
2	26H-17752	Bar, center, L. H.	16.00	7	5EH-17754	Hanger, outer, R. H.	2.21
3	5EH-17757	Bar, outer, L. H.	16.00	7	5EH-17755	Hanger, outer, L. H.	2.21
4	26H-17758	Bolt	.25	8	26H-17766	Hanger, inner, R. H.	1.51
5	5EH-17811	Guard assy., L. H.	8.70	8	26H-17767	Hanger, inner, L. H.	1.51
5	5EH-17810	Guard assy., R. H.	8.70				

GRILLE AND SHIELD ALL MODELS

Item	Part No.	Description	Price
1	5EH-8206-A	Grille, R. H., w/fog lamp	5.10
1	5EH-8206-B	Grille, R. H., w/o fog lamp	4.60
1	5EH-8207-A	Grille, L. H., w/fog lamp	5.10
1	5EH-8207-B	Grille, L. H., w/o fog lamp	4.60
2	5EH-8204	Grille, R. H., low	11.95
2	5EH-8205	Grille, L. H., low	11.95
3	5EH-8355	Grille, center	3.20
4	5EH-8150	Grille, R. H., upper	22.25
4	5EH-8151	Grille, L. H., upper	22.25
5	5EH-16607	Emblem	2.50
6	5EH-8241	Grille, up, center	4.20
7	5EH-17777	Deflector, stone	7.20
8	26H-8209	Panel assy., splash	9.00
9	5EH-8312	Panel assy., air defect, R. H.	2.80
9	5EH-8313	Panel assy., air defect, L. H.	2.80
10	5EH-8242	Panel, grille, R. H.	2.50
10	5EH-8243	Panel, grille, L. H.	2.50
11	26H-8428	Support, up, grille, R. H.	.50
11	26H-8429	Support, up, grille, L. H.	.50
12	5EH-8407	Pillar assy., grille	3.80
	5EH-8195	Grille panel assy.	39.30

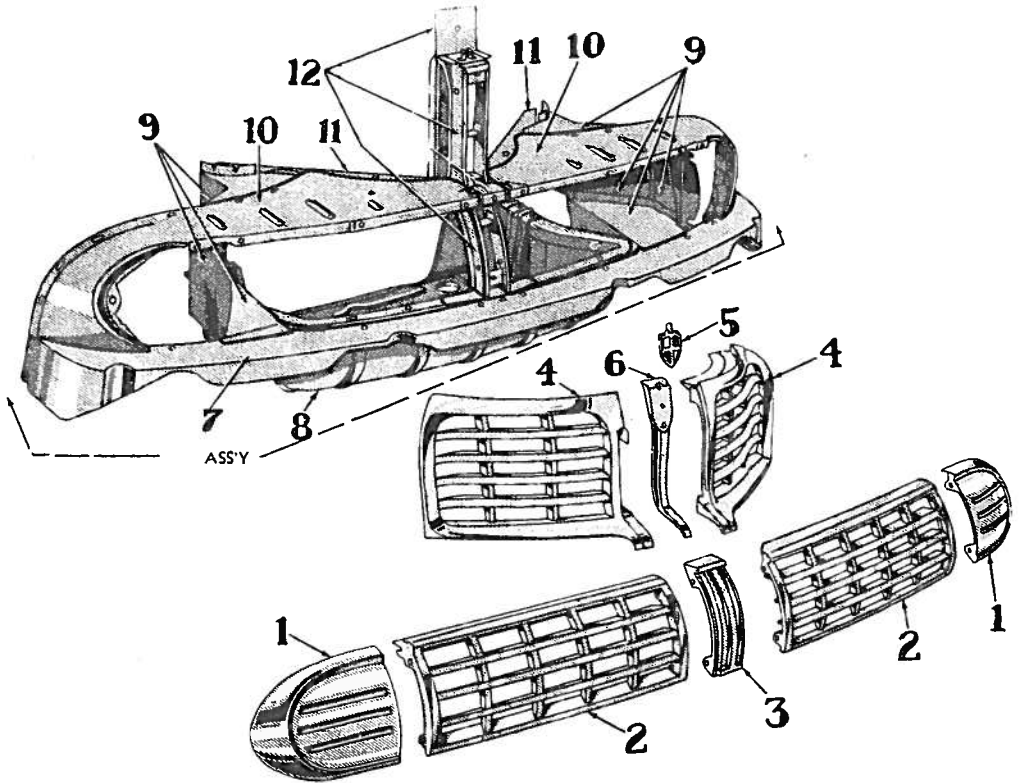

HEADLAMP ALL MODELS

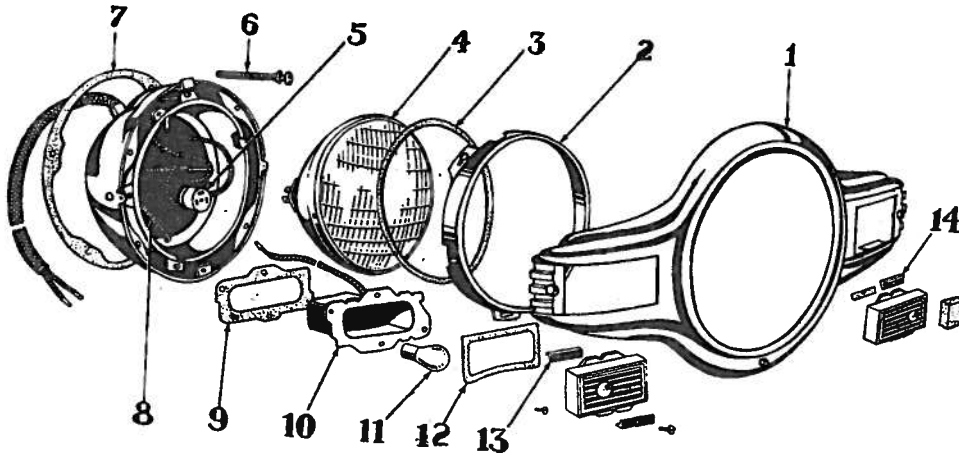

Item	Part No.	Description	Price
	19A-13002-A	Head lamp assy., less bulb, 66H, 76H	5.5
	51A-13002-A	Head lamp assy., less bulb, 876H	5.5
1	5EH-13045	Door	8.5
2	11A-13018-A	Ring	.5
3	01A-13039	Gasket	.0
4	09A-13007	Bulb	1.3
5	11A-13076	Wiring assy.	.9
6	11A-13032	Screw	.1
7	11A-13044-A	Gasket	.3
8	11A-13031	Spring	.0
9	26H-13217	Gasket	.1
10	26H-13202	Body & wires	2.4
11	11A-13465	Bulb	.4
12	26H-13065	Gasket	.1
13	19A-13540	Retainer	.5
14	26H-13208	Lens	.4

BODY PARTS 1946 to 1948 LINCOLN and CONTINENTAL

Series 66H, 76H, 876H. ALL BODY STYLES

HOOD

ALL MODELS
66H-76H-876H

Item Part No.	Description	Price
1 6H-16610-A	Hood assy., 1946-7 (Lincoln)	66.15
1 5EH-16610-B	Hood assy., 1946-7 (Continental)	205.00
1 6H-16610-A	Hood assy., 1947-8 (Lincoln)	66.15
2 26H-16776-A	Base, ornament	4.40
3 5EH-16624	Ornament, 1946-7	5.45
4 6H-16835	Ornament, 1947-8	5.55
5 26H-16606	Name plate	.95
6 26H-16723-A	Mldg.	4.20
7 5EH-16724	Name plt. (Lincoln)	.95
7 16H-5602386	Medallion (Lin. cont. in script)	1.45
7 6H-16724	Medallion (Lincoln in script)	1.50
8 5EH-16714	Ornament, 1946-7	4.10
9 6H-16930	Brkt.	.20
10 16H-16906	Anti rattle	.20
11 6H-16916-A	Cable assy. (Lincoln)	1.15
11 6H-16916-B	Cable assy. (Continental)	1.10
12 16H-16925	Spring	.10

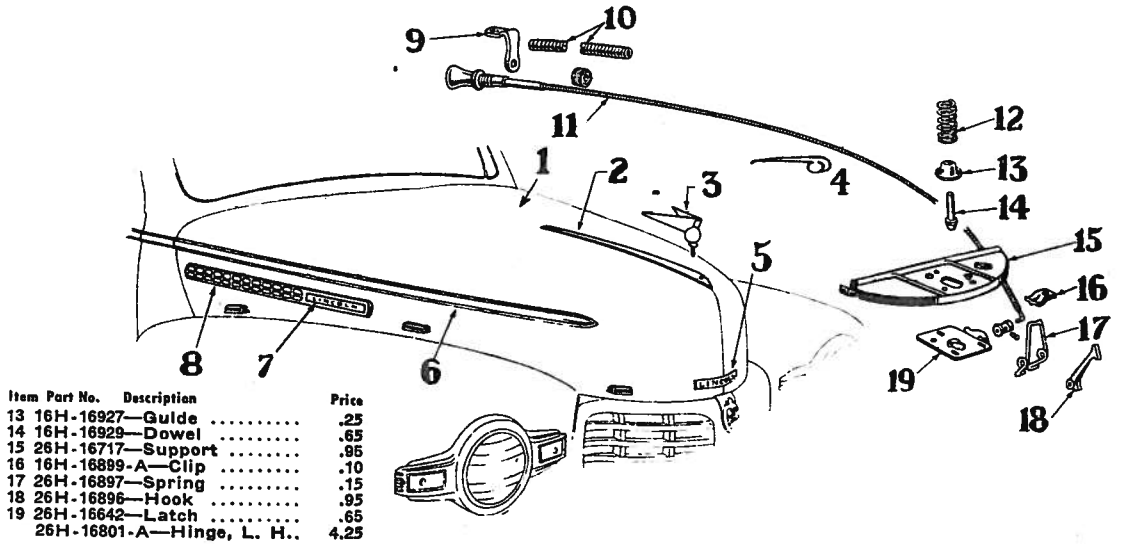

Item Part No.	Description	Price
13 16H-16927	Guide	.25
14 16H-16929	Dowel	.65
15 26H-16717	Support	.95
16 16H-16899-A	Clip	.10
17 26H-16897	Spring	.15
18 26H-16896	Hook	.95
19 26H-16642	Latch	.65
26H-16801-A	Hinge, L. H.	4.25

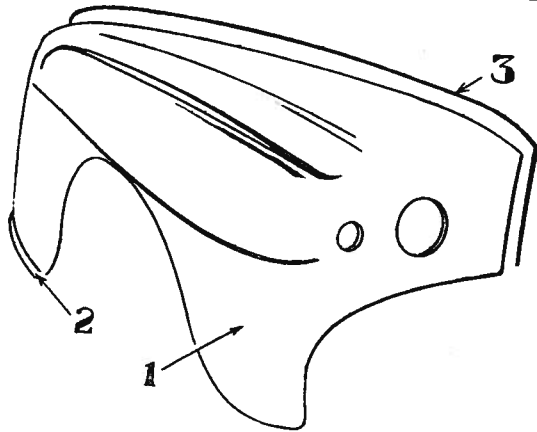

FRONT FENDER

Item Part No.	Description	Price	Item Part No.	Description	Price
1 5EH-16006-A	Fender (Lincoln)	47.85	26H-16094-B	Brace, rear (Cont.)	1.30
1 5EH-16006-B	Fender (Continental)	89.95	26H-16104	Lug	.10
2 26H-16039-A	Mldg. (Continental)	5.25	26H-16048	Brace, front	1.30
26H-16094-A	Brace, rear (Linc.)	.75	3 5EH-16084-A	Anti squeak (Linc.)	.85
			3 5EH-16084-L	Anti squeak (Cont.)	1.15

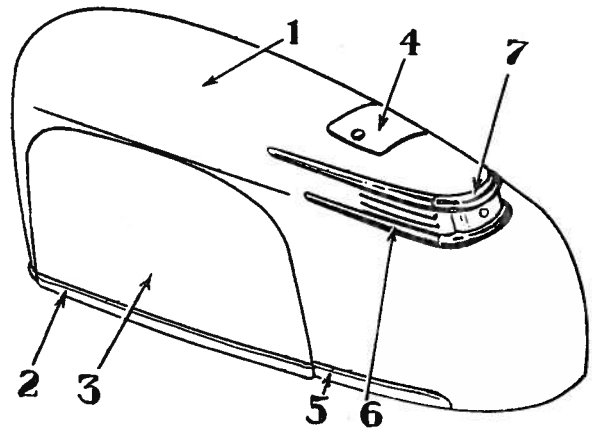

REAR FENDER ALL MODELS

Item Part No.	Description	Price	Item Part No.	Description	Price
1 26H-16313-A	Fender (Lincoln)	37.25	3 26H-16251	Cover plate	14.45
1 26H-16313-B	Fender (Continental)	53.40	4 26H-16370	Lid & hinge assy.	1.95
2 26H-16281-A	Mould, cover plate	3.45	5 26H-16399-A	Mould, fndr.	1.70
			6 5EH-13477	Extension, lamp	3.60
			7 26H-13405-A	Lamp assy.	7.95

CAR BODY

LINCOLN

MODEL 73—SEDAN, 4-DOOR

Item Part No.	Description	Price
1 6H-16610-A	Hood assy., 1946-7	66.15
1 6H-16610-A	Hood assy., 1947-8	66.15
2 5EH-7302039	Panel, cowl side	22.70
3 06H-7302133	Cover & deflect. vent.	2.95
4 5EH-7320121-A	Door, frt. (prime)	48.30
5 26H-7324301	Pillar, center	12.85
6 5EH-7324821-A	Door, R. (prime)	48.30
7 26H-7350200	Panel, roof	57.50
8 5EH-7340110	Door, deck	50.95
9 26H-7340320	Panel, low. back	3.10
10 5EH-7327817	Panel & frame assy., qt.	62.25
11 26H-7313227	Sup., R. door scuff plt.	1.75
12 26H-7313207	Sup., F. door scuff plt.	1.90

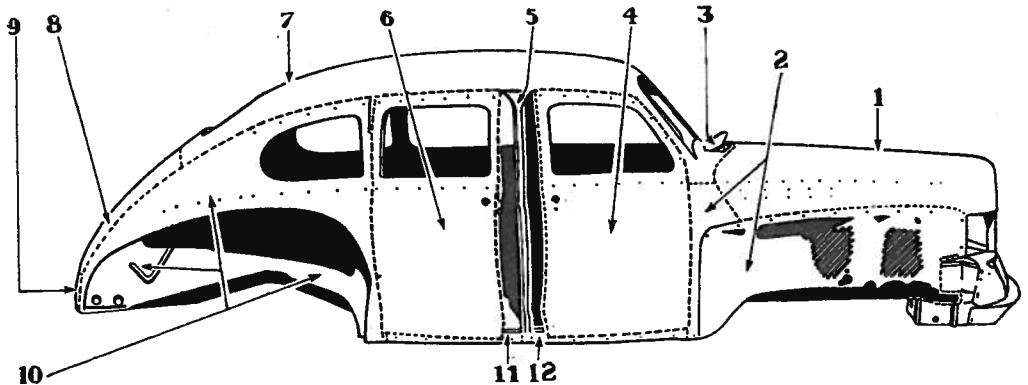

Body Sheet Metal

LINCOLN and CONTINENTAL 1946 to 1948 BODY PARTS

Series 66H, 76H, 876H. ALL BODY STYLES

FRONT DOOR PARTS

MODEL 73—LINCOLN, 4-DOOR SEDAN

Item	Part No.	Description	Price
	5EH-7320121-A	Door assy. (prime)	48.30
1	26H-7322885	Rainshield	1.30
2	5EH-7320941	Fin. strip, vent.	17.85
3	16H-7323058	Brkt.	.20
4	06H-7321449-B	Wthstp., vent.	1.55
5	16H-7321229-B	Frame & glass, vent.	9.95
6	11A-7022858	Latch	.80
7	06H-7321465-B	Clamp	.20
8	5EH-7323410	Handle, vent.	1.15
9	5EH-7323420	Escutcheon	.55
10	16H-7323468	Retainer	.30
11	16H-7323456	Shaft	.40
12	16H-7323460	Worm	.50
13	5EH-7321850	Knob	.30
14	5EH-7321450-A	Wthstp., div. bar	.50
15	26H-7321498	Run & clip assy.	.50
16	5EH-7322297	Bar & wthstp. assy., div.	5.80
17	5EH-7321462-A	Chan. & brkt. assy.	1.15
18	5EH-7721510-A	Wthstp.	.30
19	16H-7321439	Wthstp., in.	.50
19	16H-7321437	Wthstp., out.	.55
20	5EH-7321534	Run, side & top	1.15
21	5EH-7321410	Glass	7.90
22	16H-7321249	Spring, dr. opener	1.95
23	16H-7321831-B	Control	1.15
24	16H-7322646	Spring	.15
25	5EH-7322614	Button	1.55
28	5EH-7322618	Escutcheon	1.55
27	5EH-7322400	Button	1.55
28	16H-7321813	Lock	4.25

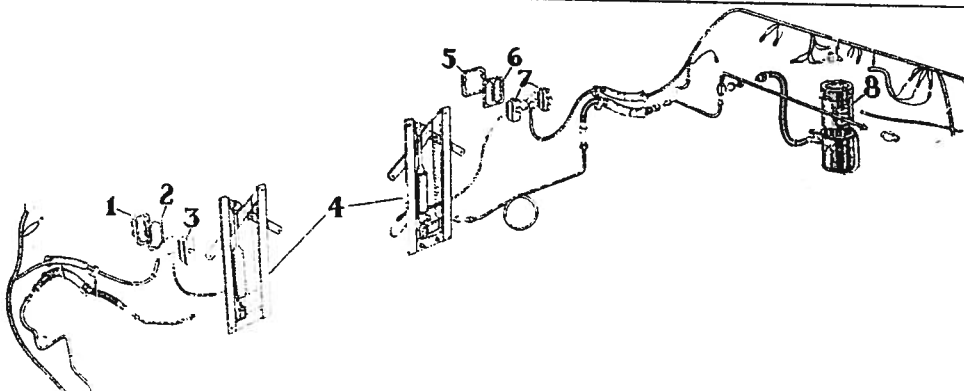
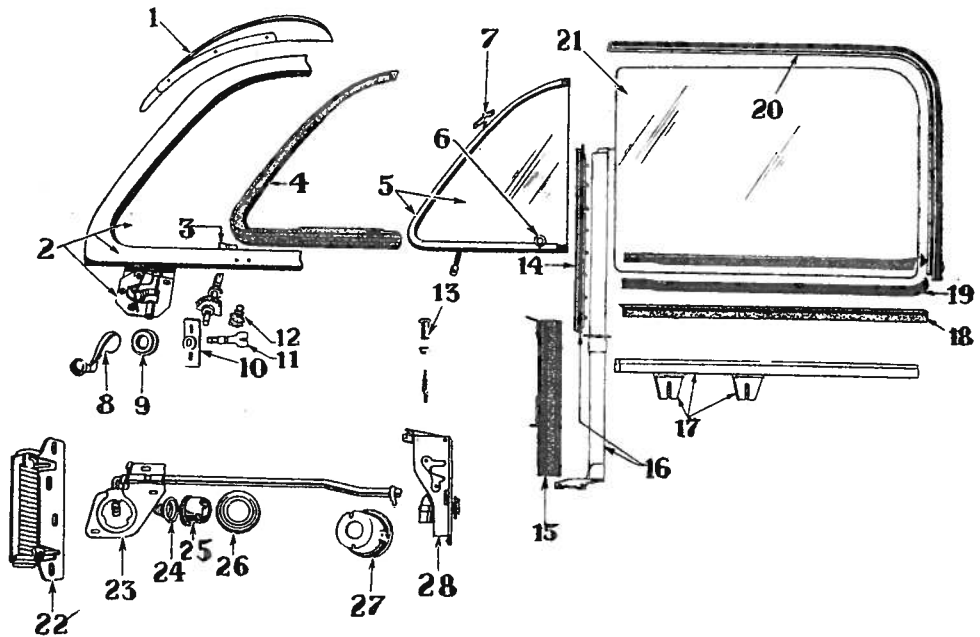

HYDRAULIC WINDOW LIFT MODEL 73—LINCOLN, 4-DOOR SEDAN

Item	Part No.	Description	Price
1	5EH-7324207	Plate, R. dr.	.25
2	5EH-7324230	Escutcheon	.45
3	5EH-7324208	Switch	1.85
4	5EH-7323200-A	Regltr., R. dr., WDO	13.20
4	5EH-7323200-A	Regltr., F. dr., WDO	13.20
5	5EH-7324235-A	Plate, F. dr.	.15
6	5EH-7324232-A	Escutcheon	.85
7	5EH-7324206	Switch	1.85
8	5EH-7353335	Motor & hyd. pump. assy.	39.25

CAR BODY

LINCOLN
MODEL 76—CONVERTIBLE COUPE

Item	Part No.	Description	Price
1	6H-16610-A	Hood assy., 1946-7	66.15
1	6H-16610-A	Hood assy., 1947-8	66.15
2	26H-7602007	Panel, cowl top & pillar	25.05
3	06H-7302133	Cover & deflect. vent.	2.95
4	06H-7603408	Header assy., wndshld.	12.85
5	26H-7627855	Panel, R. qt., upper	9.60
6	26H-7640314	Panel, up. back	30.10
7	5EH-7240110	Door, R. deck	35.35
8	26H-7340320	Panel, low. back	3.10
9	26H-7227851	Panel, R. qt., low.	5.15
10	26H-7627841	Panel assy., R. qt., low.	58.50
11	5EH-7620121-A	Door assy. (prime)	102.45
12	26H-7218207	Sup., scuff plt.	1.75
13	5EH-7302039	Panel assy., cowl side	22.70

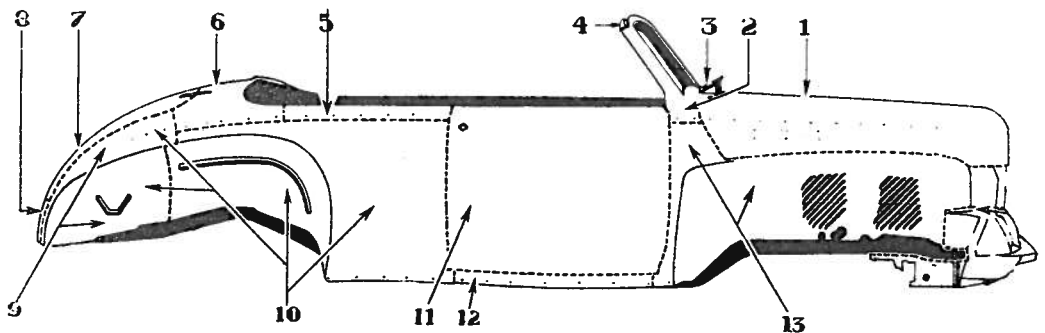

Body Sheet Metal

BODY PARTS 1946 to 1948 LINCOLN and CONTINENTAL

Series 66H, 76H, 876H. ALL BODY STYLES

FRONT DOOR HYDRAULIC WINDOW LIFT

MODEL 76—LINCOLN CON-
VERTIBLE COUPE
MODEL 77—LINCOLN CLUB
COUPE

Item Part No.	Description	Price
1	5EH-7323200-A—Regitr., WDO (77)	13.20
1	5EH-7623200-A—Regitr., WDO (76)	12.75
2	5EH-7324235-A—Plate, double	.15
3	5EH-7324232-A—Escutcheon, double	.65
4	5EH-7324206-C—Switch, WDO control	1.85
5	5EH-7353335—Motor & hyd. pump assy.	39.25
6	5EH-7324206-C—Switch	1.85
7	5EH-7324230—Escutcheon, single	.45
8	5EH-7324207—Plate, single	.25

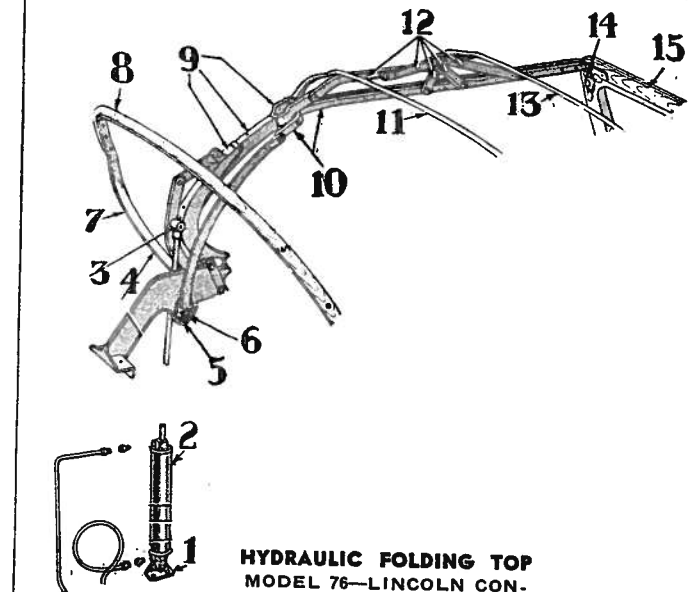
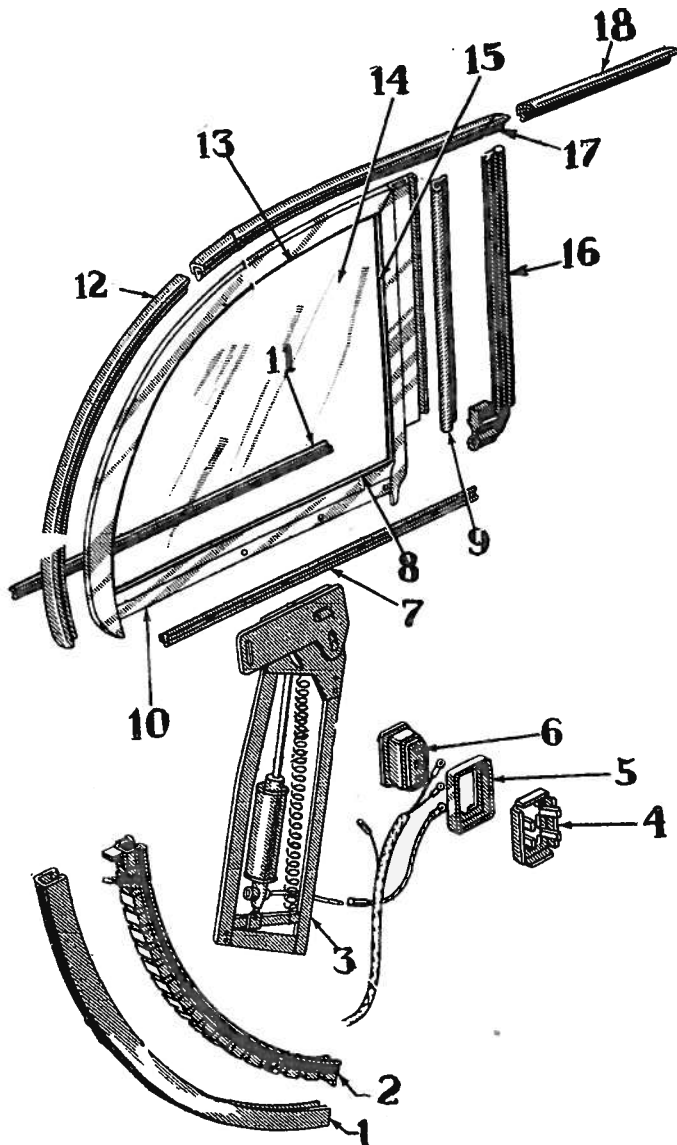
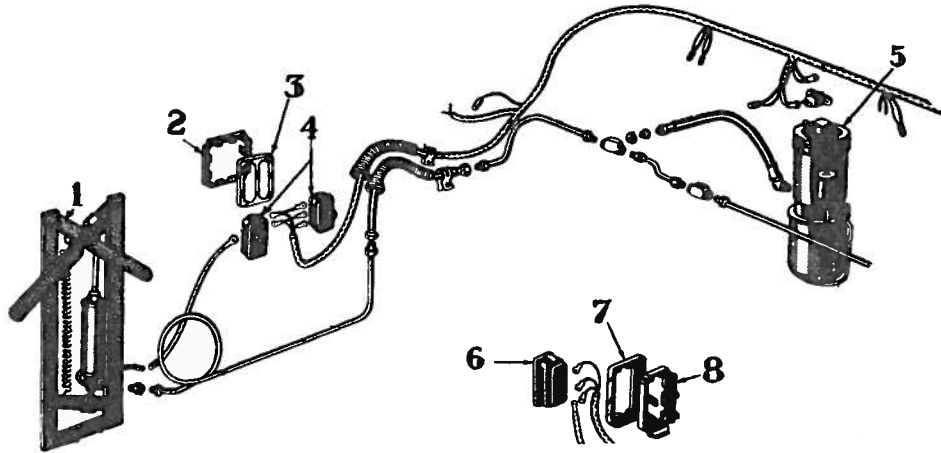

HYDRAULIC FOLDING TOP MODEL 76—LINCOLN CON- VERTIBLE COUPE

Item Part No.	Description	Price	Item Part No.	Description	Price
1	26H-7650764—Brkt., cyl.	.55	10	26H-7651213—Rail assy., roof side	9.95
2	5EH-7650598—Cylinder	18.95	11	26H-7651272—Bow, No. 2 top	4.35
3	26H-7650774—Yoke	.55	12	26H-7650303—Slat iron assy., top	7.15
4	26H-7651278—Bow & slat assy., No. 3 top	17.85	13	26H-7651276—Bow, No. 1 top	4.10
5	26H-7653119—Brkt. (top joint low.)	12.15	14	06H-7650833—Brkt., corner	5.40
6	26H-7653123—Plate	.30	14	06H-7603465—Brkt., dowel	9.35
7	26H-7650341—Slat iron (top R. bow)	7.50	14	96H-7653021—Toggle	9.50
8	26H-7651280—Bow, No. 3 top	10.75	15	06H-7651100—Rail assy., front	24.50
9	26H-7628111—Pillar assy., qt. lock upr.	15.70			

QUARTER WINDOW (HYDR.) MODEL 76—LINCOLN CONVERTIBLE

Item Part No.	Description	Price	Item Part No.	Description	Price
1	26H-7630132—Retainer, low. run	1.10	9	26H-7629906-A—Retainer, frt. wthstp.	.65
2	26H-7630100—Run & clip. assy., low.	1.95	10	5EH-7629901—Chan. & ret. assy.	10.35
3	5EH-7630307—Reg. assy., qt., WDO	14.85	11	26H-7629911-A—Wthstp. assy., inner	.40
4	5EH-7324207—Plate	.25	12	26H-76515671-A—Wthstp.	1.40
5	5EH-7324230—Escutcheon	.45	13	26H-7630618—Wthstp., up.	1.15
6	5EH-7324206-C—Switch, control	1.85	14	26H-7629710—Glass	5.10
7	26H-7629909-A—Wthstp. assy., outer	.45	15	26H-7630616—Wthstp., front	1.15
8	26H-7629070—Wthstp., bottom	1.15	16	26H-7629905—Wthstp.	2.85
			17	26H-7651565—Wthstp.	1.60
			18	26H-7651563—Wthstp.	1.90

LINCOLN and CONTINENTAL 1946 to 1948 BODY PARTS

Series 66H, 76H, 876H. ALL BODY STYLES

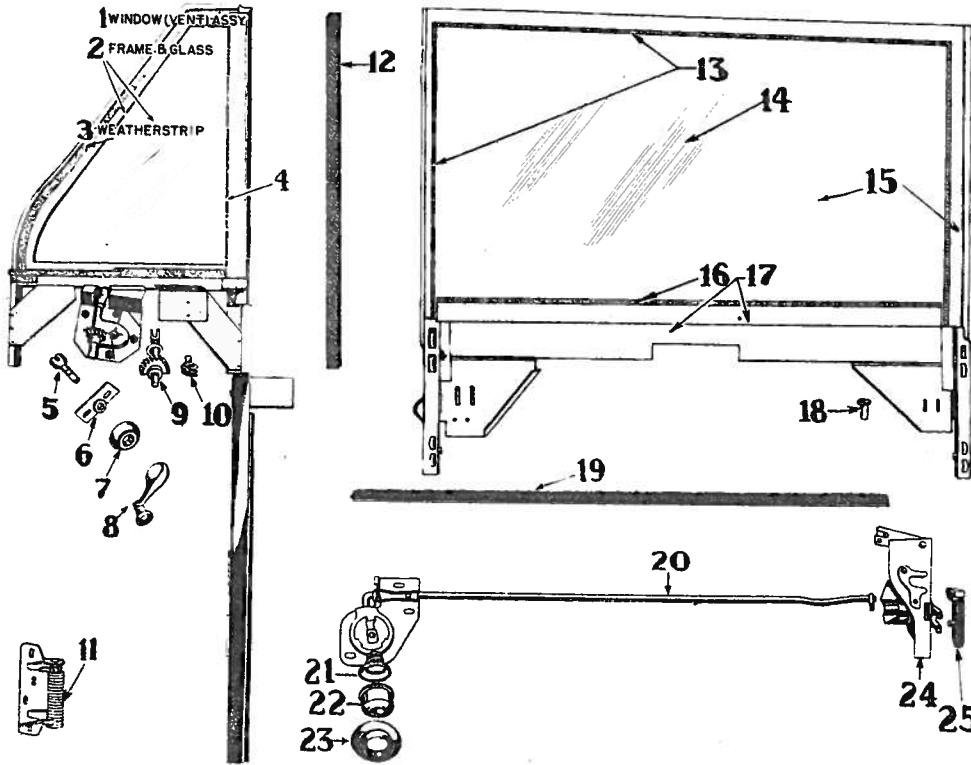

FRONT DOOR PARTS MODEL 76—LINCOLN CONVERTIBLE

Item	Part No.	Description	Price
	5EH-7620121	—Door assy. (prime)	102.45
1	26H-7621403-A	Window assy., vent.	64.15
2	16H-7621229	—Frame & glass assy.	16.80
3	26H-7621449	—Wthstp.	5.30
4	06H-7621454	—Wthstp.	1.90
5	16H-7323456	—Shaft	.40
6	16H-7323468	—Retainer	.30
7	5EH-7323420	—Escutcheon	.55
8	5EH-7323410	—Handle	1.15
9	16H-5623436	—Gear & shaft	1.25
10	16H-7323460	—Worm	.50
11	16H-7321249	—Spring, dr. opener	1.95
12	26H-7621451-A	—Wthstp., div. bar	1.35
13	26H-7621444	—Wthstp.	1.20
14	26H-7621410	—Glass	7.30
15	5EH-7621401	—Fr. glass & chan.	38.35
16	86H-762280	—Wthstp.	2.00
17	5EH-7621463	—Chan. & guide	10.35
18	5EH-7321850	—Knob	.30
19	06H-7621436	—Wthstp., out.	.45
20	16H-7221831-B	—Control	1.75
21	16H-7322646	—Spring	.15
22	5EH-7322614	—Button	1.55
23	5EH-7322618	—Escutcheon	1.55
24	16H-7321813	—Lock	4.25
25	16H-7322079	—Pin, latch	.75

REAR BUMPER ALL MODELS (EXCEPT) CONTINENTAL

Item	Part No.	Description	Price
	5EH-17778-A	—Bumper & guard assy.	62.50
1	5EH-17906-A	—Bar, impact.	27.50
2	5EH-17988	—Guard, R.H.	9.35
3	5EH-17989	—Guard, L.H.	9.35
4	26H-17840	—Support, deflect.	.30
5	5EH-17779	—Guard, center	7.80
6	5EH-17782-A	—Rail, guard tie	3.05
7	5EH-18004-A	—Clamp, tie rail	.65
8	26H-17795	—Hanger, outer R.H.	1.10
8	26H-17796	—Hanger, outer L.H.	1.10
9	26H-17786	—Hanger, inner R.H.	1.35
9	26H-17787	—Hanger, inner L.H.	1.35

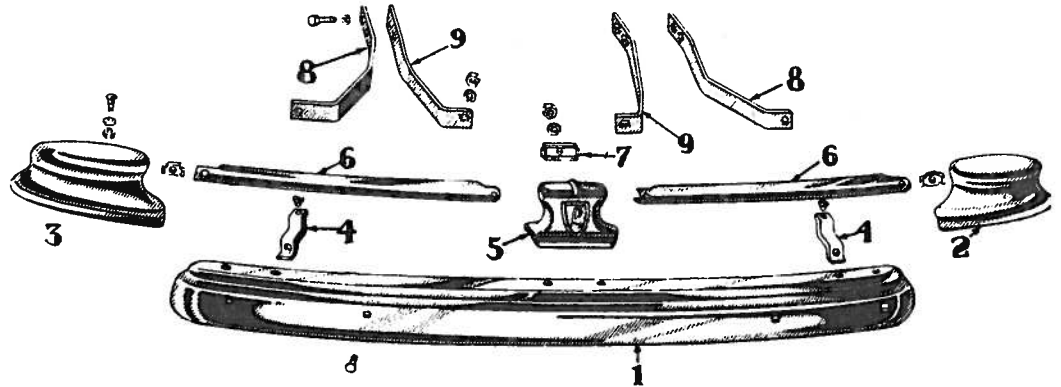

CAR BODY LINCOLN MODEL 77—CLUB COUPE

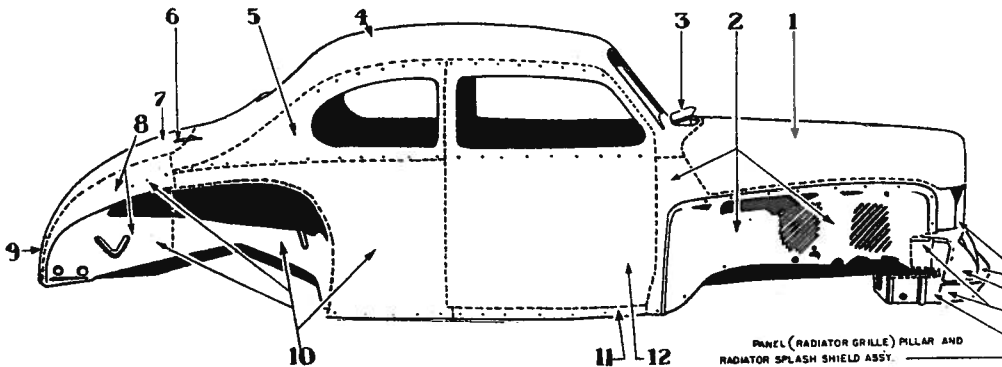

Body Sheet Metal

Item	Part No.	Description	Price
1	6H-16610-A	—Hood assy., 1946-7	66.1!
1	6H-16610-A	—Hood assy., 1947-8	66.1!
2	5EH-7302039	—Panel, cowl side	22.7!
3	06H-7302133	—Cover & deflect. vent.	2.9!
4	26H-7750200	—Panel, roof	47.1!
5	26H-7727863	—Panel & qt. WDO frame assy. (R. qt. up.)	20.2!
6	06H-7742701	—Hinge assy., R. deck	2.9!
7	5EH-7240110	—Door, R. deck	35.3
8	26H-7227851	—Panel, R. qt., lower	5.1
9	26H-7340320	—Panel assy., low. back	3.1
10	26H-7227841	—Panel assy., R. qt., low.	32.2
11	5EH-7323382	—Sup., scuff plt.	.7
12	5EH-7720121-A	—Door assy. (prime)	62.8

(CONT. ON NEXT PAGE) 308

BODY PARTS 1946 to 1948 LINCOLN and CONTINENTAL

Series 66H, 76H, 876H. ALL BODY STYLES

FRONT DOOR PARTS MODEL 77—LINCOLN CLUB COUPE

Item	Part No.	Description	Price
	5EH-7720121-A	Door assy. (prime)	62.85
1	26H-7322885	Rainshield	1.30
2	6H-7720941	Fln. strip, dr.	19.30
3	16H-7323058	Brkt.	.20
4	06H-7321449-B	Wthstp.	1.55
5	16H-7321229-B	Fr. & glass assy.	9.95
6	06H-7321465-B	Clamp	.20
7	11A-7022858	Latch	.80
8	5EH-7323410-C	Handle	1.15
9	5EH-7323420	Escutcheon	.55
10	16H-7323468	Retainer	.30
11	16H-7323456	Shaft	.40
12	16H-7323460	Worm	.50
13	5EH-7321850	Knob	.30
14	5EH-7321451-A	Wthstp.	.50
15	5EH-7222297	Bar, div. assy.	5.55
16	5EH-7721462	Chan. & brkt.	.85
17	5EH-7721510-A	Wthstp.	.30
18	16H-7721439	Wthstp, in.	.55
19	16H-7721437	Wthstp, out.	.55
20	5EH-7721534	Run	1.55
21	5EH-7721410	Glass	9.35
22	26H-7321498	Run, hinge side	.50
23	16H-7321249	Spring, dr. opener	1.95
24	16H-7221831-B	Control	1.75
25	16H-7322646	Spring	.15
26	5EH-7322614	Button	1.55
27	5EH-7322618	Escutcheon	1.55
28	5EH-7322400	Button	1.55
29	16H-7321813	Lock	4.25

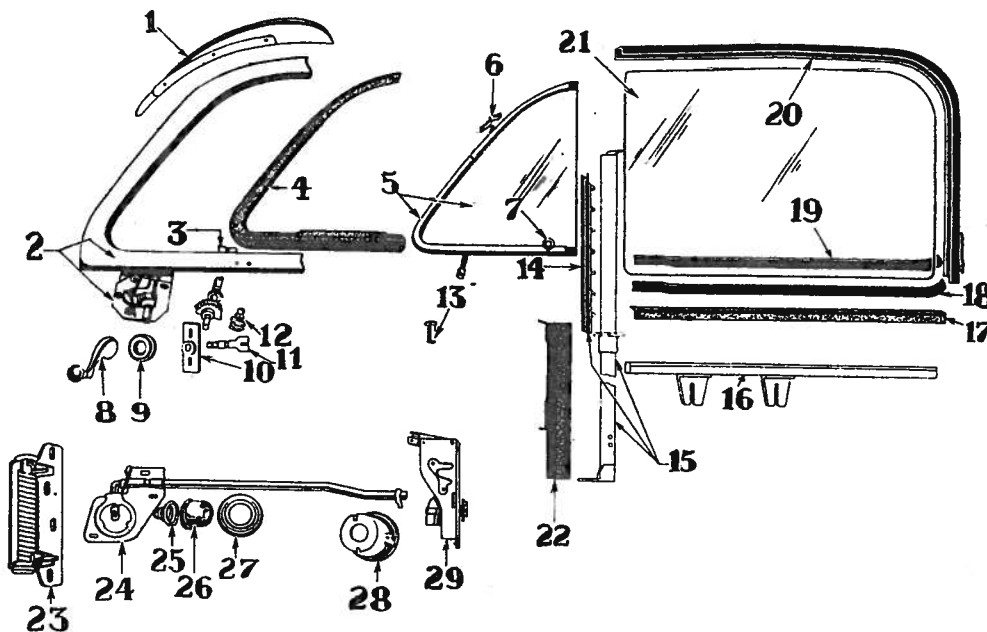

HYDRAULIC FOLDING TOP MODEL 56—CONTINENTAL CABRIOLET

Item	Part No.	Description	Price
1	26H-7650764	Brkt., cyl.	.55
2	5EH-5650598	Cylinder	9.35
3	06H-5624325	Brkt., lower	1.10
4	26H-7650774	Yoke, cyl.	.55
5	16H-5650644	Cover, spring	1.15
6	06H-5650610	Spring, bal.	.50
7	5EH-5650340	Slat iron, rear	7.50
8	06H-5651280	Bow, No. 3 top	42.95
9	16H-5650301	Slat iron assy., top	20.00
10	06H-5651276	Bow, No. 2 top	4.85
11	06H-5651143	Rail assy., top	12.85
12	06H-5651272	Bow, No. 1 top	4.80
13	06H-5651100	Rail, top frt.	27.55
14	06H-5628111	Pillar assy., qt. lock	17.15

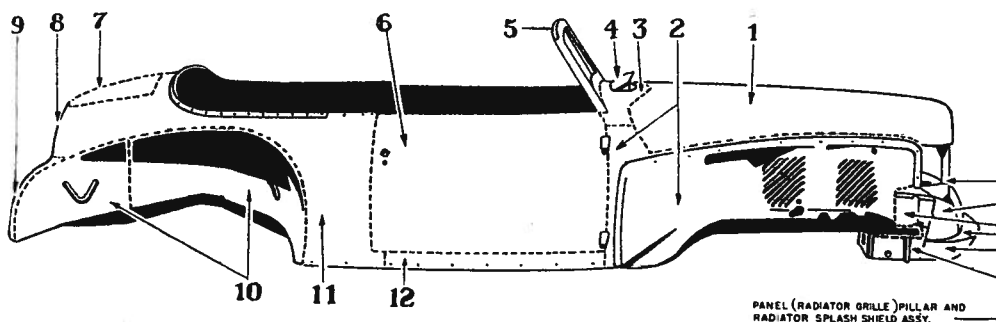
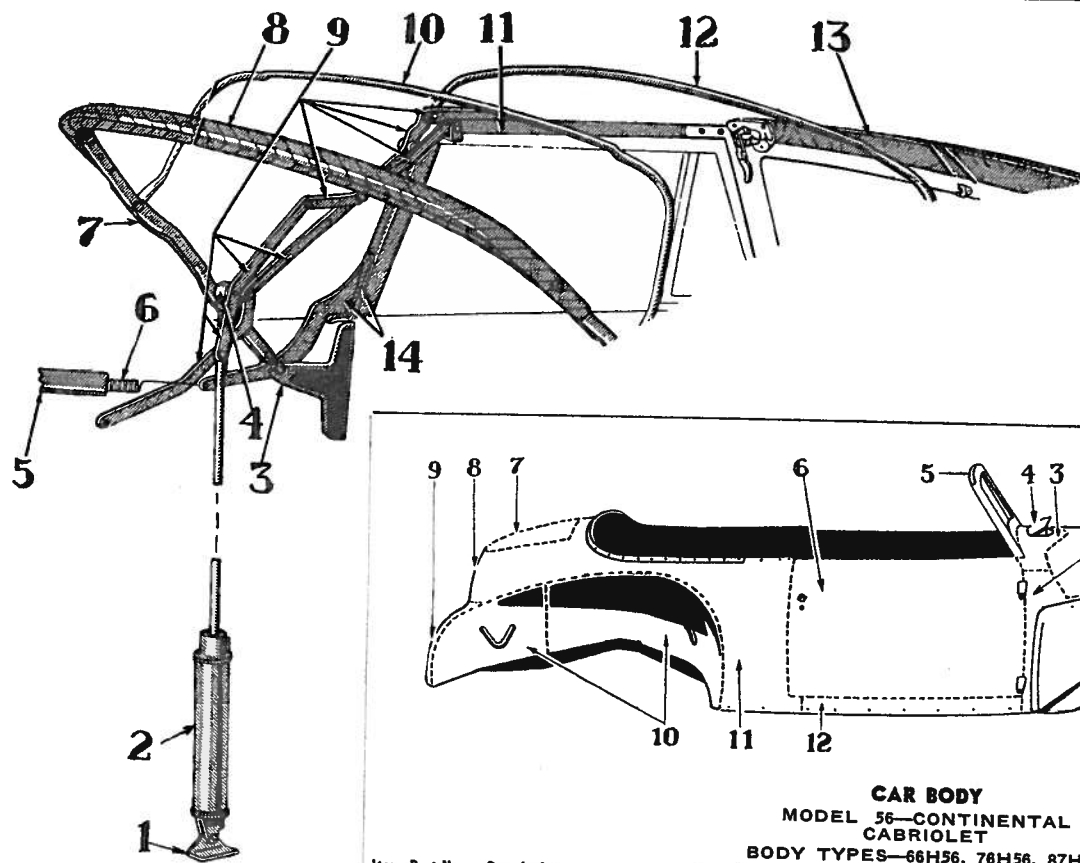

CAR BODY MODEL 56—CONTINENTAL CABRIOLET

Item	Part No.	Description	Price	Item	Part No.	Description	Price	Item	Part No.	Description	Price
1	5EH-16610-B	Hood assy.	205.00	5	06H-5603018	Frame, wind-shield	175.90	9	26H-5640320	Panel, low. back	24.50
2	5EH-5602039	Panel (cowl side) assy.	60.75	6	5EH-5620121	Door assy. (prime)	160.00	10	26H-5627883	Panel, R. qt. whl. house	39.75
3	26H-5602015	Panel (cowl top)	18.95	7	06H-5640110	Door (R. deck)	60.00	11	26H-5627847	Panel, qt.	12.45
4	06H-7302133	Cover & deflect. assy., cowl	2.95	8	06H-5640314	Panel, up. back	55.90	12	26H-5610131	Panel, rocker	10.00

LINCOLN and CONTINENTAL 1946 to 1948 BODY PARTS

Series 66H, 76H, 876H. ALL BODY STYLES

FRONT DOOR PARTS

MODEL 56—CONTINENTAL CABRIOLET

Item Part No.	Description	Price
5EH-5620121	Door Assy., prime	160.00
1 5EH-5621403	Window Assy., vent.	62.10
2 16H-5621229	Frame & glass Assy., vent.	13.25
3 26H-5621449	Wthstp., vent.	1.90
4 16H-5623436	Gear & shaft Assy.	1.25
5 26H-5623456	Shaft, exten.	.70
6 16H-7323468	Retainer, shaft	.30
7 5EH-7323420	Escutcheon	.55
8 5EH-5623410	Handle, vent.	1.60
9 16H-5621249	Spring Assy., dr. opener	1.90
10 26H-5621451-A	Wthstp., div. bar	.95
11 06H-5621444	Wthstp., up. channel	1.35
12 26H-5621410	Glass	8.60
13 5EH-5621401	Frame, glass & channel Assy., hyd.	53.40
14 86H-762280	Wthstp., low. channel	2.00
5EH-5621463	Channel & brkt. Assy.	8.70
16 06H-5621436	Wthstp., in. & out.	.50
17 5EH-7321850	Knob, locking	.20
18 26H-5621703	Channel & brkt., lock side	4.00
19 16H-5621831-B	Remote control	1.90
20 16H-5622400	Button, dr. lock, outer	4.80
21 16H-5621813	Lock	4.70
22 5EH-7322618	Escutcheon	1.35
23 5EH-7322614	Button, dr. lock, inner	1.53
24 16H-7322646	Spring	.20

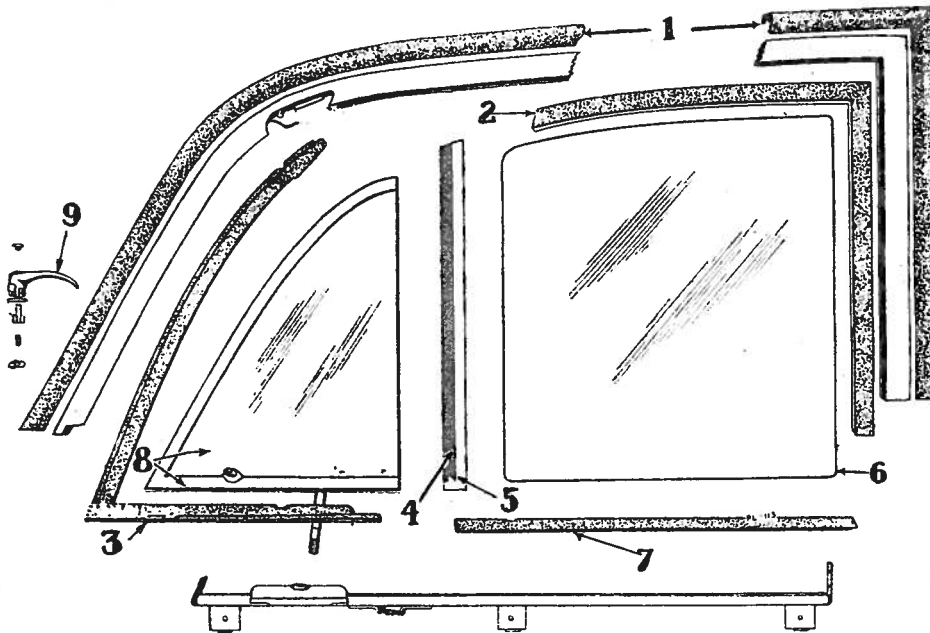
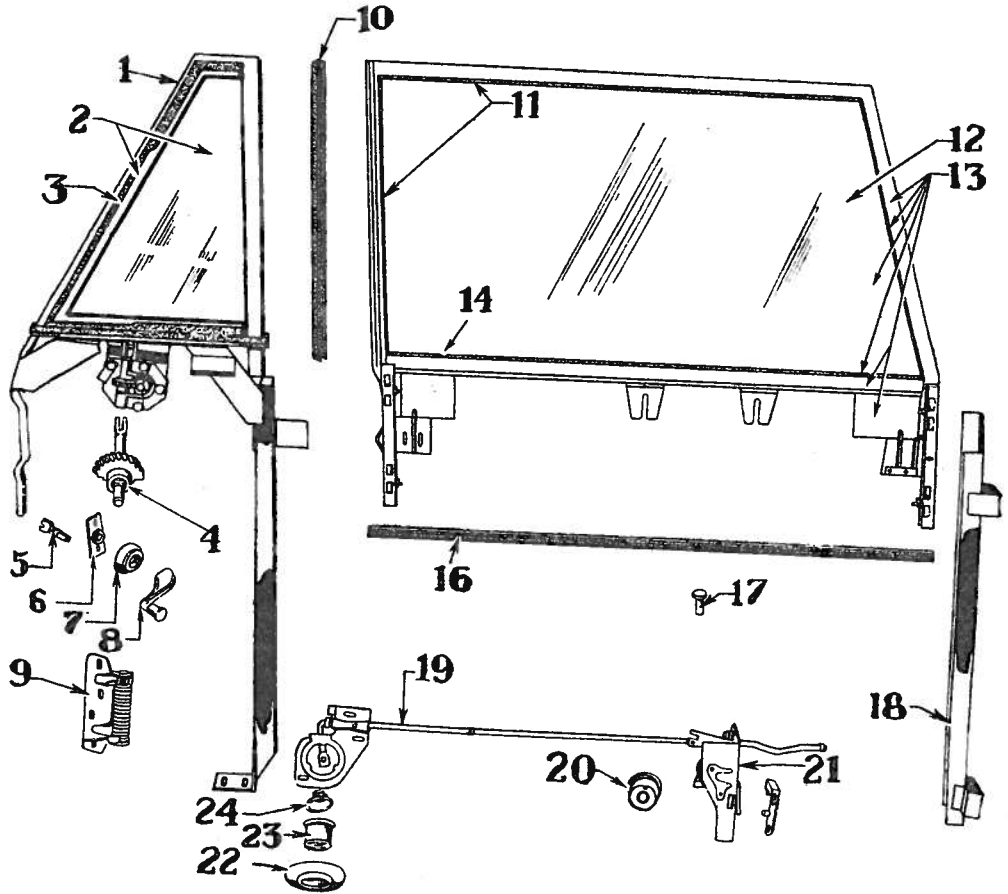

QUARTER WINDOW MODEL 57—CONTINENTAL COUPE

Item Part No.	Description	Price
1 06H-5729733	Wthstp., frame, outer	3.61
2 06H-5729934-A	Wthstp., top & sides	.71
3 06H-5730249	Wthstp., vent.	3.21
4 06H-5730238	Wthstp., div. bar	.41
5 06H-5730235	Bar Assy., div. WDO	2.21
6 06H-5729710-A	Glass, qt.	4.71
7 06H-5729071	Wthstp., bottom	1.31
8 06H-5730207	Frame & glass Assy.	12.11
9 01A-7022917-B	Handle	.51

BODY PARTS 1946 to 1948 LINCOLN and CONTINENTAL Series 66H, 76H, 876H. ALL BODY STYLES

CAR BODY

MODEL 57—CONTINENTAL

COUPE

BODY TYPES—66H57, 76H57, 876H57

Item Part No.	Description	Price
1	5EH-16610-B—Hood assy.	205.00
2	06H-7302133—Cover & delect., cowl vent.	2.95
3	26H-5602015—Panel, cowl top	18.95
4	06H-5703014—Frame assy., windshield	152.10
5	16H-5750200—Panel, roof	96.30
6	6H-7321984—Pillar, lock	1.55
7	06H-5640110—Door, deck	60.00
8	06H-5740314—Panel, up. back	32.50
9	26H-5640320—Panel, low. back	24.50
10	26H-5627883—Panel, R. qt. whl. house.	39.75
11	26H-5727847—Panel, qt.	15.35
12	5EH-5720121—Door (prime)	108.50
13	26H-5610131—Panel, rocker.	10.00
14	5EH-5602039—Panel (cowl side)	60.75

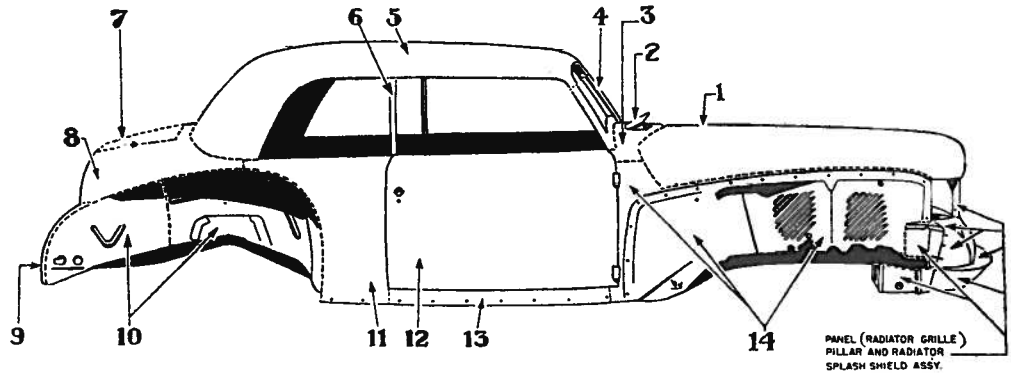

FRONT DOOR PARTS

MODEL 57—CONTINENTAL COUPE

Item Part No.	Description	Price
1	16H-5721229-B—Frame & glass assy., vent.	12.15
2	5EH-5721449—Wthstp., vent.	1.85
3	11A-7023058—Brkt., locking.	.15
4	16H-5623436—Gear & shaft assy.	1.25
5	16H-7323460—Worm	.50
6	26H-5623456—Shaft	.70
7	16H-7323468—Retainer	.30
8	5EH-7323420—Escutcheon	.55
9	5EH-5623410—Handle	1.60
10	16H-5621249—Spring, dr. opener	1.90
11	5EH-8721450-A—Wthstp., div. bar	.95
12	06H-5721534—Channel, run. top	.80
13	5EH-5721410—Glass	12.75
14	06H-5721534—Channel, run. lock side	.80
15	06H-5621436—Wthstp., inner-outer	.50
16	5EH-5721463—Channel, bottom	10.75
17	5EH-5722297—Bar assy., div.	4.50
18	5EH-7321850—Knob	.30
19	16H-5621852—Rod	.40
20	16H-5621831-B—Control, remote	1.90
21	16H-7322646—Spring	.15
22	5EH-7322614—Button, push	1.55
23	5EH-7322618—Escutcheon	1.55
24	16H-5621813—Lock	4.70
25	16H-5622400—Button, push, lock	4.80
26	16H-5622079—Pin, dr. lock.	2.95

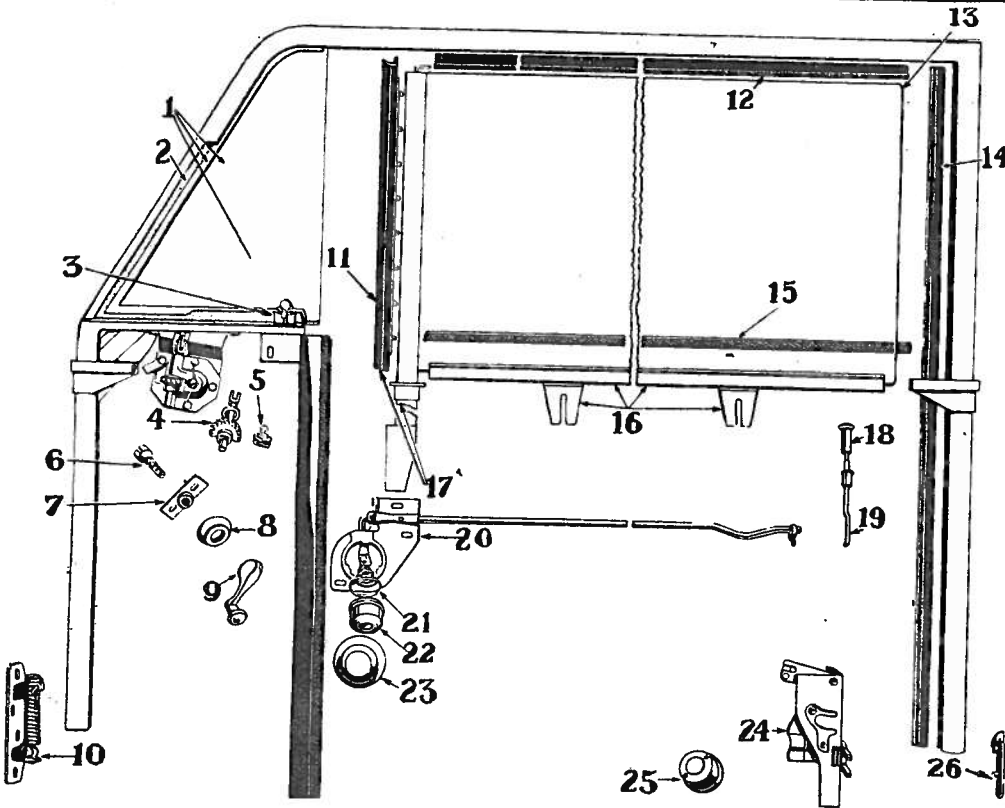

FRONT DOOR HYDRAULIC WINDOW LIFT

MODEL 56—CONTINENTAL CABRIOLET

MODEL 57—CONTINENTAL COUPE

Item Part No.	Description	Price
1	5EH-5623200-A—Regltr., WDO	12.75
2	5EH-7324235—Plate, double	.15
3	5EH-7324232-B—Escutcheon, double	.85
4	5EH-7324206-C—Switch, L.H.	1.85
5	5EH-7353335—Motor & hyd. pump assy.	39.25
6	5EH-7324206—Switch, R.H.	1.85
7	5EH-7324230—Escutcheon, single	.50
8	5EH-7324207—Plate, single.	.25

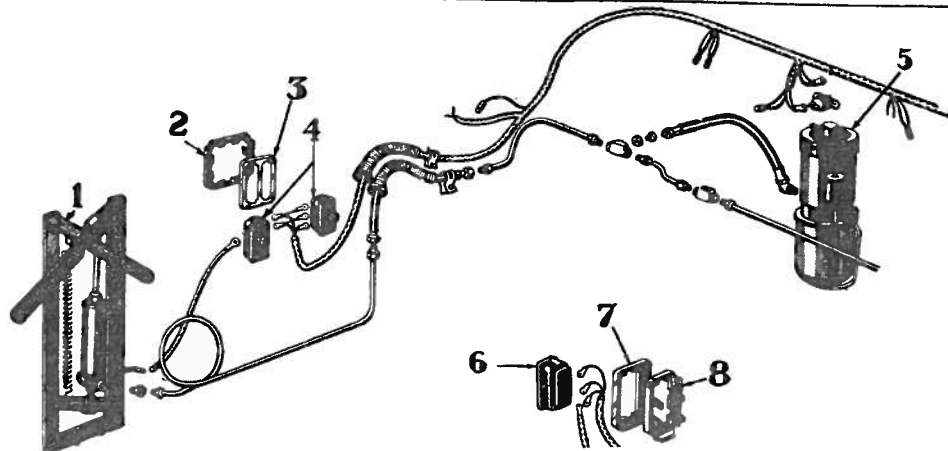

LINCOLN and CONTINENTAL 1946 to 1948 BODY PARTS

Series 66H, 76H, 876H. ALL BODY STYLES

REAR LICENSE AND STOP LAMP MODELS 73, 76, 77—LINCOLN

Item Part No.	Description	Price
5EH-13550	Lamp assy.	16.80
1 5EH-7322400	Button, lock push	1.55
2 6H-7343505	Lock	1.65
3 26H-7343244	Bolt15
4 26H-7343249	Retainer10
5 5EH-13553	Body	9.60
6 26H-13537	Gasket15
7 26H-13536	Lens55
8 B-13485	Bulb, S. lamp30
9 B-13466	Bulb, L. lamp10
10 26H-13555	Plate	1.55
11 5EH-13572-A	Pad55
12 16H-13560-A	Socket & wire assy. (73)	2.05
12 16H-13560-B	Socket & wire assy. (76-77)	2.05
13 16H-13568	Gasket10
14 16H-13564	Lens30

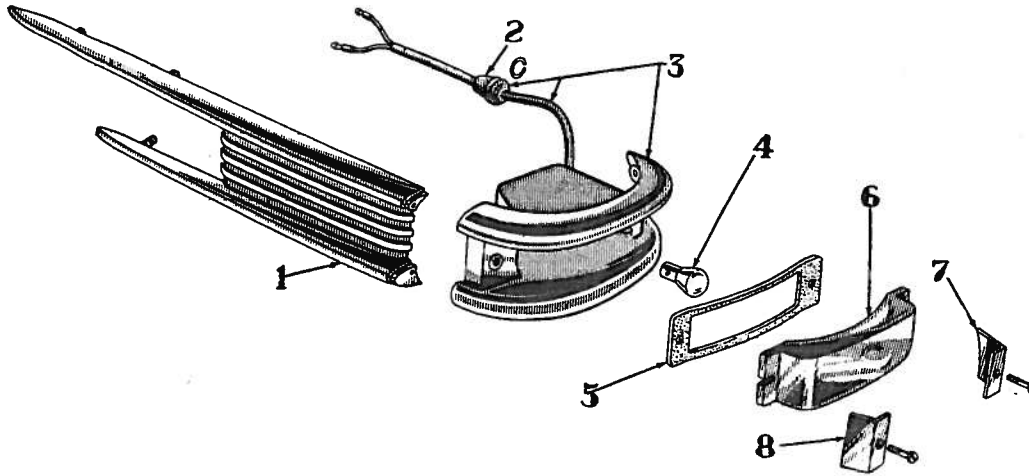
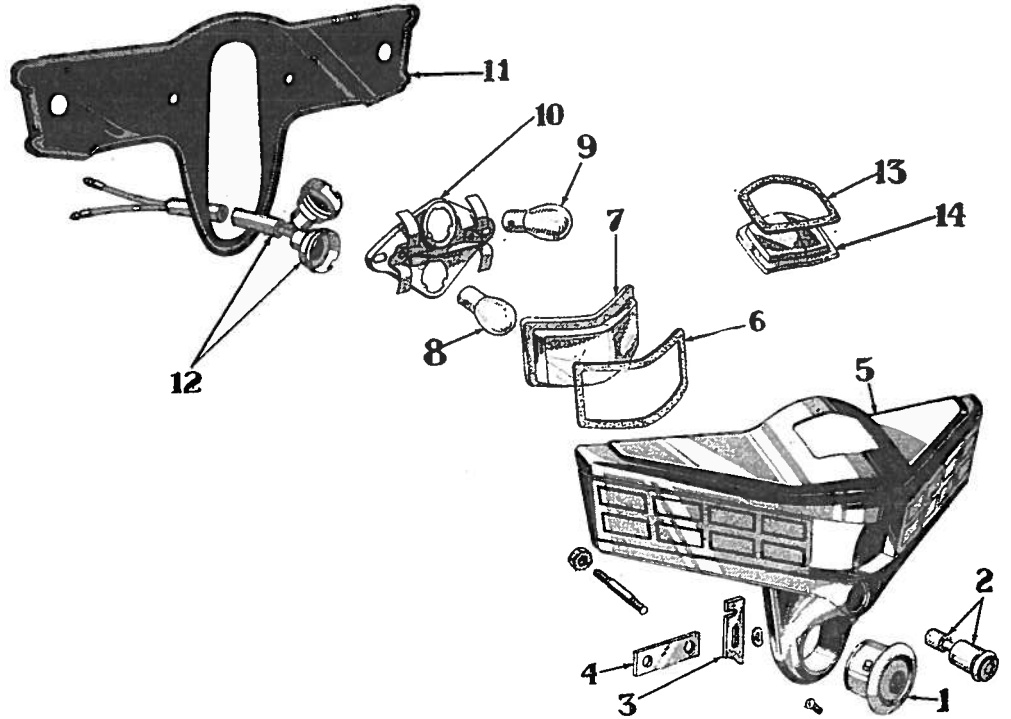

REAR LAMP ALL MODELS

Item Part No.	Description	Price
26H-13405-A	Lamp assy.	7.95
1 5EH-13477	Extension	3.60
2 26H-13091	Grommet10
3 26H-13408-A	Body, socket & wire assy.	4.50
4 11A-13485	Bulb30
5 26H-13481	Gasket15
6 26H-13450	Lens95
7 26H-13541-A	Retainer40
8 26H-13539-A	Retainer50

REAR BUMPER CONTINENTAL

Item Part No.	Description	Price
5EH-17778-B	Bumper & guard assy.	51.00
1 5EH-17906-B	Bar, impact	23.60
2 5EH-17988	Guard, R.H.	9.35
3 5EH-17989	Guard, L.H.	9.35
4 26H-17840	Support, deflect.30
6 5EH-17782-B	Rail, guard tie	3.10
7 5EH-18004-B	Clamp65
8 26H-17795	Hanger, outer R.H.	1.10
8 26H-17796	Hanger, outer L.H.	1.10
9 26H-17786	Hanger, inner R.H.	1.35
9 26H-17787	Hanger, inner L.H.	1.35

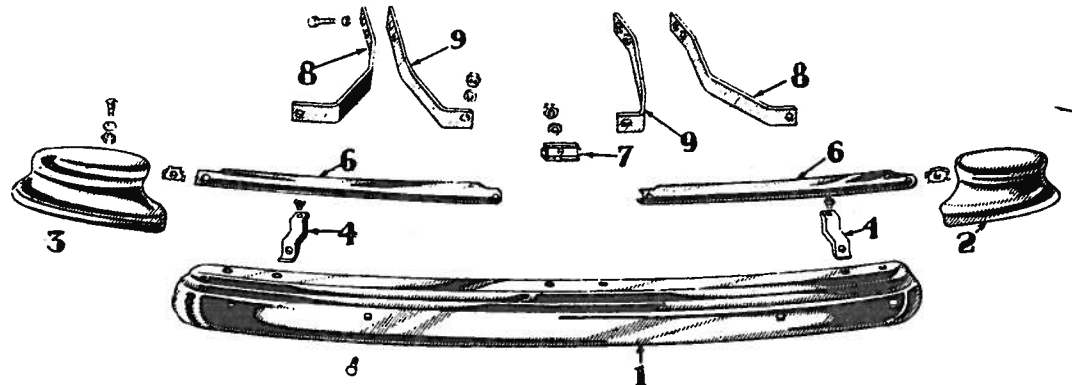

WIRING 1946 to 1948 LINCOLN and CONTINENTAL

Series 66H, 76H, 876H. ALL BODY STYLES

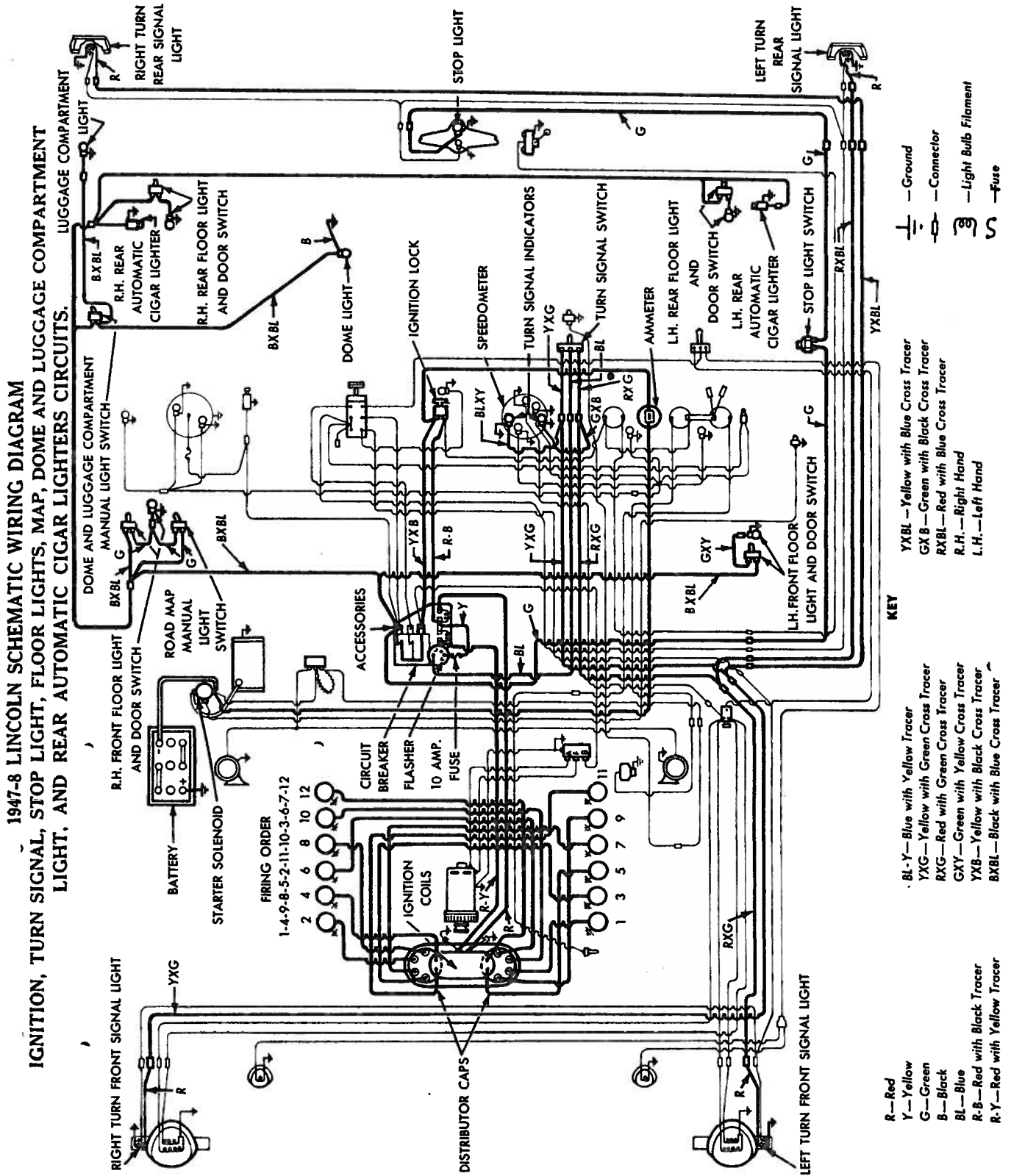

LINCOLN and CONTINENTAL 1946 to 1948 FRAME

Series 66H, 76H, 876H. ALL BODY STYLES

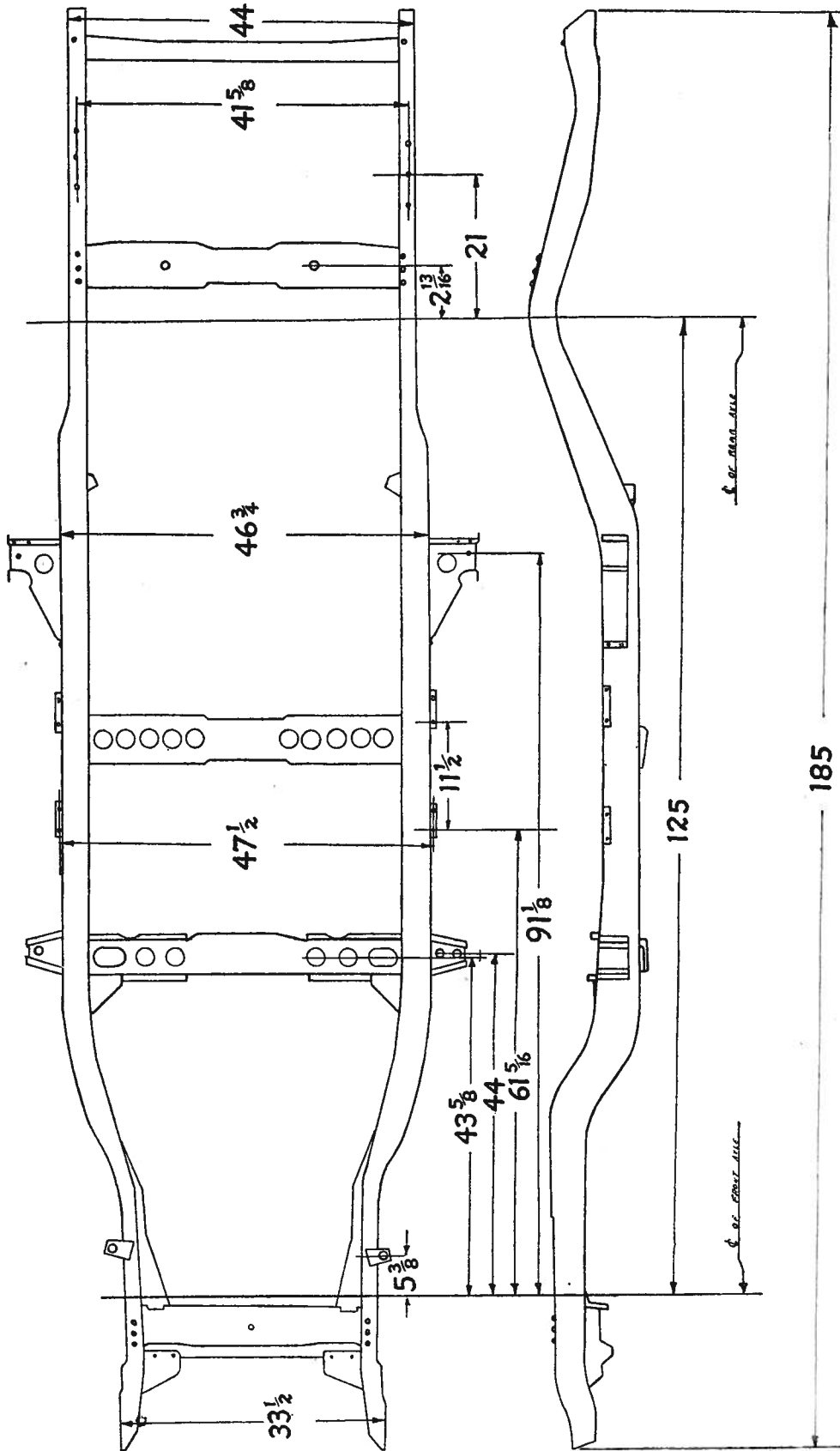

1946-1948 Continental Coupe Frame

FRAME 1946 to 1948 LINCOLN and CONTINENTAL
Series 66H, 76H, 876H. ALL BODY STYLES

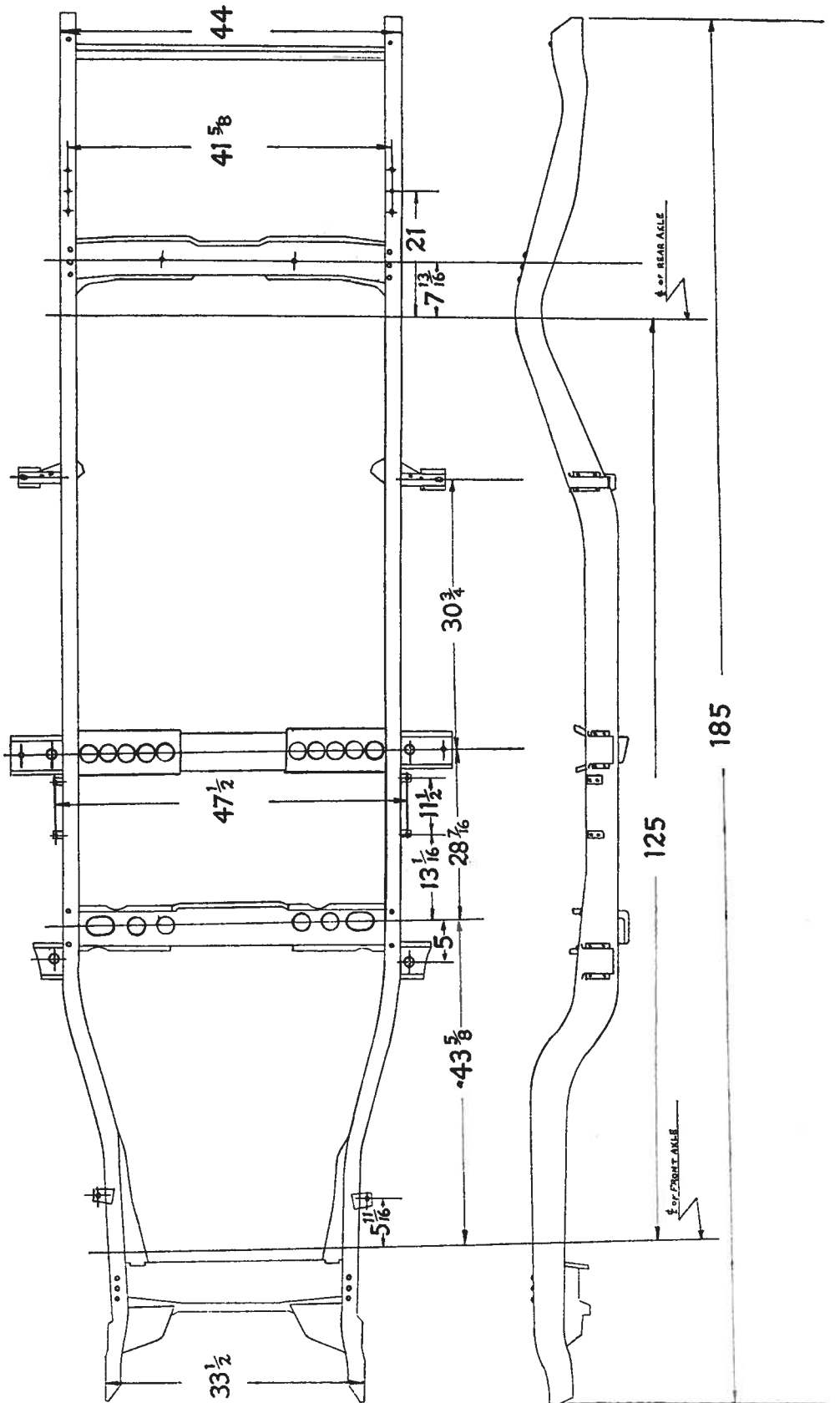

1946-1948 Lincoln Sedan Frame

LINCOLN and CONTINENTAL 1946 to 1948 FRAME

Series 66H, 76H, 876H. ALL BODY STYLES

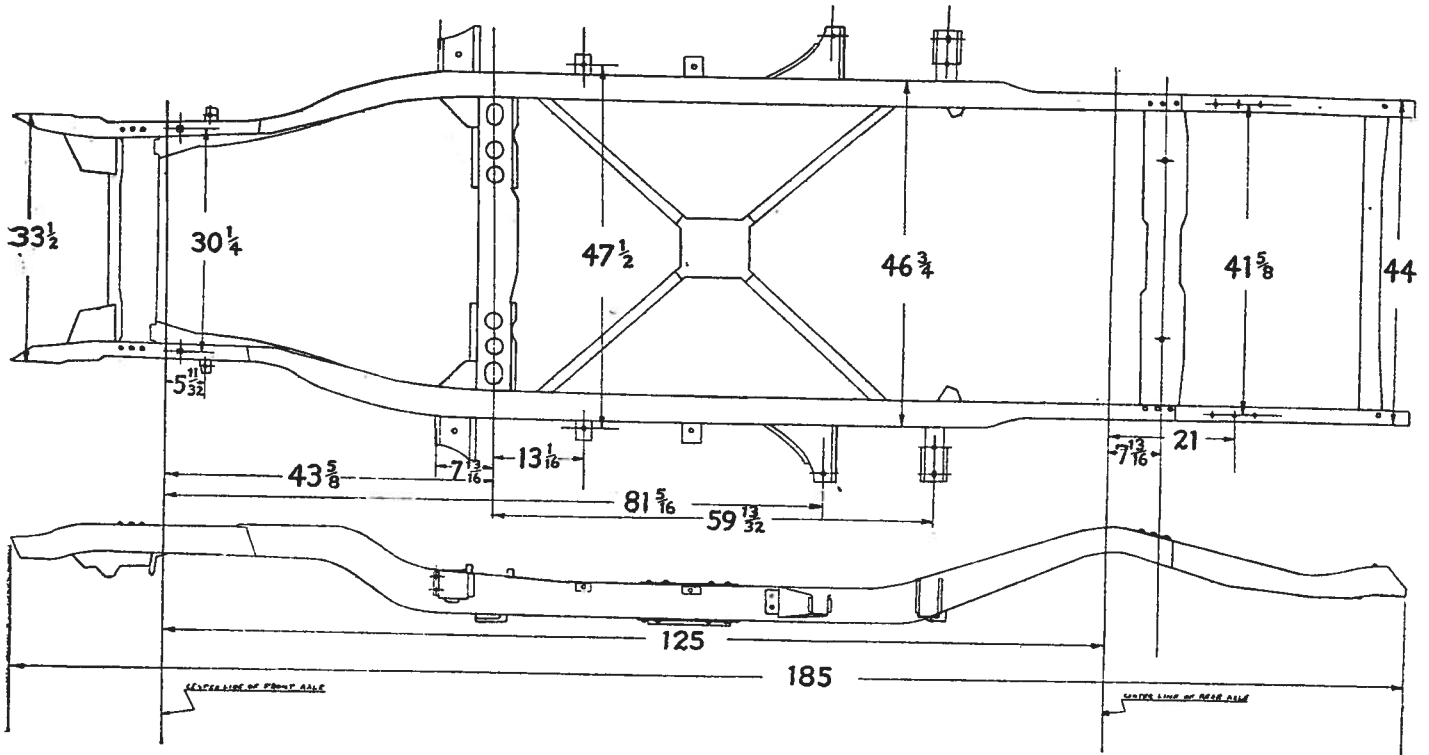

1946-1948 Lincoln Convertible

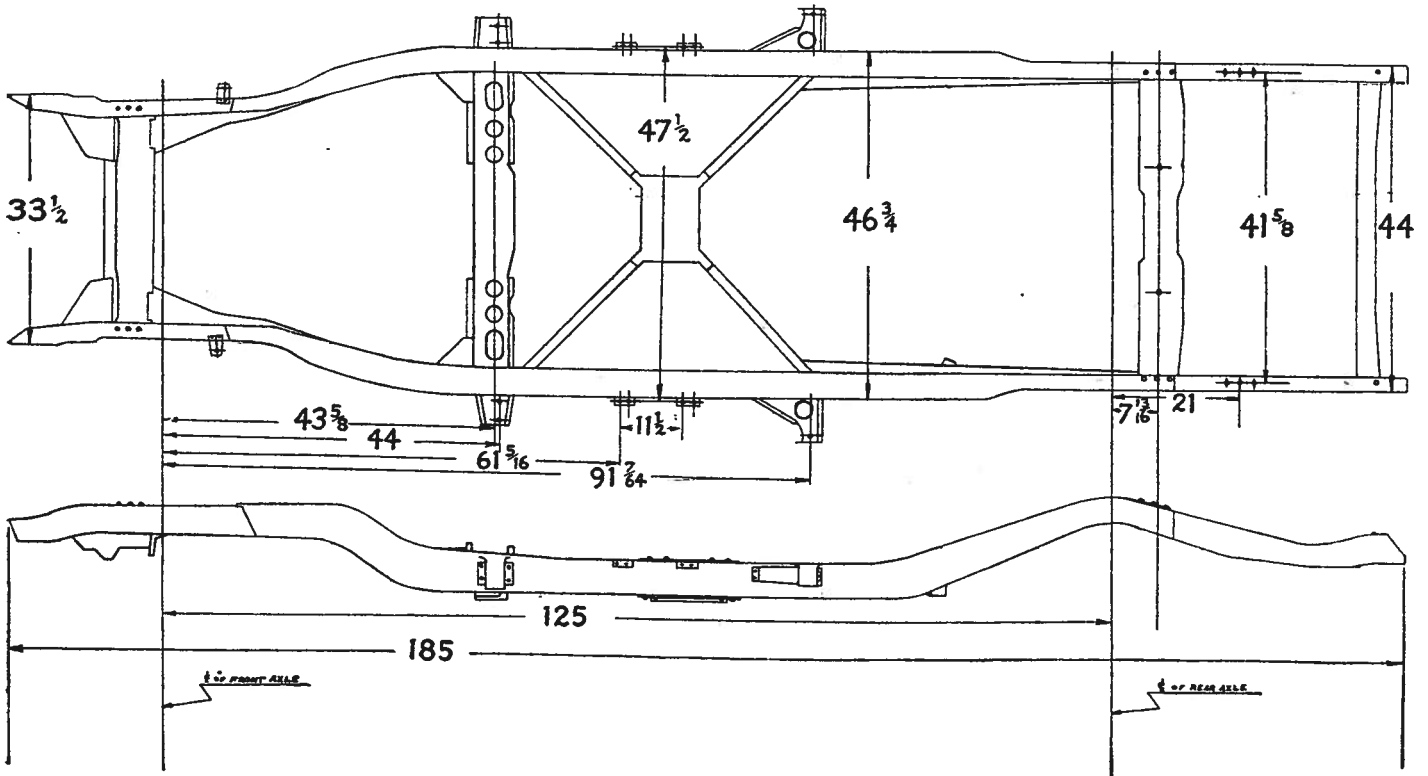

1946-1948 Continental Cabriolet

FLAT RATE 1946 to 1948 LINCOLN and CONTINENTAL

Series 66H, 76H, 876H. ALL BODY STYLES

Chilton Job No.	Chilton Labor Price	Chilton Job No.	Chilton Labor Price	Chilton Job No.	Chilton Labor Price	Chilton Job No.	Chilton Labor Price	Chilton Job No.	Chilton Labor Price	Chilton Job No.	Chilton Labor Price	Chilton Job No.	Chilton Labor Price	Chilton Job No.	Chilton Labor Price
A		A—continued		A—continued		B—continued		C—continued		C—continued		E		E—continued	
1	2.75	7	2.00	20x	8.00	9	2.00	2	28.00	15	1.25	1	65.00	11	50.00
2	1.75	8	1.25			10	3.75	3	24.00			2	30.00	12	25.00
3		9	4.50			11	3.75	4	1.75			3	25.00	13	1.75
4	18.50	10				12	4.25	5	3.50			4	24.00	14	125.00
4a		11	3.00	B		13	2.00	6	2.00	D		5	116.00	15	116.00
4b	2.00	12	4.50	1	8.50	14	3.50	7	2.00	1	3.50	6	2.00	16	2.00
4c	6.00	13	1.50	1a	7.00	15	1.25	8	3.25	1a	2.75	7	15.50	17	15.00
5		14		2	30.00			9		2	2.00	7x		18	15.00
5a		15	.75	3	25.00			10		3		8		19	15.00
5b		16		4	2.00			11		4	12.00	9	80.00	10	
5c		17	1.50	5	3.50			12	3.75	5	15.50	10x	82.00	11	
5d		18	15.00	6	2.00	C		13	4.25	6	8.00	11x	82.00	12	
6	25.00	19		7	2.00	1	8.50	14	3.50	7	8.00	12x	82.00	13	
		20		8	3.25	1a	5.50			18	3.00	13x	82.00	14	3.50
										20		14x	82.00		

STEERING GEOMETRY

CASTER: 5 degree max., 3 degree min., 1/2 degree variation.

CAMBER: 3/4 degree max., 1/4 degree min., 1/4 degree variation.

TOE-IN: 1/16 inches.

KING PIN INCLINATION: 5 1/4 degree max., 4 degree min.

Adjustment for camber is by bending axle.

Caster may be adjusted by twisting the axle, radius rod or both.

