

FORD 1949 BODY PARTS

Models 8BA, 8HA. ALL BODY STYLES

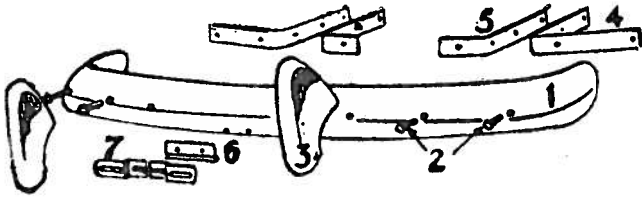

FRONT BUMPER
ALL MODELS

Item Part No.	Description	Price	Item Part No.	Description	Price
1 8A-17757	Impact bar	20.00	7 8A-17736	Brkt. (mtf.)	.48
2 8A-17758	Bolt assy.	.60	8BA-17744	Deflector (stone)	8 cyl. 6.08
3 8A-17897-A	Guard assy.	3.50	8HA-17744	Deflector (stone)	6 cyl. 6.08
4 8A-17756	Arm (outer)	1.60			
5 8A-17767	Arm (inner)	1.30			
6 8A-17751	Guide (brkt.)	.30			

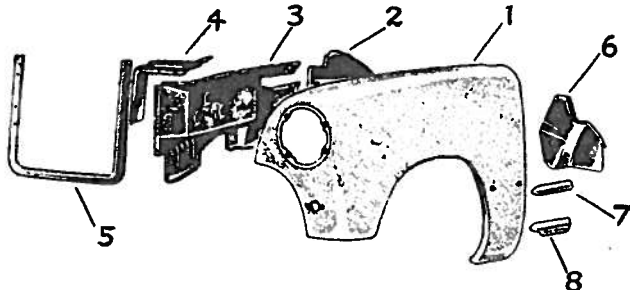

FRONT FENDER
ALL MODELS

Item Part No.	Description	Price	Item Part No.	Description	Price
1 8A-16086-A	Fender assy.	20.50	5 8A-16139	Support (apron)	1.70
2 8A-16033	Panel (apron splash)	1.50	6 8A-16173	Shield	.60
3 8A-16055	Apron assy.	7.75	7 8A-16004	Mldg.	.55
4 8A-16143	Reinforcement	.50	8 8A-16189-A	Ornament assy.	.90

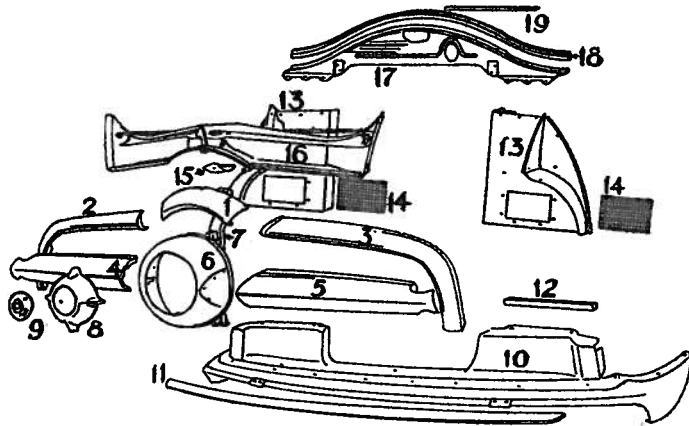

GRILLE
ALL MODELS

Item Part No.	Description	Price	Item Part No.	Description	Price
1 8A-8214-A	Center panel	1.75	12 8M-16070-A	Anti-Squeak	.80 yd.
2 8A-8242-A	Panel (right)	4.35	13 8A-8104	Panel assy. (right)	1.10
3 8A-8243-A	Panel (left)	4.35	13 8A-8105	Panel assy. (left)	1.10
4 8A-8150-B	Bar (right)	5.00	14 8A-8717	Screen	.50
5 8A-8151-B	Bar (left)	5.00	15 7A-8331	Plate (hood lock guide)	.50
6 8A-8217-B	Ring	6.00	16 8A-8162	Plate (hood lock & catching)	4.90
7 8A-8232-A	Brkt.	.60	17 8BA-8327	Deflector (rad. center air) (V8)	1.15
8 8A-8216-B	Center ornament	2.50	17 8HA-8327	Deflector (rad. center air) (6)	.80
9 8BA-8218	Medallion (8 cyl.)	.85	18 8BA-8344-A	Sealer (V8)	.85
9 8HA-8218	Medallion (6 cyl.)	.75	18 8HA-8344-A	Sealer (6)	.80
10 8BA-17744	Stone deflector (V8)	6.05	19 8BA-8349	Sealer (V8)	.15
10 8HA-17744	Stone deflector (6)	6.06			
11 8A-17819	Molding	2.10			

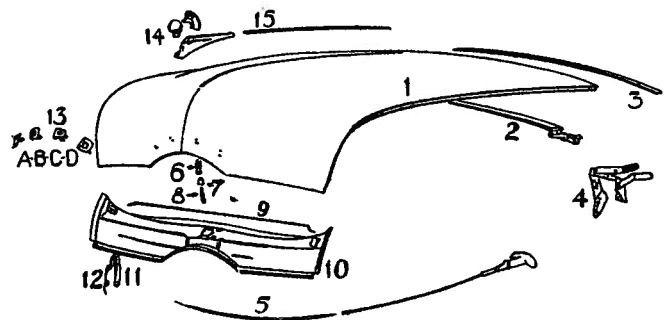

HOOD
ALL MODELS

Item Part No.	Description	Price	Item Part No.	Description	Price
1 8A-16611	Hood assy.	25.00	10 8A-8162	Panel (hood catch & locking)	4.90
2 8A-16668	Reinforcement (rear)	2.90	11 8A-16896-A	Hook	.50
3 8A-16740-B	Pad (on cowl)	.30	12 11A-16897-B	Spring	.05
4 8A-16797	Link & brkt. assy. (hood hinge)	2.15	13 8A-16806-A	Letter "F"	.30
5 8M-16916	Cable assy.	.05	13 8A-16806-B	Letter "O"	.30
6 11A-16925	Spring	.25	13 8A-16806-C	Letter "R"	.30
7 11A-16927	Guide	.08	13 8A-16806-D	Letter "D"	.30
8 11A-16929	Dowl	.08	14 8A-16850	Ornament assy.	3.35
9 8A-16826	Rod	.40	15 8A-16736	Molding (center)	.75

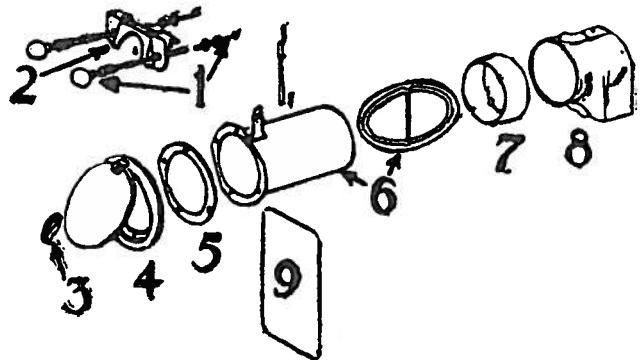

VENTILATING SYSTEM
ALL MODELS

Item Part No.	Description	Price	Item Part No.	Description	Price
1 8A-7001891-A	Control assy. (plastic knob) Ford	.95	4 8A-7001814	Register assy.	1.35
1 8A-7001891-B	Control assy. (chrome) custom	1.15	5 8A-7001880	Gasket (rubber)	.10
2 8A-7001938-AP	Brkt. (control)	.40	6 8A-7001851-A	Valve assy.	2.45
3 8A-7001844	Handle (reg. dr.)	.15	7 8A-7001878	Connector	.20
			8 8A-7001903	Duct assy. (rear)	1.35
			9 8A-7001846-B	Plate (cover)

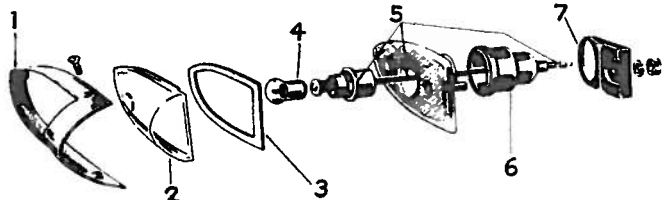

PARKING LAMP
ALL MODELS

Item Part No.	Description	Price	Item Part No.	Description	Price
8A-13201	Lamp assy.	3.85	4 B-13466	Bulb	.10
1 8A-13237	Door	1.10	5 8A-13234-A	Wire assy.	.95
2 8A-13209	Lens	.30	6 8A-13225	Boot	.10
3 8A-13211	Gasket	.17	7 8A-13217	Pad

BODY PARTS 1949 FORD

Models 8BA, 8HA. ALL BODY STYLES

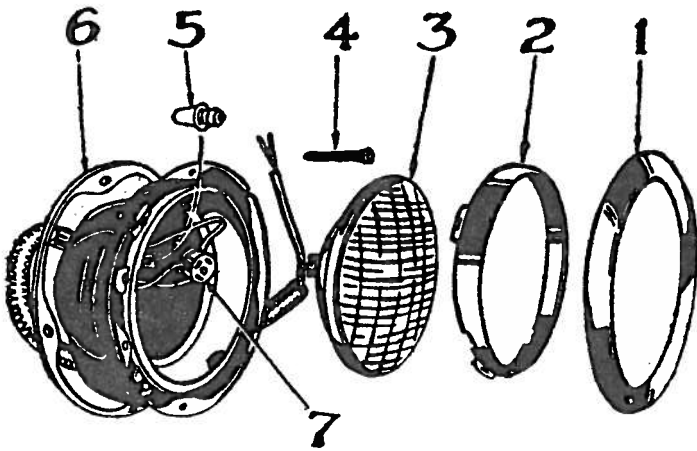

HEADLAMP ALL MODELS

Item Part No.	Description	Price	Item Part No.	Description	Price
8C-13002-B	Headlamp assy., less bulb	5.50	4 11A-13032-Adj. screw	.06	
1 7RA-13045-Door	1.25	5 51A-13091-B-Grommet	.05		
2 11A-13018-A-Ring	.55	6 11A-13044-A-Gasket	.30		
3 09A-13007-Bulb	1.30	7 51C-13076-B-Wiring assy.	1.00		

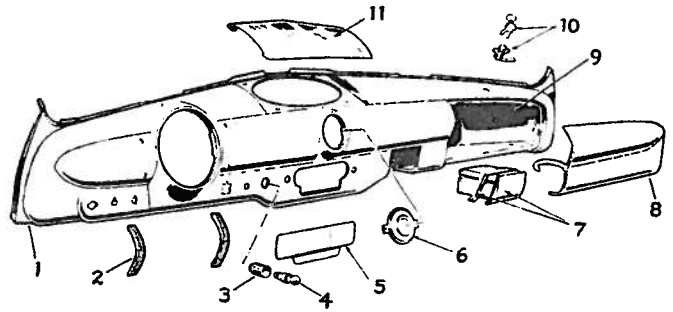

INSTRUMENT PANEL ALL MODELS

Item Part No.	Description	Price	Item Part No.	Description	Price
1 8A-7004320-DP-Panel (inst.) 70, 72, 73, 76	14.00	5 8A-7904370-A3-Pit. assy. (radio cover) 79	.50		
1 8A-7904320-Panel (inst.) 79	15.50	6 8A-7004428-B-Medallion, 70A, 72A, 72C, 73A	.40		
2 8A-7004687-A-Midg., 70B, 72B, 73B, 76	.35	7 8A-7004800-AP-Ash receptacle (prime) 70, 72, 73, 76	1.90		
2 8A-7904687-Midg., 79	1.60	7 8A-7904800-A-Ash receptacle (maple) 79	1.20		
3 8A-7004620-B-Cigar lighter tube	1.25	8 8A-7008024-AP-Door (w/hinge) 70, 72, 73, 75	2.70		
4 8A-7004610-A-Element & knob	1.35	8 8A-7008024-AF-Door (w/hinge) 79	2.70		
5 8A-7004370-A3-Pit. assy. (radio cover) 70A, 72A, 72C, 73A	.70	9 8A-7006010-B-Compartment	.80		
5 8A-7004370-B3-Pit. assy. (radio cover) 70B, 72B, 73B	.50	10 8A-7006081-B-Lock assy.	1.60		
5 8A-7604370-A3-Pit. assy. (radio cover) 76	.50	11 8A-7004405-P2-Grille (radio)	.65		
		11 8A-7904405-Grille (radio) 79	1.70		
		8A-7904433-Support assy. (rad. speaker) 79	.60		

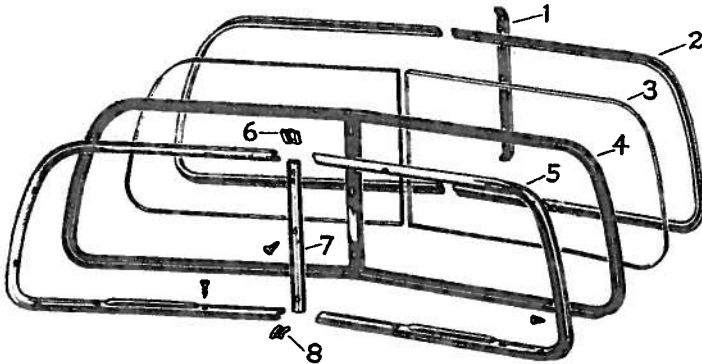

WINDSHIELD ALL MODELS

Item Part No.	Description	Price	Item Part No.	Description	Price
1 8A-7003078-B-Retainer assy. (outer) 72A, 72C, 73A pointed	1.75	5 8A-7603591-C-Strip (finish) use with red trim 76	1.60		
1 8A-7003078-B-Retainer assy. (outer) 70B, 72B, 73B	1.75	5 8A-7903591-Strip (finish) 79	1.80		
1 8A-7603078-Retainer assy. (outer) 76	1.65	6 8A-7003084-A-Plate (inside upper) 70A, 72A, 72C, 73A	.10		
1 8A-7903078-Retainer assy. (outer) 79	1.50	6 8A-7003084-B-Plate (inside upper) 70B, 72B, 73B	.10		
2 8A-7003089-B-Midg (finish) outside, 70B, 72B, 73B	1.50	6 8A-7603084-A-Plate (inside upper) w/green trim 76	.80		
2 8A-7603089-B-Midg (finish) outside, 76	1.60	6 8A-7603084-B-Plate (inside upper) w/tan trim 76	.12		
2 8A-7903089-Midg. (finish) outside, 79	1.65	6 8A-7603084-C-Plate (inside upper) w/red trim 76	.12		
3 8A-7003100-Glass 70, 72, 73	11.80	6 8M-7903084-Plate (inside upper) 79	.25		
3 8A-7603100-Glass 76	11.80	7 8A-7003076-A-Retainer (inner) 70A, 72A	..		
3 8A-7903100-Glass 79	11.80	7 8A-7003076-B-Retainer (inner) 70B, 72B, 73B	..		
4 8A-7003110-B-Wthstp 70, 72, 73	5.00	7 8A-7903076-Retainer (inner) 79	.50		
4 8A-7603110-B-Wthstp 76	5.00	8 8A-7003086-A-Plate (lower) 70A, 72A, 72C, 73A	.12		
4 8A-7903111-A-Wthstp 79	4.60	8 8A-7003086-B-Plate (lower) 70B, 72B, 73B	.12		
5 8A-7003591-A-Strip (finish) 70A, 72A, 72C, 73A	..	8 8A-7603086-A-Plate (lower) green trim, 76	.10		
5 8A-7003591-B-Strip (finish) 70B, 72B, 73B	..	8 8A-7603086-B-Plate (lower) tan trim 76	.10		
5 8A-7603591-A-Strip (finish) use with green trim 76	3.10	8 8A-7603086-C-Plate (lower) red trim 76	.10		
5 8A-7603591-B-Strip (finish) use with tan trim 76	1.60				

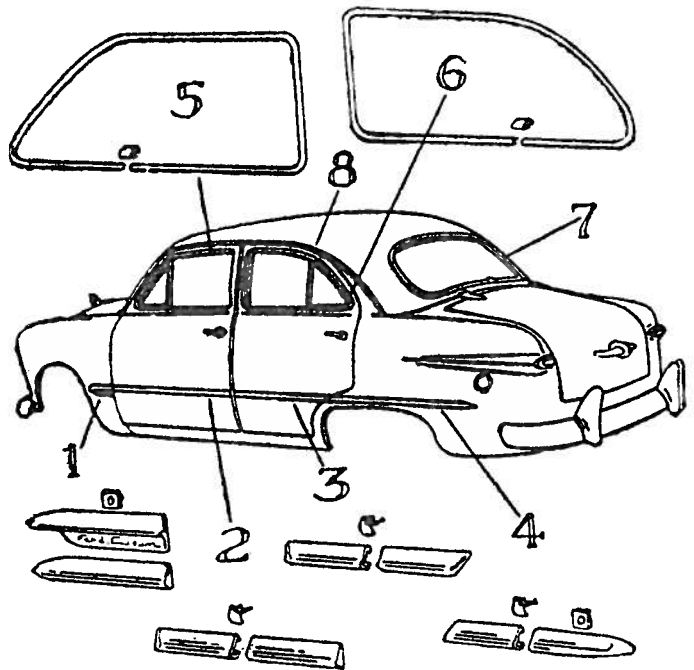

OUTSIDE MOULDING TRIM ALL MODELS

Item Part No.	Description	Price	Item Part No.	Description	Price
1 8A-16189-A-Frt. fender, 70, 72, 73, 76 custom	.90	5 8A-7020985-B-Reveal (wind.) frt., 70, 72	2.25		
1 8A-16004-Frt. fender	.55	5 8A-7320985-B-Reveal (wind.) frt., 73	2.00		
1 8A-16189-B-Frt. fender, 79	1.35	6 8A-7325589-A-Reveal (wind.) R., 73	2.30		
2 8A-7020939-Frt. door, 70, 72, 76	1.25	7 8A-7042430-B-Reveal (back wind.) 70B, 72B, 73B	1.95		
2 8A-7320939-Frt. door, 73	1.00	8 8A-7051701-Drip (roof) 70, 73	.80		
3 8A-7325557-R. door, 73	1.00	8 8A-7251701-Drip (roof) 72	1.40		
4 8A-7029039-R. fender, 70, 72, 76	1.70				
4 8A-7329039-R. fender, 73	1.50				

FORD 1949 BODY PARTS

Models 8BA, 8HA. ALL BODY STYLES

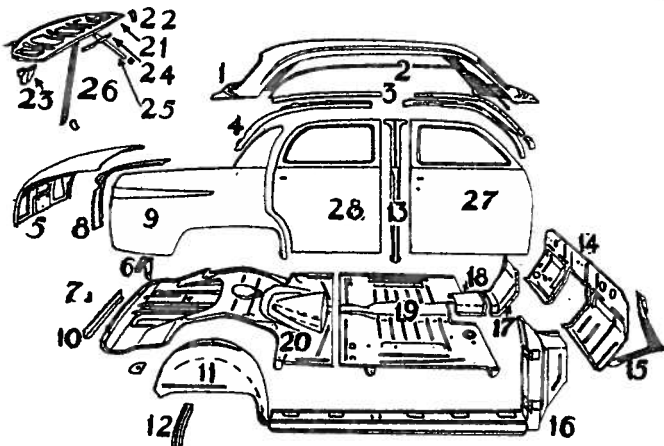

CAR BODY

BODY STYLES — 73A — FORDOR SEDAN
73B — SUPER DELUXE FORDOR SEDAN

Item Part No.	Description	Price	Item Part No.	Description	Price
1	8A-7050026-B—Panel & silencer assy.	58.80	8A-7052101—Support No. 1 (hd. lining)		.30

Item Part No.	Description	Price	Item Part No.	Description	Price
8A-7052102—Support No. 2 (hd. lining)		.30	12	8-7044823—Reinforcement (upper luggage)	.30
8A-7052103—Support No. 3 (hd. lining)		.30	13	8A-7324301—Pillar assy. (center)	7.50
8A-7052104—Support No. 4 (hd. lining)		.30	14	8A-7001605—Dash panel	3.00
8A-7352105—Support No. 5 (hd. lining)		.30	15	8A-7001791—Brace & sup. assy. (dash to fr.)	1.85
8A-7350953—Strip (hd. lining rot)		.40	16	8A-7302043—Panel assy. (cowl & side rocker)	13.75
2	8A-7051701—Drip midg.	.80	17	8A-7012115—Plate (trans. cover), frt.	1.60
3	8A-7051197—Reinforcement (frt. rail)	.35	18	8A-7012120—Plate (trans. cover), R.	.95
3	8A-7351201—Reinforcement (r. rail)	.70	19	8A-7011135—Pan assy. (frt. fl.)	
3	8A-7003587—Gusset	.40	20	8A-7011215-B—Pan assy. (R. fl.)	21.30
4	8A-7051184—Side rail	3.00	21	8A-7046506—Panel (pkg. tray)	4.00
5	8A-7040110—Lid assy. (trunk) w/lock	36.00	22	8A-7346577-B—Gusset, L.H.	.15
6	8A-7047070—Brkt. (spare whl.)	.70	23	8A-7346576-B—Gusset, R.H.	.15
7	8A-7044831—Gusset	.15	24	7A-7046518—Reinforcement (frt.)	1.90
8	8A-7027945-B—Extension (qt. panel)	2.90	25	8A-7048611—Strainer, L.H.	.50
9	8A-7327841-D—Panel (R. qt. & side)	43.20	26	8A-7048610—Strainer, R.H.	.50
8A-7627847-C—Panel (R. fender repair) B. type		12.00	27	8A-7320123—Door assy. (frt., less paint, trim & wind reg.)	45.00
10	8A-7040324—Panel (lower back)	2.20	28	8A-7324623—Door assy. (R., less paint, trim & wind reg.)	45.00
11	8A-7027883—Panel assy. (R. qt. whl. house)	6.45			

CAR BODY

BODY TYPES—70A—TUDOR SEDAN. 70B—CUSTOM TUDOR SEDAN.
72A—CLUB COUPE. 72B—CUSTOM CLUB COUPE. 72C—BUSINESS COUPE

Item Part No.	Description	Price	Item Part No.	Description	Price
1	8A-7050026-B—Roof panel & silencer assy., 70.	58.80	8A-7029053-B—Midg. (qt. p. to qt. p. ext.) upper 70.	.60	
1	8A-7250026-B—Roof panel & silencer assy., 72.	58.80	8A-7229053-B—Midg. (qt. p. to qt. p. ext.) upper 72.	.65	
8A-7052101—Support No. 1 (hd. lining)		.30	8A-7029081-B—Midg. (qt. p. to qt. p. ext.) lower.	.20	
8A-7052102—Support No. 2 (hd. lining)		.30	8	8A-7040110—Lid assy. (trunk) w/lock	36.00
8A-7052103—Support No. 3 (hd. lining) 70.		.30	9	8A-7044823—Reinforcement (upper)	.30
8A-7252103—Support No. 3 (hd. lining) 72.		.35	10	8A-7040324—Panel (low back)	2.20
8A-7052104—Support No. 4 (hd. lining) 70.		.30	11	8A-7027883—Panel (R. qt. whl. house)	6.45
8A-7252104—Support No. 4 (hd. lining) 72.		.35	12	8A-7047070—Brkt. (spare whl. mtg.)	.70
8A-7052105—Support No. 5 (hd. lining) 70.		.30	13	8A-7002043—Panel (cowl side & rocker)	9.75
2	8A-7051701—Drip midg., 70	.80	14	8A-7001605—Dash panel	3.00
2	8A-7251701—Drip midg., 72	1.40	15	8A-7001791—Brace & sup. (dash to fr.)	1.85
3	8A-7051197—Reinforcement.	.35	16	8A-7046506—Panel assy. (pkg. tray) 70.	4.00
4	8A-7003587—Gusset	.40	16	8A-7246506—Panel assy. (pkg. tray) 72A, 72B.	
5	8A-7051185—Side rail	3.00	17	8A-7046577-B—Gusset, L.H., 70	.20
8A-7050953—Strip (hd. lining ret.)		.30	17	8A-7246577—Gusset, L.H., 72	.15
6	8A-7027841-E—Panel (r. qt. & side) 70.	43.20	18	8A-7046576-B—Gusset, R.H., 70	.20
6	8A-7227841-D—Panel (r. qt. & side) 72.	43.20	18	8A-7246576—Gusset, R.H., 72	.15
8A-7627847-C—Panel (R. fender repair) BF type		12.00	19	8A-7046611—Strainer, L.H., 70	.50
8A-7029039—Midg. (qt. outside)		1.70	19	8A-7246611—Strainer, L.H., 72	.80
7	8A-7027945-B—Extension (qt. panel)	2.90			

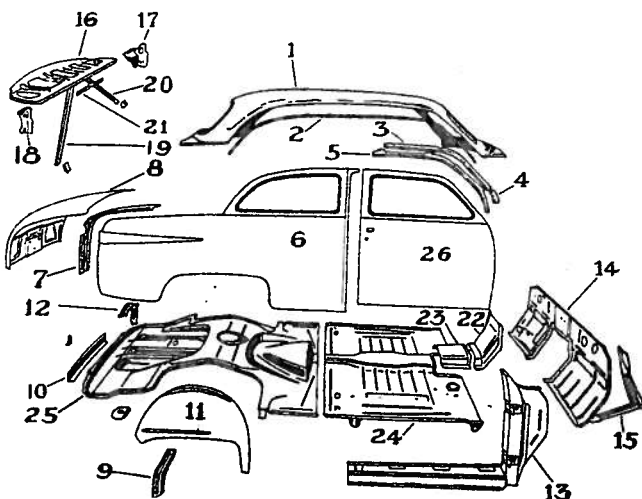

Item Part No.	Description	Price	Item Part No.	Description	Price
20	8A-7048610—Strainer, R.H., 70	.50	23	8A-7012120—Trans. cover plt. (R.)	.95
20	8A-7246610—Strainer, R.H., 72	.60	24	8A-7011135—Pan (frt. fl.)	
21	7A-7046516—Reinforcement (frt.)	1.90	25	8A-7011215-B—Pan (R. fl.)	21.30
22	8A-7012115—Trans. cover plt. (frt.)	1.60	26	8A-7020123—Door (less paint, trim & wind reg.)	50.40

CAR BODY

BODY TYPE—76 CONVERTIBLE

Item Part No.	Description	Price	Item Part No.	Description	Price
1	8A-7600120—Front assy.	60.00	9	8A-7040324—Panel (lower back)	2.20
2	8A-7001791—Brace & sup. assy. (dash to fr.)	1.85	10	8A-7012125-B—Pan assy. (R. floor)	21.30
3	8A-7003587—Gusset (windshield to pillar)	.40	11	8A-7611135—Pan assy. (fr. floor)	14.50
4	8A-7627841-D—Panel assy. (qt. & side)	43.20	12	8A-7012120—Trans. cover plt., R.	.95
8A-7627847-C—Panel (R. fender repair)		12.00	13	8A-7012115—Trans. cover plt., frt.	1.60
5	8A-7640310-B—Panel assy. (upper back)	9.00	14	8A-7020031—Reinforcement (front)	1.45
6	8A-7040110—Lid assy. (luggage) w/lock	36.00	14	8A-7020033—Reinforcement (rear)	.95
7	8A-7047070—Brkt. (spare whl.)	.70	15	8A-7010131—Rocker panel	2.35
8	8A-7044831—Gusset (trunk opening to fl.)	.15	16	8A-7620123—Door assy. (less paint, trim & reg.)	54.00

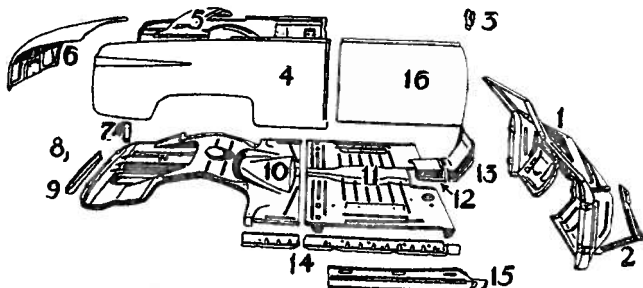

BODY PARTS 1949 FORD

Models 8BA, 8HA. ALL BODY STYLES

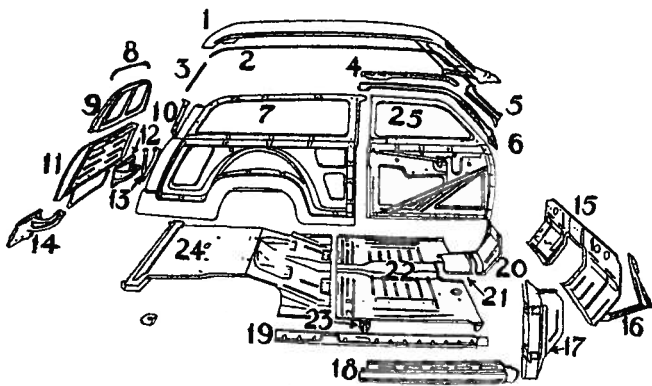

CAR BODY

STATION WAGON

Item Part No.	Description	Price
1	8A-7950026—Roof panel	114.00
2	8A-7951711—Drip midg. (front)	1.10
3	7A-7951716—Drip midg. (rear)	.20
4	8M-7951191—Reinforcement rail) frt.	1.70
5	8A-7903619—Extension (windshield)	1.85
6	8A-7951185—Side rail (roof)	40.70
7	8M-7927841—Panel (qt. & slide)
8	7A-7951704—Drip midg. (roof) rear	1.75
9	8M-7942002-A—Window assy. (back) less trim	57.50
10	7A-7942059—Support (window)	.75
11	8A-7940700—Gate assy. (tail)
12	8M-7940321—Panel assy. (L.P. body)	4.85

BODY TYPE-79

Item Part No.	Description	Price
13	8M-7944401—Rod (gate sup.)
14	8M-7940321—Panel (low. R. body)	4.85
15	8A-7001605—Dash panel	3.00
16	8A-7001791—Sup. & brace assy. (dash to fr.)	1.85
17	8A-7902043—Panel (cowl fr. pil. & rocker)
18	8A-7910131—Panel (rocker)	7.25
19	8A-7920031—Reinforcement	2.00
20	8A-7012115—Trans. cover pit. (front)	1.60
21	8A-7012120—Trans. cover pit. (rear)	.95
22	8A-7911135—Pan assy. (frt.)	12.10
23	8A-7910698—Cross member
24	8A-7911215—Pan assy. (rear)
25	8A-7920123—Door assy. (less paint, trim & reg.)	48.00

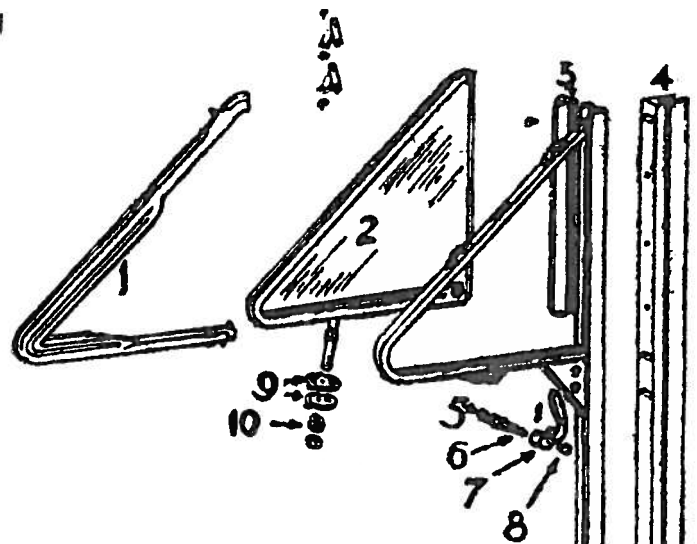

FRONT WINDOW VENTILATOR

BODY TYPES — 70A — TUDOR SEDAN. 70B—CUSTOM TUDOR SEDAN. 72A—CLUB COUPE. 72B—CUSTOM CLUB COUPE. 72C—BUSINESS COUPE. 73A—FORDOR SEDAN. 73B—CUSTOM FORDOR SEDAN

Item Part No.	Description	Price	Item Part No.	Description	Price
8A-7021403	—Assembly (complete)	21.00	5	01A-7022920—Key (handle locking)	.12
1	8A-7021449-A—Wthstp. (frt.)	1.00	6	01A-7022986—Spring	.02
2	8A-7021412-A—Glass	2.45	7	8A-7022917—Handle	.50
3	8A-7021451-B—Wthstp. (div. bar)	.25	8	01A-7022984—Button	.02
4	8A-7021546-A—Run	.50	9	8A-7022993—Stop	.06
			10	01A-7022926—Spring	.50

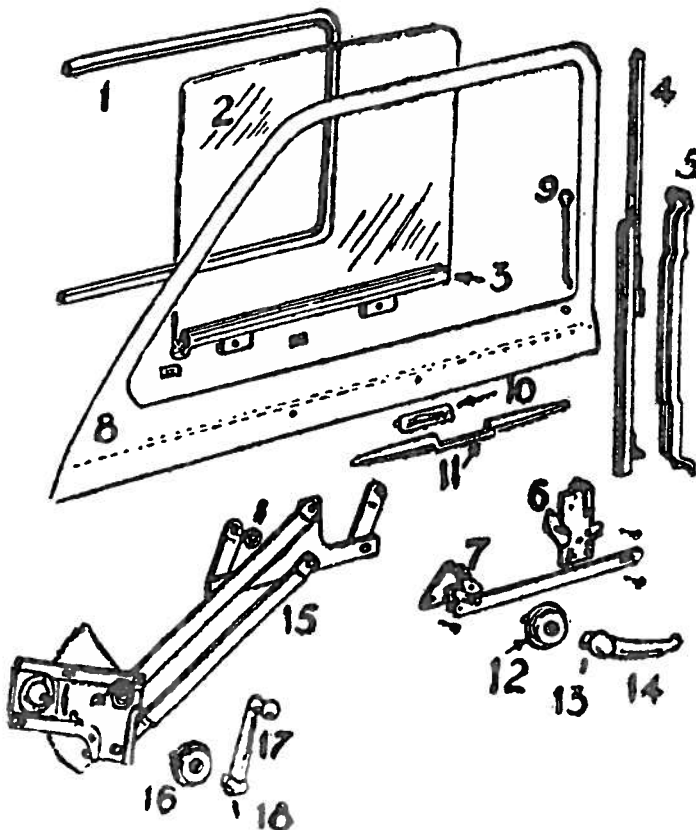

FRONT DOORS

BODY TYPES — 70A — TUDOR SEDAN. 70B—CUSTOM TUDOR SEDAN. 72A—CLUB COUPE. 72B—CUSTOM CLUB COUPE. 72C—BUSINESS COUPE

Item Part No.	Description	Price	Item Part No.	Description	Price
1	8A-7021453-A—Wthstp. (in.)	.85	11	8A-7020946—Retainer (insert)	.60
2	8A-7021410-A—Glass	6.85	12	8A-7022618-A—Escutcheon, 70A, 72A, 72C	.28
3	8A-7021459-A—Channel & ret. assy.	.60	12	8A-7022618-B—Escutcheon, 70B, 72B	.31
4	8A-7021546-A—Run (hinge side)	.50	13	8A-7023354-B—Pin
4	8A-7021550—Run (lock side)	.55	14	8A-7022614—Handle, inside	.95
5	8A-7021573-B—Retainer (lock side)	.40	15	8A-7023201—Regulator	3.60
5	8A-7021813—Lock	2.95	16	8A-7022618-A—Escutcheon, 70A, 72A, 72C	.28
7	8A-7021819-B—Control & link	1.10	16	8A-7022618-B—Escutcheon, 70B, 72B	.31
8	8A-7020905-A—Strip (finish) 70A, 72A, 72C	17	8A-7023342-C—Handle (reg.) 70B, 72B	1.10
8	8A-7020905-B—Strip (finish) 70B, 72B	17	8A-7023342-D—Handle (reg.) 70A, 72A, 72C	.85
9	8A-7021850—Knob	.25	18	8H-7023354-B—Pin
10	8A-7020989-A—Insert (finish strip)	.70			

FORD 1949 BODY PARTS

Models 8BA, 8HA. ALL BODY STYLES

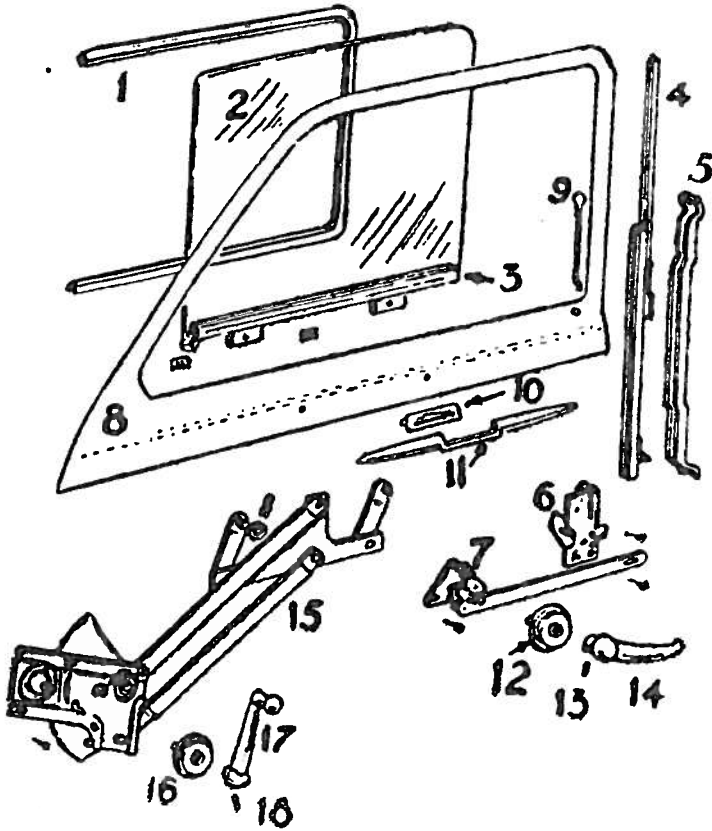

FRONT DOORS

BODY TYPES — 73A — FORDOR SEDAN, 73B—CUSTOM FORDOR SEDAN

Item Part No.	Description	Price	Item Part No.	Description	Price
1	8A-7321453-A—Wthstp. (In.)	.90	11	8A-7020946—Retainer (insert)	.60
2	8A-7321410-A—Glass	4.70	12	8A-7022618-A—Escutcheon, 73A	.28
3	8A-7321459-A—Channel & ret. assy.	.75	12	8A-7022618-B—Escutcheon, 73B	.31
4	8A-7021546-A—Run (hinge side)	.50	13	8A-7023354-B—Pin	.95
4	8A-7021550—Run (lock side)	.55	14	8A-7022614—Handle (inside)	3.60
5	8A-7021573-B—Retainer (lock side)	.40	15	8A-7323201—Regulator	3.60
6	8A-7021813—Lock	2.95	16	8A-7022618-A—Escutcheon, 73A	.28
7	8A-7321819-B—Control & link	.90	16	8A-7022618-B—Escutcheon, 73B	.31
8	8A-7320905-A—Strip (finish) 73A	17	8A-7023342-C—Handle (reg.) 73B	1.10
8	8A-7320905-B—Strip (finish) 73B	17	8A-7023342-D—Handle (reg.) 73A	.85
9	8A-7021850—Knob	.25	18	8A-7023354-B—Pin
10	8A-7020989-A—Insert (finish strip)	.70			

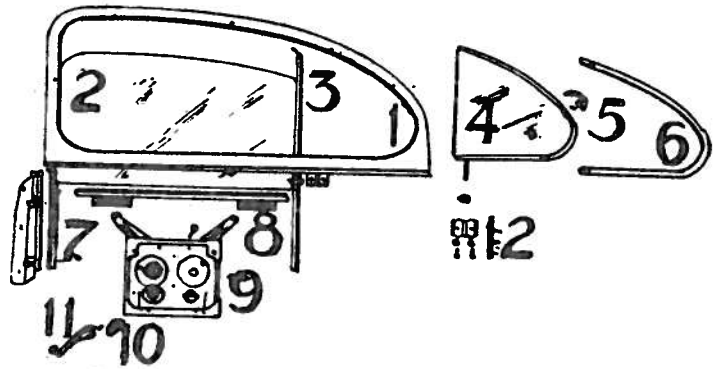

QUARTER WINDOW

BODY TYPE 70

Item Part No.	Description	Price	Item Part No.	Description	Price
1	8A-7029003-A—Fin. strp., 70A	..	6	8A-7030249-B—Wthstp, 70B	1.61
1	8A-7029003-B—Fin. strp., 70B	..	7	8A-7030102—Run assy.	.31
2	8A-7029710-A—Glass	5.65	8	8A-7029901-A—Channel assy.	.51
3	8A-7030235-A—Div. bar	2.00	9	8A-7030307—Regulator	3.61
4	8A-7030210-A—Glass assy., (vent) 70A	3.00	10	8A-7022618-A—Escutcheon 70A	.21
4	8A-7030210-B—Glass assy., (vent) 70B	2.45	10	8A-7022618-B—Escutcheon 70B	.31
5	78-736280—Handle, 70B	.35	11	8A-7023342-C—Handle, 70B	1.11
6	8A-7030249-A—Wthstp, 70A	1.65	11	8A-7023342-D—Handle, 70A	.81
			12	11A-7330548—Clamp 70B	.00

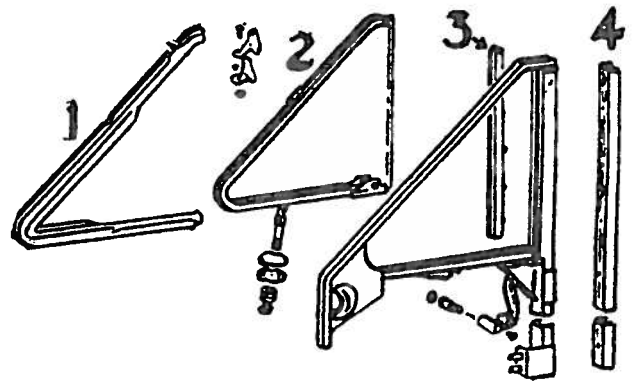

VENTILATOR WINDOW

BODY TYPE—76 CONVERTIBLE

Item Part No.	Description	Price	Item Part No.	Description	Price
1	8A-7621449—Wthstp.	2.00	3	8A-7621454-A—Wthstp. (rear)
2	8A-7621412-A—Glass	3.00	4	8A-7621547—Run	.71

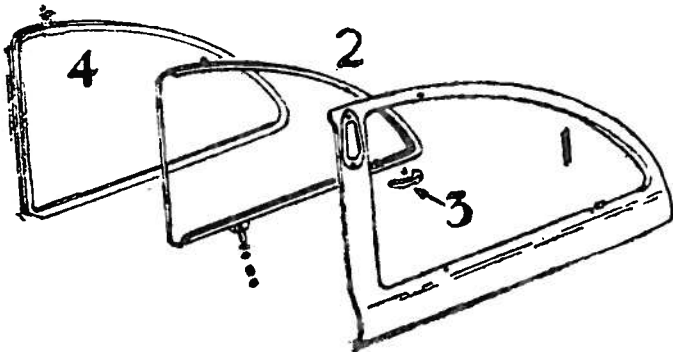

QUARTER WINDOW

BODY TYPE 72

Item Part No.	Description	Price	Item Part No.	Description	Price
	8A-7229701-B—Glass & frame assy. (complete), 72B	15.00	2	8A-7229710-B—Glass 72A, 72C	5.71
1	8A-7229003-A—Finish strip (green grey) 72A, 72C	3	78-735280—Handle (frame) 72B	.31
1	8A-7229003-C—Finish strip (grey) 72B	4	8A-7229905-A—Wthstp (stationary) 72A, 72C	1.71
2	8A-7229710-C—Glass 72B	5.15	4	8A-7229905-C—Wthstp (push-out) 72B	2.01

BODY PARTS 1949 FORD

Models 8BA, 8HA. ALL BODY STYLES

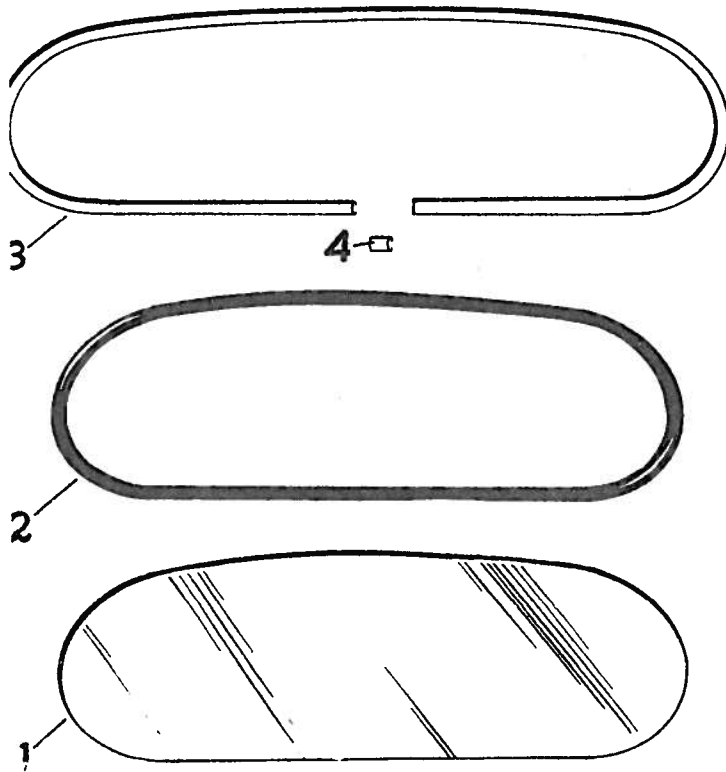

BACK WINDOWS ALL MODELS

Item Part No.	Description	Price	Item Part No.	Description	Price
1	8A-7042006—Glass assy., 70, 72, 73	15.55	2	8A-7042084-D—Wthstp. (rubber) 70B, 72B, 73B...	3.30
2	8A-7042084-E—Wthstp. (rubber) 70A, 72A, 72C, 73A	3.30	3	8A-7042430-B—Midg. (outside) 70B, 72B, 73B	1.95
			4	8A-7042432-B—Cover (midg. jt.) 70B, 72B, 73B	.05

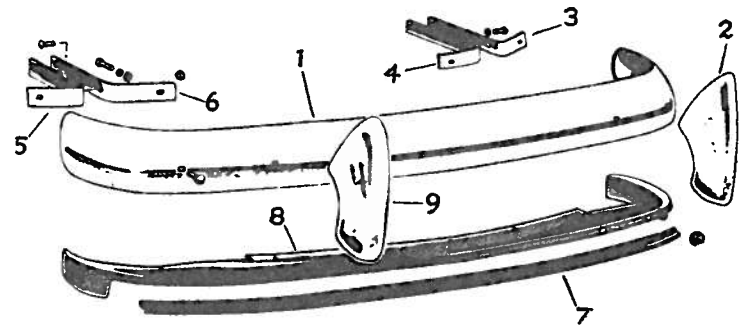

REAR BUMPER ALL MODELS

Item Part No.	Description	Price	Item Part No.	Description	Price
1	8A-17906—Impact bar	20.00	6	8A-17788-A—Arm (inner) LH	1.30
2	8A-17996-A—Guard assy. (LH)	3.50	7	8A-17832-A—Extension (rubber)
3	8A-17795-A—Arm (outer) RH	1.30	8	8A-17801—Deflector assy.
4	8A-17787-A—Arm (inner) RH	1.30	9	8A-17797-A—Guard assy. (RH)	3.50
5	8A-17796-A—Arm (outer) LH	1.80			

REAR LAMP—STATION WAGON

Item Part No.	Description	Price
8A-13402-A	Lamp assy. (w/bulb)	3.85
8A-13408	Body assy.	2.60
1 40-13448	Door	.35
2 40-13461	Gasket (outer)	.05
3 40-13450-A	Lens	.40
4 40-13460	Gasket (inner)	.12
5 13465	Bulb	.30
6 40-13447	Gasket	.06
7 40-13445	Lens	.25
8 B-13446	Retainer	.02

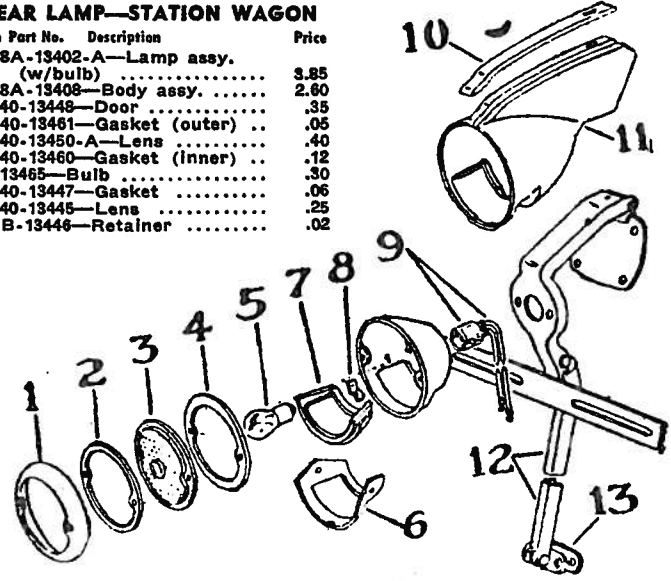

Item Part No.	Description	Price	Item Part No.	Description	Price
13408	Body	11	8A-13454—Shell assy.
9	8A-13410—Socket & wiring assy.	1.25	12	8M-13425—Hinge assy.	3.00
10	8A-13476—Midg.	.70	13	7A-13446—Gasket	.02

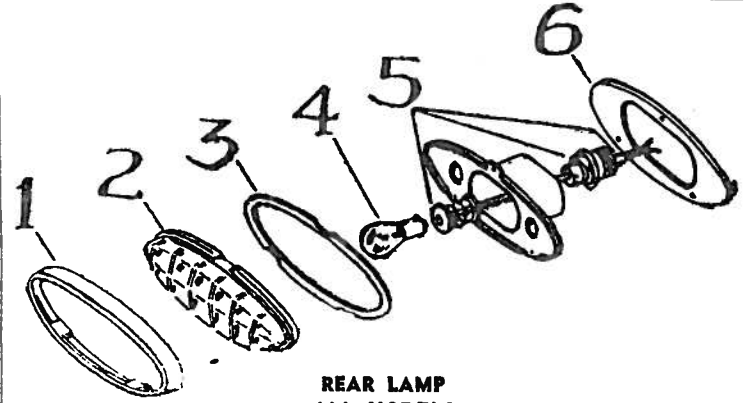

REAR LAMP ALL MODELS

Item Part No.	Description	Price	Item Part No.	Description	Price
8A-13404-A	Lamp assy.	3.50	4	11A-13465—Bulb	.29
1 8A-13448	Door	1.10	5	7E8H-13410—Socket & wire assy.	1.25
2 8A-13450-A	Lens	.45	3	8A-13461—Gasket	.07
3 8A-13461	Gasket	.07	6	8A-13420—Pad	.15

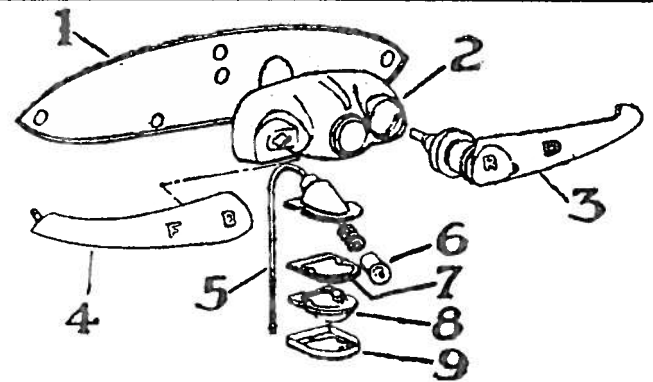

LICENSE PLATE LAMP (EXCEPT STATION WAGON)

Item Part No.	Description	Price	Item Part No.	Description	Price
7RA-13550	Lamp assy.	.85	5	7RA-13412—Wire assy.	.20
1 8A-13572-A	Pad	.85	6	B-13466—Bulb	.10
2 8A-13553	Body assy.	2.65	7	7RA-13568—Gasket	.05
3 7043500		3.75	8	7RA-13564—Lens	.15
4 7043525		1.40	9	7RA-13566—Door	.06

FORD 1949 BODY PARTS

Models 8BA, 8HA. ALL BODY STYLES

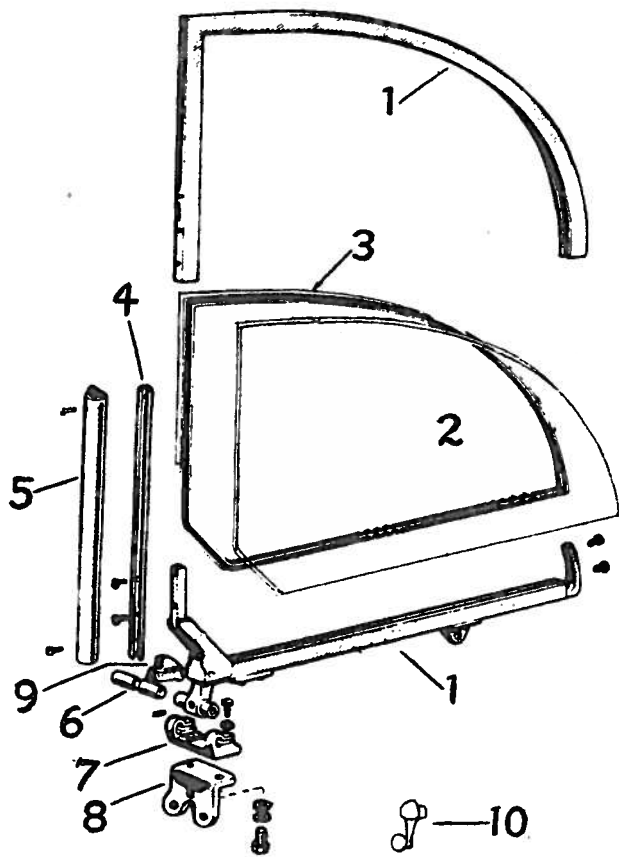

QUARTER WINDOW
BODY TYPE 76—CONVERTIBLE

Item Part No.	Description	Price	Item Part No.	Description	Price
8A-7629701	Glass & fr. assy., complete	27.00	5 8A-7630147	Wthstp	2.25
1 8A-7629959	Channel assy.	3.85	6 21A-7630558	Pin (hinge)	.14
2 8A-7629710	Glass	5.70	7 21A-7629948	B—Hinge	3.00
3 8A-7629724	A—Strip (retaining)	..	8 8A-7629933	Brkt.	1.60
4 8A-7629983	Retainer	..90	9 8A-7629746	A—Wthstp (corner)	..20
			10 8A-7630322	B—Handle	..

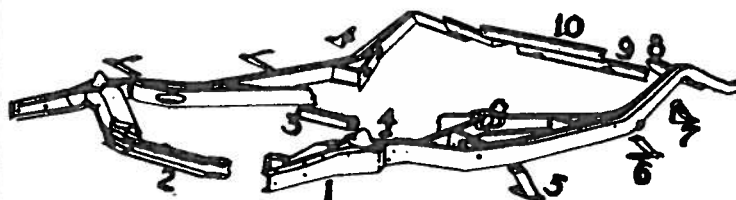

FRAME
BODY TYPE 79 STATION WAGON

Item Part No.	Description	Price	Item Part No.	Description	Price
1 8A-5005-C	Frame assy.	112.50	7 8A-5145	Brkt.	.85
2 8A-5071-B	Support (Rad, low)	1.40	8 8A-5032-B	Reinforcement	1.50
3 8A-5025-B	Cross member	4.50	9 8A-5035-B	Cross member (frame)	1.50
4 8A-5104	Brkt.	.25	10 8A-5029	Cross member (shock abs.)	2.00
5 8A-5076-B	Brkt.	.65			
6 8A-5088	Brkt.	.65			

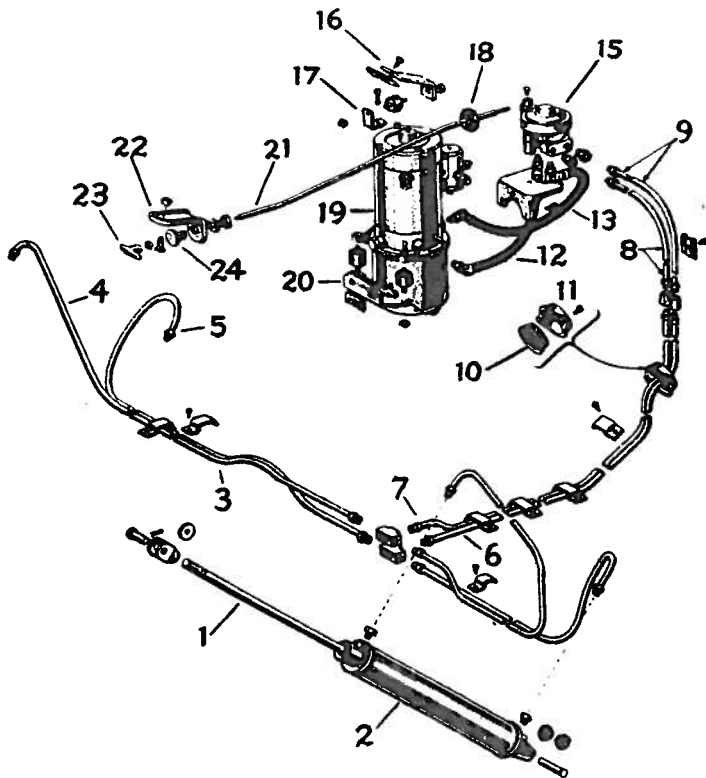

CONVERTIBLE TOP LIFTING MECHANISM
BODY TYPE 76

Item Part No.	Description	Price	Item Part No.	Description	Price
1 8A-7650774	Yoke	.85	12 8A-7653341	Hose assy. (return)	1.40
2 8A-7650601	Cylinder	9.25	13 8A-7653342	Hose assy. (supply)	1.85
3 98H-7850606	Spacer (cyl. to fl. brkt)	..	14 8A-7850688	Brkt	.20
4 8A-7653391	Tube assy. (pressure down)	.50	15 5EH-7850738	Valve assy.	5.15
5 8A-7653393	Tube assy. (pressure up)	.55	16 8A-7650767	Brkt (upper)	.10
6 8A-7650648	Tube assy. (press. up-center)	1.80	17 5EH-7353384	Brkt (mtg. cushion)	.08
7 8A-7650649	Tube assy. (press. down-center)	1.80	18 5EH-7353382	Cushion (motor mtg.)	.55
8 8A-7653361	B—Tube assy. (press. down-front)	.50	19 8A-7850736	Motor & pump assy. (complete)	28.20
9 8A-7653363	B—Tube assy. (press. up-front)	.50	20 8A-7650759	Brkt. (lower)	.40
10 8A-14603	Grommet	.15	21 8A-7650750	B—Rod (control)	.95
11 8A-14608	Retainer assy. (grommet)	.05	22 8A-7650582	Brkt. (inst. panel)	.65
			23 8A-7650640	Knob (control)	.76
			24 8A-7650578	Escutcheon	.40

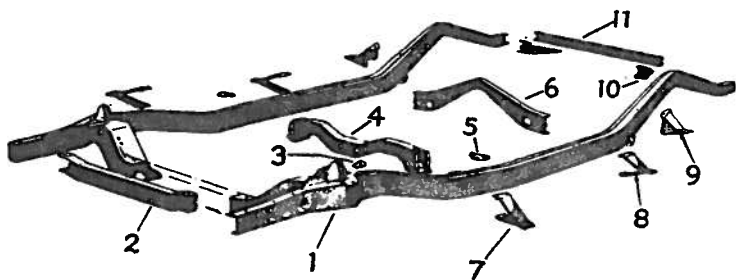

FRAME
EXCEPT BODY TYPE 79

Item Part No.	Description	Price	Item Part No.	Description	Price
1 8A-5005-A	Frame assy., 70, 72, 73	92.50	5 8A-5060	Brkt., 70, 72, 73	.25
1 8A-5005-B	Frame assy., 71, 76	70.00	6 8A-5028	Cross member, 70, 72, 73	3.75
2 8A-5071	Support (rad. low)	1.40	7 8A-5076-B	Brkt.	.65
3 8A-5104	Brkt.	.25	8 8A-5088	Brkt.	.65
4 8A-5025-A	Cross member, 70, 72, 73	4.10	9 8A-5145	Brkt.	.85
4 8A-5025-B	Cross member, 71, 76	4.50	10 8A-5032-A	Gusset	.90
			11 8A-5035-A	Rear cross member	1.50

HYDRA-ELECTRIC SYSTEM 1949 FORD

Model 76. CONVERTIBLE

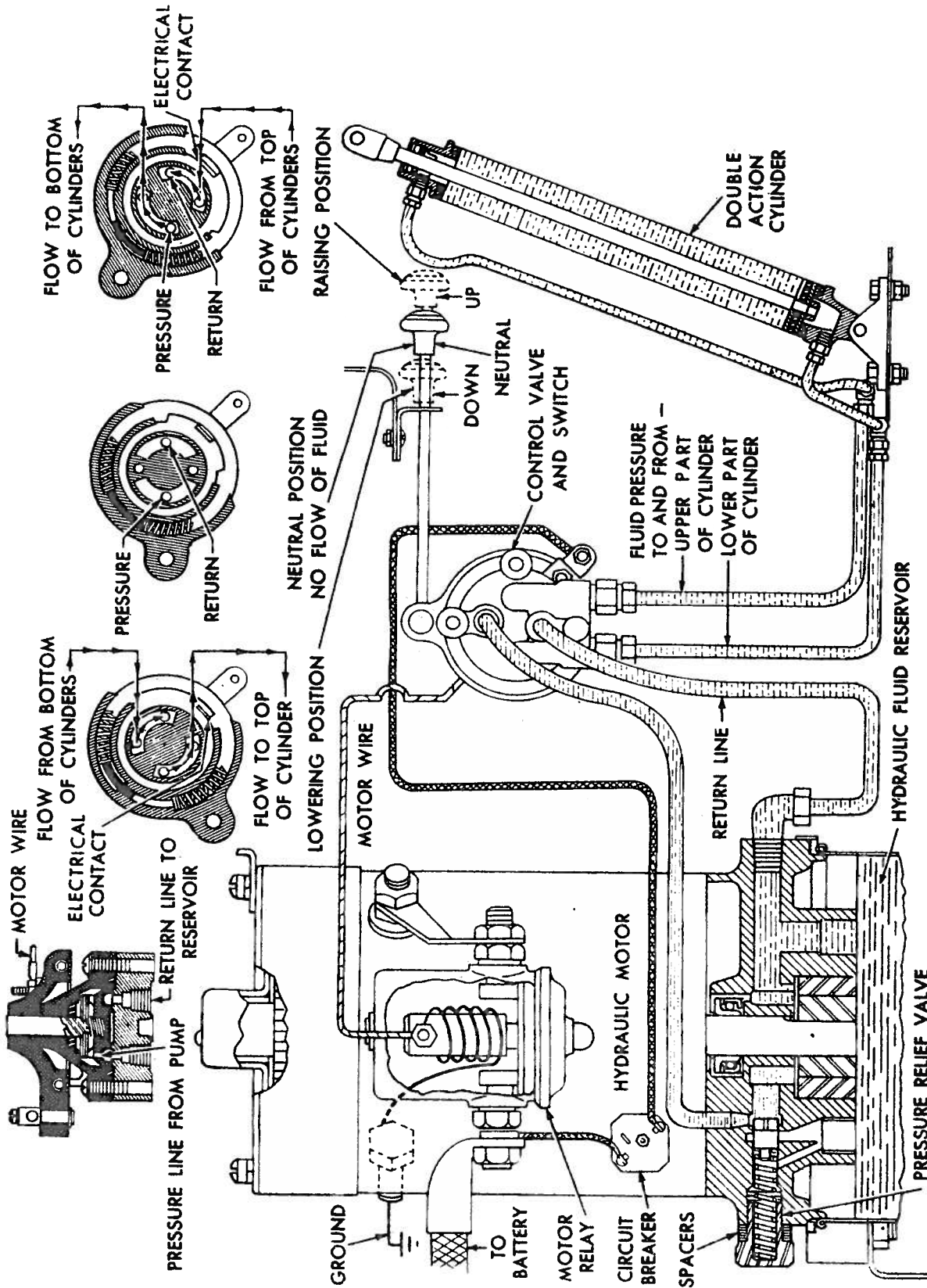

Schematic Diagram of Hydraulic System

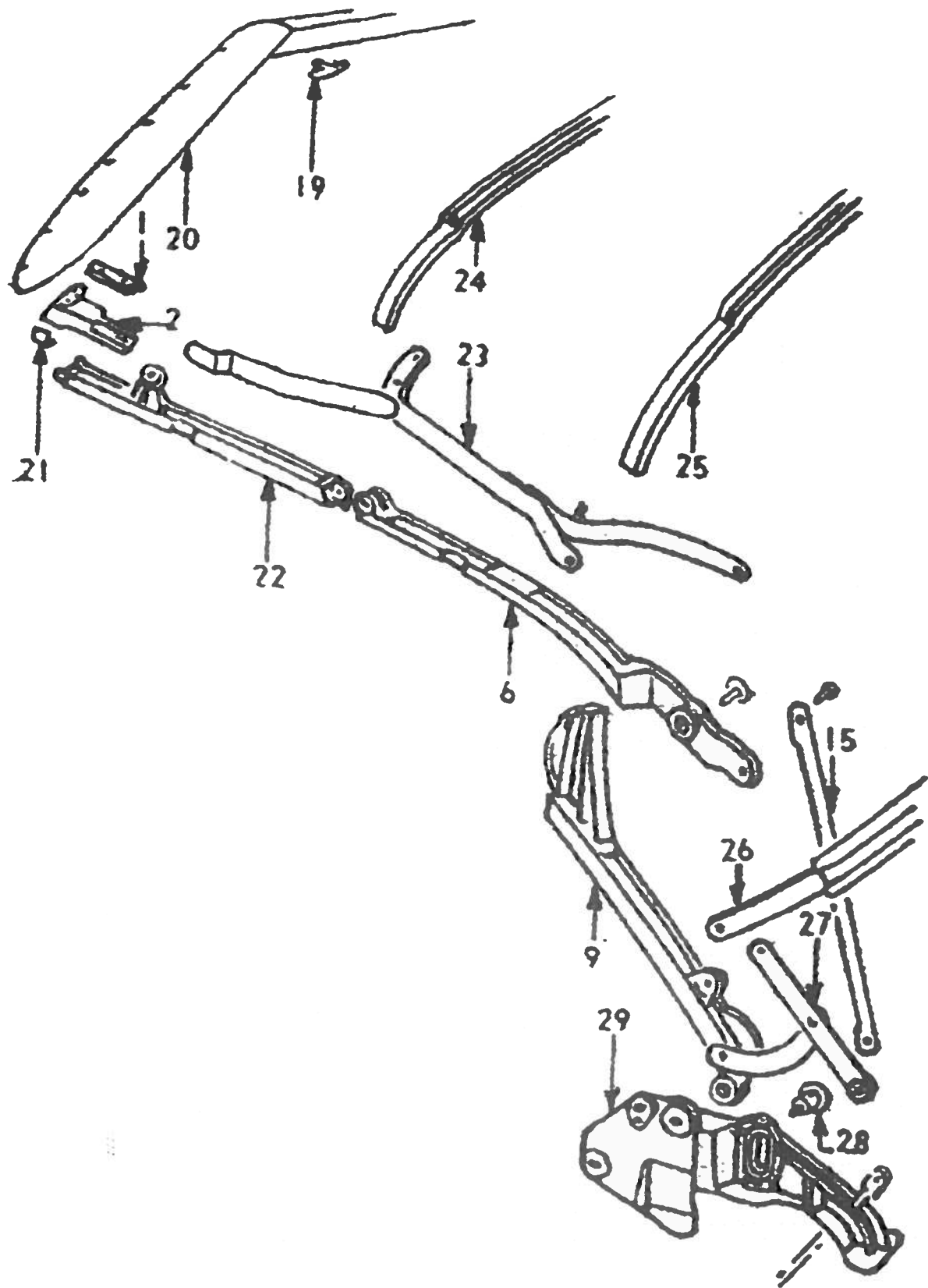

Fig. 16

BODY PARTS 1949 thru 1951 FORD

Models 98BA, 98HA, 0BA, 0HA, 1BA and 1HA. ALL BODY STYLES

6 DOOR HINGE SIDE RUN 8A-762154E—1949 to 195176
7 DOOR VENT. BRKT. & HANDLE SHAFT 8A-7022938-A—1949 (right)39
8A-7022938-B—1950-51 (right)33

Convertible Folding Top

Body Type—76—Convertible

See Fig. 16

1 HEADER BRACKET PLATE 8A-7653116—1949-5054
1A-7653116—195154
2 SIDE RAIL TO HEADER BRKT. 8A-7650832-A—1949-50 (right)	2.43
1A-7650832-A—1951 (right)	2.43
3 FRONT CONTROL LINK NO. 2 BOW 8A-7650434—1949-50 (right)	1.18
4 NO. 2 BOW BRKT. 8A-7653166-B—1940 to 1950 (right)66
5 TOP SLAT LINK NO. 2 BOW 8A-7650440—1949-50	1.18
6 REAR SIDE RAIL 8A-7651154-C—1949-50 (right)	8.94
1A-7651154—1951 (right)	8.94
7 NO. 3 BOW BRKT. 8A-7653144-B—1949-50 (right)	1.41
3 CONTROL LINK NO. 3 BOW 8A-7650330-B—1949-5091
1 PILLAR REAR RAIL ASSY. 8A-7653196-A—1949, less set screw (right)
8A-7653196-B—1940 to 1950, w/set screw (right)	8.29
1A-7653196—1951 (right)	8.29

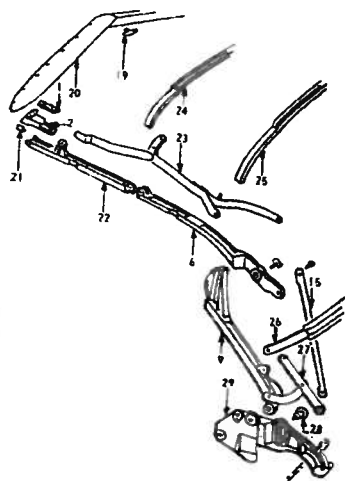

Fig. 16

10 TOP BOW SLAT REAR IRON 8A-7650340-B—1949-50 (right)	1.63
1A-7650340—1951 (right)	1.12
11 PILLAR HINGE TO BODY BRKT. PLATE 8A-7650398—1949 to 195112
12 MAIN PIVOT BRKT. TO SIDE RAIL BUMPER 8A-7653179—1949 to 195106
13 TOP POWER LINK (Upper) 8A-7650370—1949-5081
14 LOWER TOP POWER LINK 8A-7650418—1949-5016
15 TOP BALANCE LINK 8A-7650454—1949-50	1.63
1A-7650454—1951	1.63
16 FOLDING ARM REAR LINK 8A-7650308—1949-50	1.63
17 SLAT IRON LINK 8A-7650466—1949-50, No. 2 (right)97
18 SLAT IRON FOLDING ARM LINK 8A-7650432—1949-50 (right)91
18 BOW SLAT REAR IRON 8A-7650340-B—1949-50 (right)	1.63
1A-7650340—1951 (right)	1.12
19 TOP LOCKING HANDLE 8H-7603570—1949 to 1951	2.61
20 HEADER ASSY. 0A-7653038—1949 to 1951
1A-7653038—1951	25.98
21 HEADER BRACKET TO FRONT SIDE RAIL PLATE 1A-7650484—195106
22 FRONT SIDE RAIL 1A-7653104—1951 (right)	6.49
23 CONTROL LINK ASSY. 1A-7650316—1951 (right)	7.60
24 BOW ASSY. NO. 2 1A-7651274—1951	1.72
25 BOW ASSY. NO. 3 1A-7651289—1951	1.72
26 REAR BOW ASSY. NO. 4 8A-7651278-B—1949	10.31
0A-7651278—1950	10.31
1A-7651278—1951	10.39
27 POWER LINK 1A-7650852—1951 (right)	2.67
28 BALANCE LINK ADJ. PIVOT 1A-7650451—1951	1.56
29 MAIN PIVOT BODY BRKT. 8A-7653118-A—1949-50 (right)	7.23
1A-7653118-A—1951 (right)	7.23

* Opposite side one part number higher

Top Lifting Mechanism 1949-50

Body Type—76—Convertible
See Fig 17

1 CYLINDER YOKE ASSY. 8A-7650774—1949-5070
2 CYLINDER ASSY. 8A-7650601—1949-50, less yoke	7.47
3 CYLINDER TO FLOOR BRKT. SPACER 96H-7650606—1949-5019
4 PRESSURE DOWN REAR TUBE ASSY. 8A-7653390—1949-50 (right)76
5 PRESSURE UP REAR TUBE ASSY. 8A-7653392—1949-50 (right)61
6 PRESSURE UP CENTER TUBE ASSY. 8A-7650648—1949-50	1.95
7 PRESSURE DOWN CENTER TUBE ASSY. 8A-7650649—1949-50	1.95
8 PRESSURE DOWN FRONT TUBE ASSY. 8A-7653361-B—1949-5052

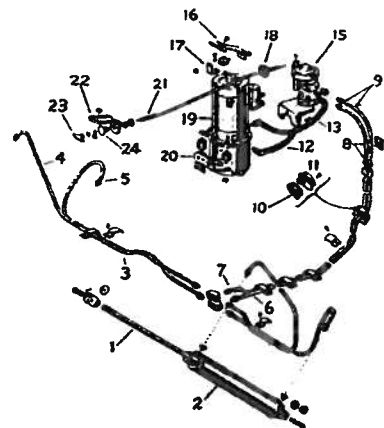

Fig. 17

9 PRESSURE UP FRONT TUBE ASSY. 8A-7653363-B—1949-5052
10 TUBE GROMMET 8A-14608—1949-5015
11 TUBE GROMMET RETAINER 8A-14608—1949-5015
12 PUMP TO CONTROL VALVE RETURN HOSE 8A-7653341—1949-50	1.50
13 PUMP TO CONTROL VALVE SUPPLY HOSE 8A-7653342—1949-50	1.50
14 OPERATING VALVE BRKT. 8A-7650636—1949-5033
15 OPERATING VALVE ASSY. 5EH-7650738—1949-50	7.84

continued

FORD 1949 CHASSIS WIRING

Models 8HA. 6 CYLINDER

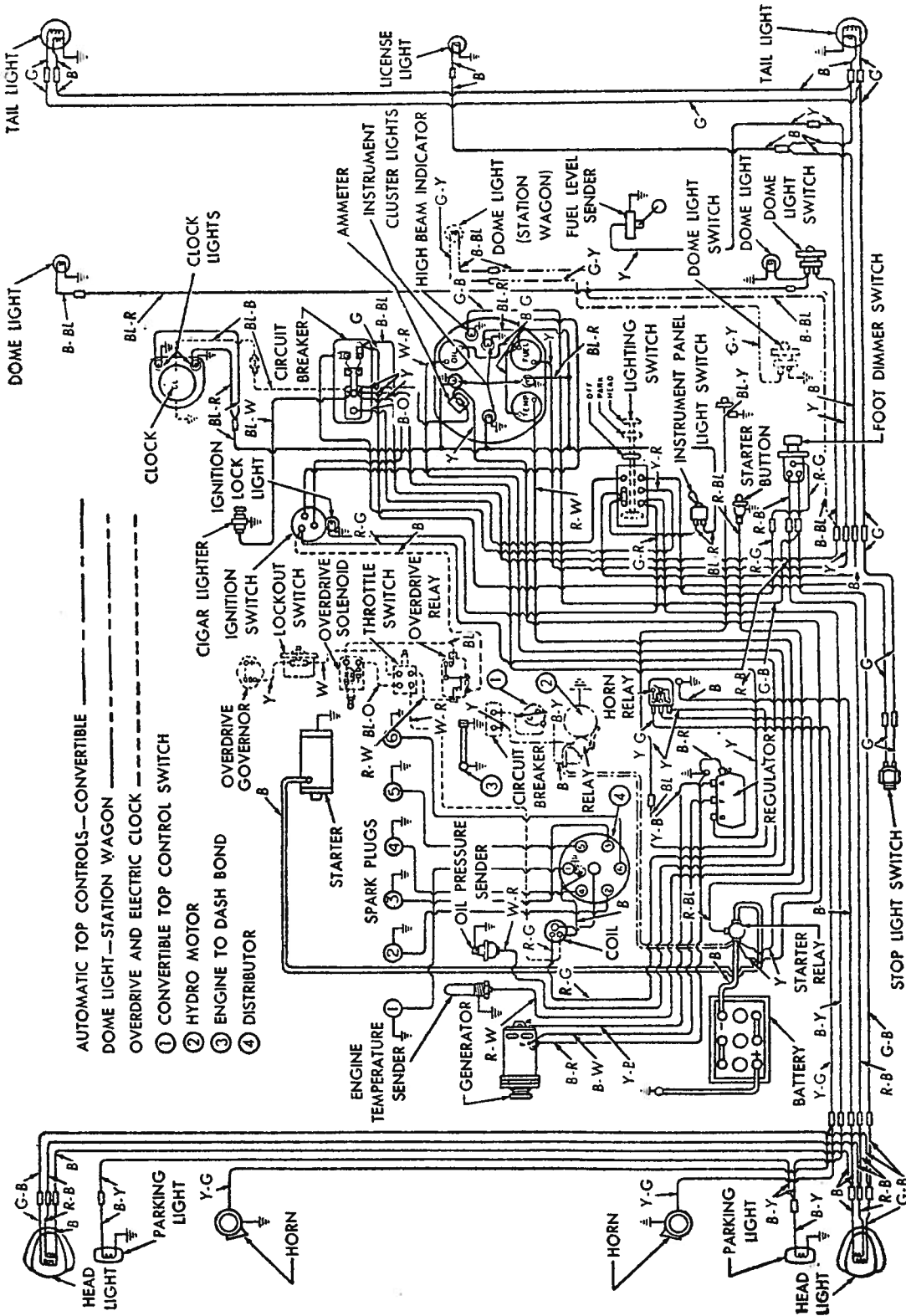

- AUTOMATIC TOP CONTROLS—CONVERTIBLE
- DOME LIGHT—STATION WAGON
- OVERDRIVE AND ELECTRIC CLOCK
- ① CONVERTIBLE TOP CONTROL SWITCH
- ② HYDRO MOTOR
- ③ ENGINE TO DASH BOND
- ④ DISTRIBUTOR

- W—White
- W-R—White with Red Tracer
- Y—Yellow
- Y-B—Yellow with Black Tracer
- Y-G—Yellow with Green Tracer
- Y-R—Yellow with Red Tracer

KEY

- C-B—Green with Black Tracer
- C-R—Green with Red Tracer
- C-Y—Green with Yellow Tracer
- R-B—Red with Black Tracer
- R-BL—Red with Blue Tracer
- R-C—Red with Green Tracer
- R-W—Red with White Tracer
- B-Y—Black with Yellow Tracer
- BL-B—Blue with Black Tracer
- BL-O—Blue with Orange Tracer
- BL-R—Blue with Red Tracer
- BL-W—Blue with White Tracer
- BL-Y—Blue with Yellow Tracer
- G—Green

- B—Black
- BL—Blue
- B-BL—Black with Blue Tracer
- B-G—Black with Green Tracer
- B-O—Black with Orange Tracer
- B-R—Black with Red Tracer
- B-W—Black with White Tracer

CHASSIS WIRING 1949 FORD

Models 8BA, 8 CYLINDER

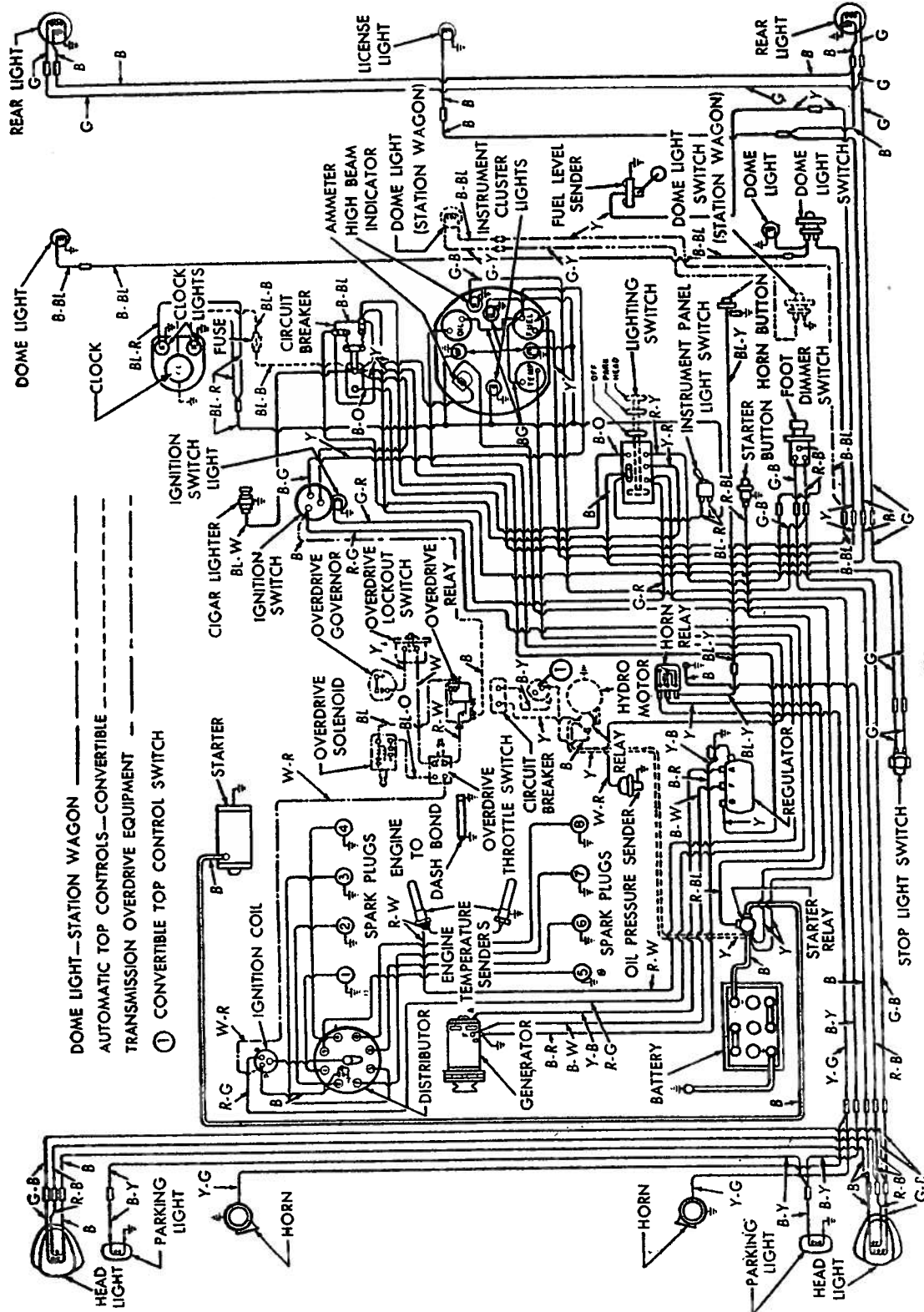

DOME LIGHT—STATION WAGON
 AUTOMATIC TOP CONTROLS—CONVERTIBLE
 TRANSMISSION OVERDRIVE EQUIPMENT
 ① CONVERTIBLE TOP CONTROL SWITCH

KEY

- B—Black
- BL—Blue
- B-BL—Black with Blue Tracer
- B-G—Black with Green Tracer
- B-O—Black with Orange Tracer
- B-R—Black with Red Tracer
- B-W—Black with White Tracer
- B-Y—Black with Yellow Tracer
- G—Green
- G-B—Green with Black Tracer
- G-R—Green with Red Tracer
- G-Y—Green with Yellow Tracer
- R-B—Red with Black Tracer
- R-BL—Red with Blue Tracer
- R-G—Red with Green Tracer
- R-W—Red with White Tracer
- R-Y—Red with Yellow Tracer
- W—White
- W-R—White with Red Tracer
- Y—Yellow
- Y-B—Yellow with Black Tracer
- Y-G—Yellow with Green Tracer
- Y-R—Yellow with Red Tracer

FORD 1949 FRAME

Models 8BA, 8HA. ALL BODY STYLES

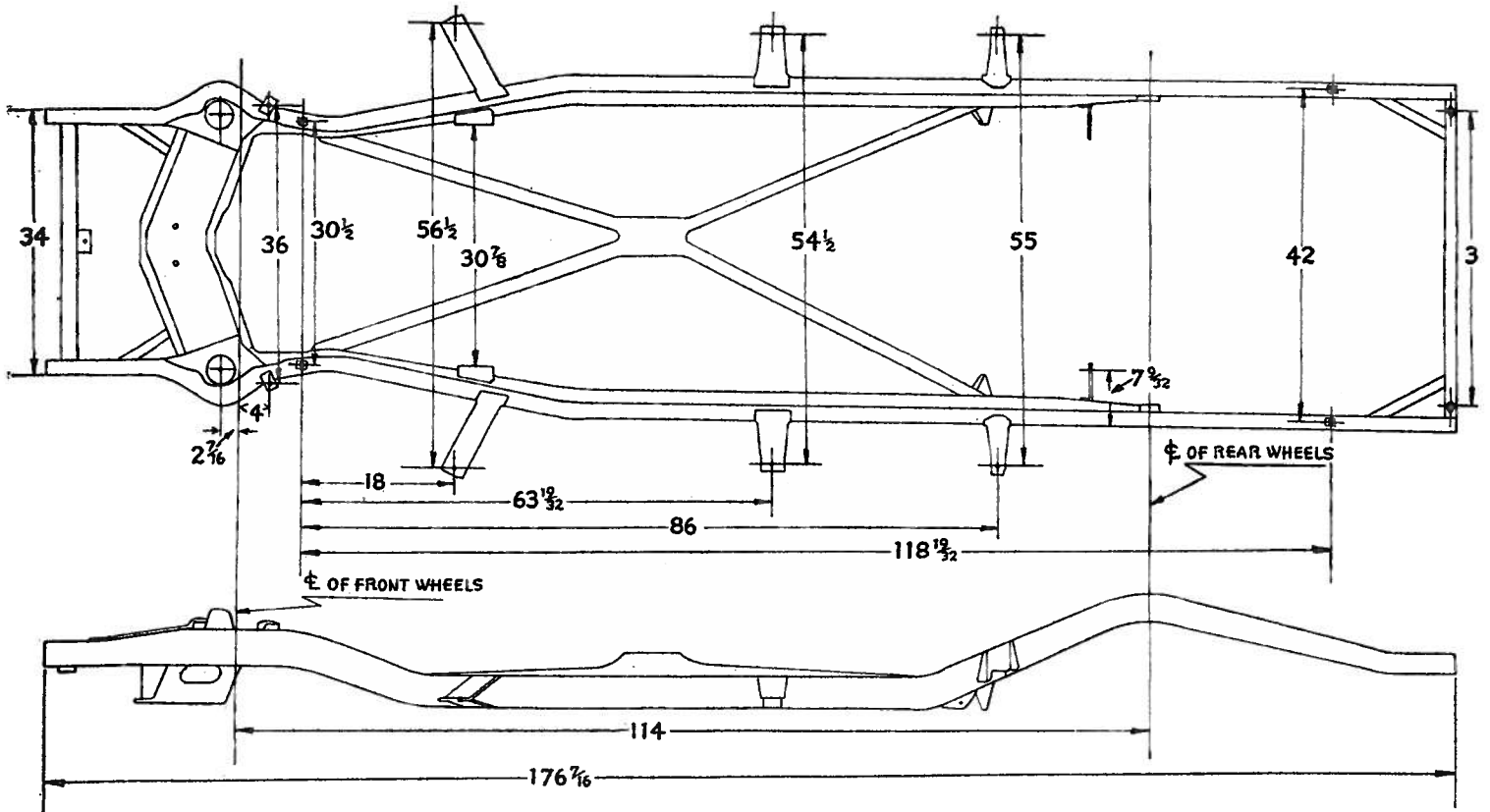

1949 Convertible

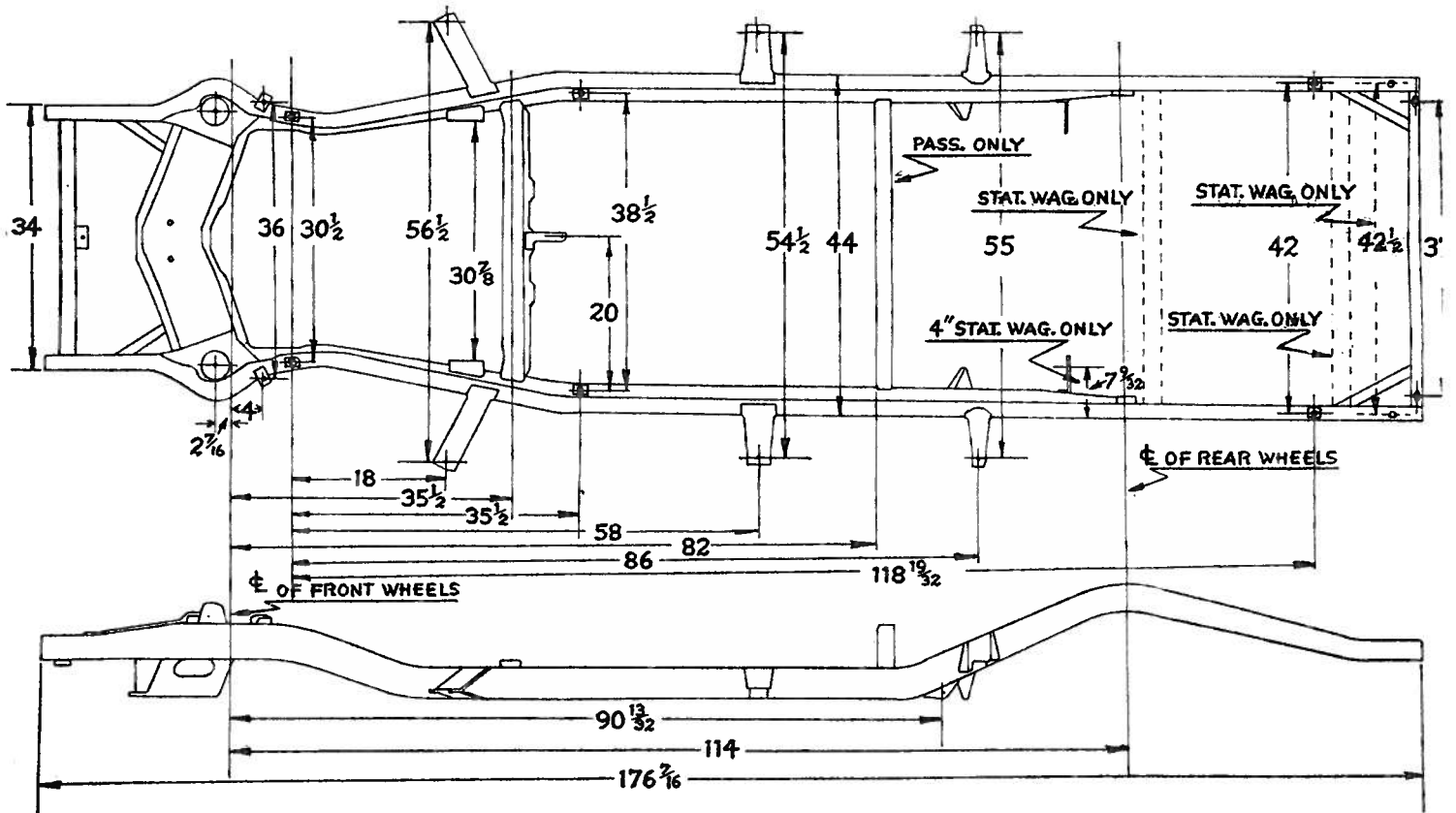

1949 Passenger

FLAT RATE 1949 FORD

Models 8BA, 8HA. ALL BODY STYLES

Job No.	Chilton Labor Price	Chilton Job No.	Chilton Labor Price	Chilton Job No.	Chilton Labor Price	Chilton Job No.	Chilton Labor Price	Chilton Job No.	Chilton Labor Price	Chilton Job No.	Chilton Labor Price	Chilton Job No.	Chilton Labor Price	Chilton Job No.	Chilton Labor Price
A		A—continued		A—continued		B—continued		C—continued		D—continued		E—continued		E—continued	
1	2.50	7	2.00	20x	10.00	11	3.25	6	2.00	1a	2.50	4	19.00	14	125.00
2	1.75	8	1.25	B		12	3.75	7	4.00	2	1.75	5		15	115.00
3		9	2.50	1	8.50	13		8	4.00	3		6		16	
4	17.50	10		1a	5.00	14	3.25	9		4	10.00	7		17	
5		11	3.00	2	29.00	15	1.25	10		5		8		18	
6	2.00	12	4.50	3	20.00	C		11	3.25	6	45.00	7	45.00	19	12.00
7	6.00	13	1.50	4	1.75	1	7.50	12	3.75	7	7.00	8	80.00	20	3.00
8		14		5	4.00	1a	8.00	13		8	80.00	9	82.00	F	
9		15	.75	6	2.00	2	29.00	14	3.25	9	82.00	10		1	7.50
10		16		7	2.00	3	19.00	15	1.25	10		11	62.00	1a	4.50
11		17	1.50	8	4.00	4	1.75	D		11	60.00	12	62.00	2	28.00
12		18	12.00	9		5	4.00	1	3.00	12	28.00	13		3	20.00
13		20	7.50	10						3	20.00	4	1.75	4	
14														1	55.00

STEERING GEOMETRY

CASTER: 1/4 degree positive to 3/4 degree neg.

CAMBER: 1/4 degree negative to 3/4 degree positive.

TOE-IN: 1/16 to 1/8 inches.

KING PIN INCLINATION: 5 1/2 degrees.

ADJUSTMENTS

Caster is adjusted at the lower control arm bushing. Turning bushing towards rear of car will decrease caster. Turning towards front of car will increase caster.

Camber is adjusted at the upper support arm outer bushing.

Toe-in: Centralize steering and adjust both tie-rods to give correct toe-in.

