

# CHRYSLER 1946 to 1948 BODY PARTS

## Series C38, C39 and C40. SEDAN BODIES

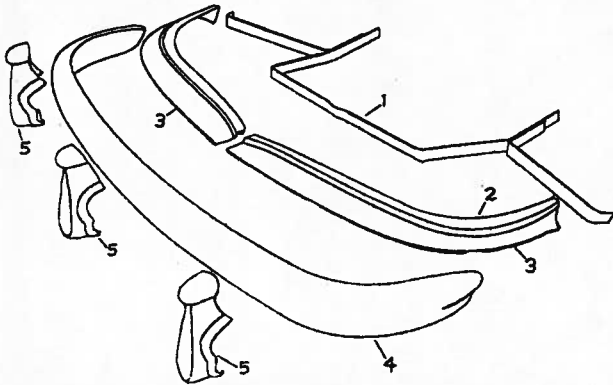

### FRONT BUMPER ASSEMBLY

Item Part No.	Description	Price	Item Part No.	Description	Price
1 1115782	Support	\$8.95	4 1115461	Face bar	35.35
2 313073	Anti-squeak	.06	5 1113458	Guard, L. early	7.75
3 1148291	Deflector	3.95	5 1123485	Guard, L. late	7.75

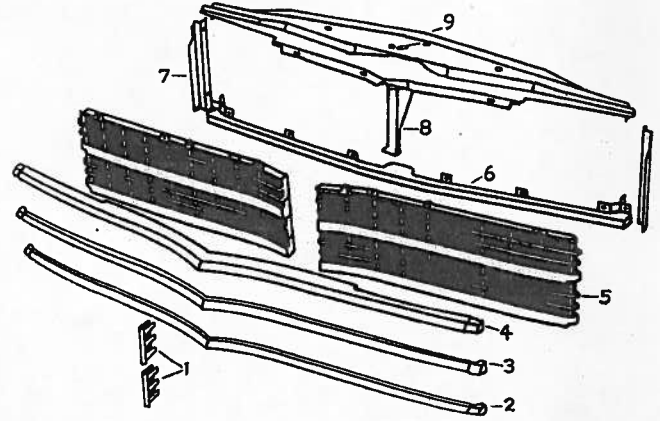

### GRILLE ASSEMBLY

Item Part No.	Description	Price	Item Part No.	Description	Price
1 1151914	Bar, cen. up.	.85	5 1151913	Grille, L.	19.82
1 1158634	Bar, cen. low.	.85	6 1149466	Bar, low.	3.12
2 1151917	Mould., low	5.20	7 1154035	Brace, L.	.54
3 1151916	Mould., cen.	5.75	8 1152479	Strainer	.71
4 1151915	Mould., up.	6.35	9 1149423	Support	4.02

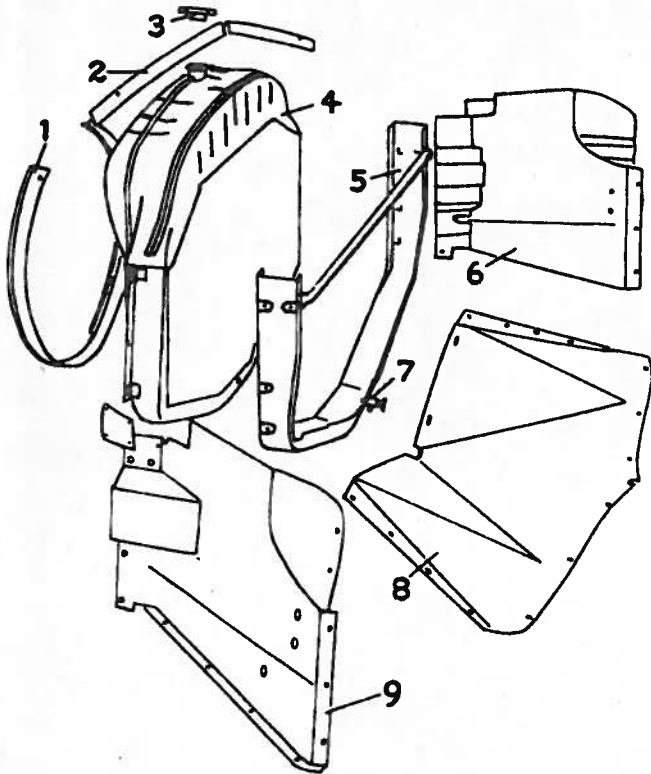

### RADIATOR ASSEMBLY

Item Part No.	Description	Price	Item Part No.	Description	Price
1 976231	Shroud, early	2.30	5 1234791	Support, C38	6.05
1 993161	Shroud, late	2.30	5 1234793	Support, C39, C40	7.30
2 1157309	Seal, C38	.45	6 1153973	Shield, L., C38	3.75
2 1163770	Seal, C38, C39	.75	6 1152445	Shield, L., C39, C40	3.75
3 837237	Cap, C38	.75	7 907782	Cock	.60
3 832676	Cap, C39, C40	1.48	8 1155958	Shield, C38	3.25
4 972210	Core, C38	70.45	8 1156453	Shield, C39, C40	4.15
4 975296	Core, C39N, C39K, early	115.75	9 1153973	Shield, C38	3.75
4 1155287	Core, C39N, C39K, C40, late	100.65	9 1153445	Shield, C39, C40	3.75

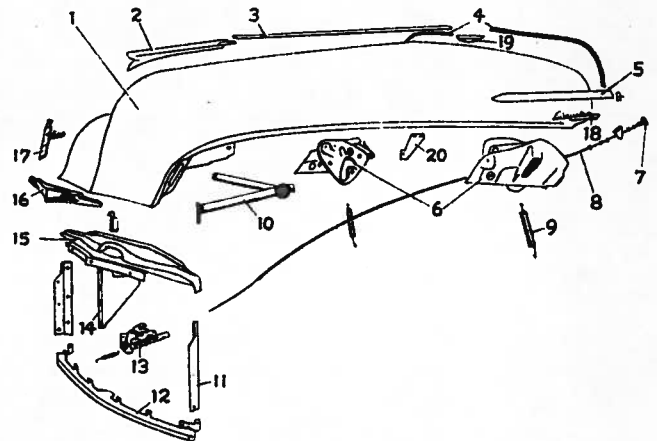

### HOOD ASSEMBLY

Item Part No.	Description	Price	Item Part No.	Description	Price
1 1148795	Panel, hood, C38..	43.45	13 980713	Lock, hood	1.02
1 1233453	Panel, hood, C39, C40	51.75	14 1152479	Strainer	.71
2 1132452	Ornament	7.50	15 1149423	Support	4.02
3 973670	Mould, C38, ctr.	1.30	16 1065802	Mould, front	5.21
3 973671	Mould, C39, C40, ctr.	1.50	17 974392	Plate, name	3.12
4 747877	Strip	.08	18 1161130	Plate, Royal	1.42
5 1154637	Mould, side, L.	1.25	18 1161134	Plate, Saratoga	1.42
6 1148696	Hinge, L.	5.45	18 1161131	Plate, Windsor	1.42
7 1157939	Knob & wire	1.00	18 1161132	Plate, N. Y.	1.61
8 908784	Housing assy.	.75	18 1161133	Plate, Hghidr.	1.61
9 981020	Spring	.70	18 877138	Plate, Traveler	1.91
10 985479	Prop.	2.00	18 1157632	Plate, Twn. & Ctry.	1.61
11 1154035	Brace, L.	.50	18 932435	Plate, Crown Imp.	1.51
12 1149466	Bar	3.15	19 905476	Seal	.12
			20 1153381	Bracket	.11

# BODY PARTS 1946 to 1948 CHRYSLER

## Series C38, C39 and C40. SEDAN BODIES

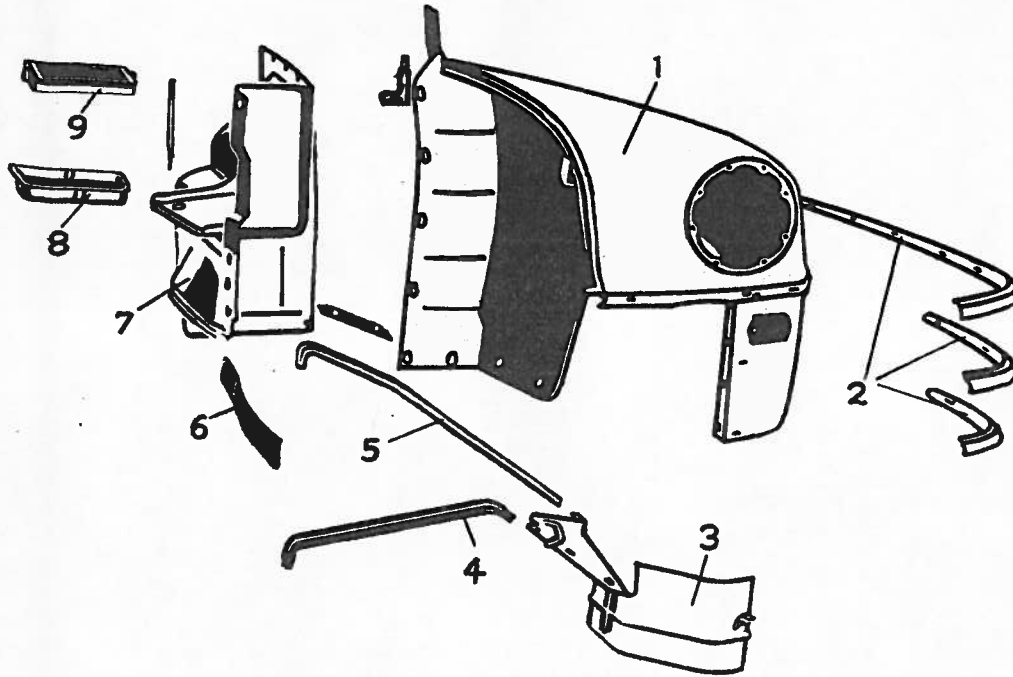

### FRONT FENDER ASSEMBLY

Item	Part No.	Description	Price
1	1148544	F. fender, L., C38..	37.50
1	1148404	Fender, L., C39, C40 .....	43.40
2	1151919	Mould., up. L. ....	5.75
2	1151921	Mould., center L. .	3.95
2	1151923	Mould., low. L. ...	3.55
3	1156058	Shield, C38, L. ...	2.26
3	1156067	Shield, C39, C40...	2.20
4	984056	Brace, up. L., C38.	.80
4	1163483	Brace, up. L., C39 C40 .....	.60
5	984059	Brace, low. L., C38	.60
5	1236520	Brace, low. L., C39 C40 .....	.60
6	953865	Seal, C38 .....	.30
6	953866	Seal, C39, C40....	.80
7	1121186	Shield assy. L., C38	8.95
7	1121197	Shield assy. L., C39, C40 .....	9.25
8	957778	Tray .....	.80
9	865414	Strap .....	.65

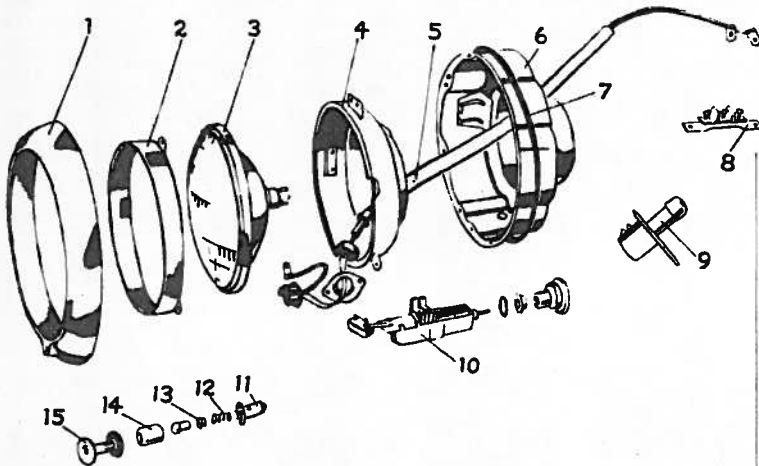

### HEADLAMP ASSEMBLY

Item	Part No.	Description	Price	Item	Part No.	Description	Price
1	938964	Door .....	1.85	8	683995	Block, hdip. term...	.30
2	946942	Ring (chrome) .....	1.55	9	859974	Switch, dim. ....	1.05
2	946942	Ring (black enamel)	1.55	10	1163581	Switch, hdip. ....	2.40
3	853869	Sealed beam unit...	1.25	11	682198	Socket .....	.10
4	946940	Seat assy. ....	1.55	12	385532	Spring .....	1.15
5	1163634	Cable & socket, 83/2" .....	2.20	13	657572	Contact .....	1.15
5	1148884	Cable & socket, 24" .....	1.55	14	1163840	Body .....	.15
6	1154200	Shell .....	2.40	15	1149850	Indicator assy., C38, C39 .....	.40
7	897686	Gasket .....	.15	15	1232659	Indicator assy., C40	.40

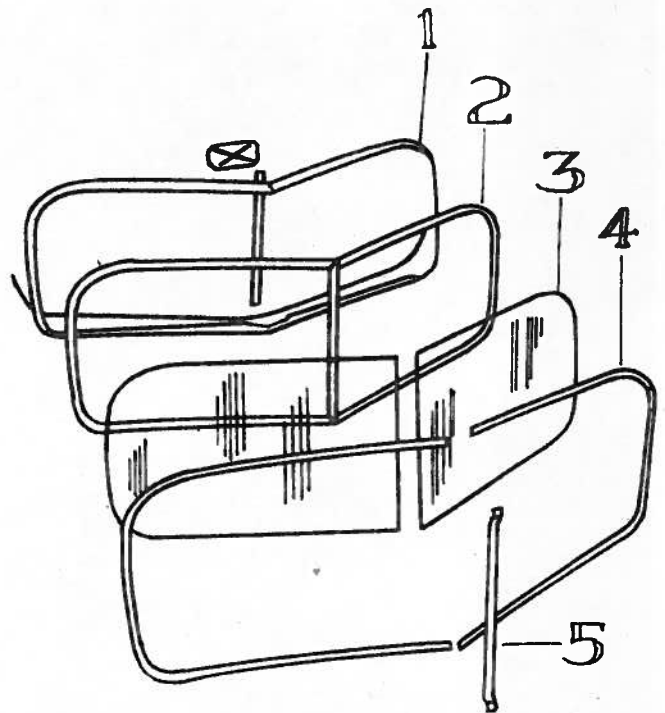

### WINDSHIELD

Item	Part No.	Description	Price	Item	Part No.	Description	Price
1	892197	Mould. assy. (white) .....	3.50	3	892189	Glass .....	P.O.A.
1	1233044	Mould. assy. (walnut) .....	12.00	3	1235492	Glass (for elec. def.) .....	P.O.A.
2	946017	W/thetp. ....	6.75	4	892381	Mould., outside ..	1.00
				5	893059	Bar .....	1.50

# CHRYSLER 1946 to 1948 BODY PARTS

## Series C38, C39 and C40. SEDAN BODIES

### INSTRUMENT PANEL

Item Part No.	Description	Price
1	1149669—Screen, C38, C39..	1.45
1	1158782—Screen, C40, 4D, 7sd, Limo .....	1.45
2	951994—Cover, C38, C39 ...	1.45
3	1149723—Grille, C38, 9, maroon .....	1.45
3	1154757—Grille, C38, 9, green .....	1.45
3	1154758—Grille, C38, 9, blue .....	1.45
3	1154759—Grille, C38, 9, beige .....	1.45
3	1154760—Grille, C38, 9, neutral .....	1.45
3	1158749—Grille, C40, walnut .....	5.20
4	1161570—Switch, heater ...	1.45
5	689867—Connector .....	.10
6	1149723—Mould. ....	.85
7	911928—Plate, Highlander..	.75
7	901716—Plate, Royal .....	.85
7	901717—Plate, Windsor .....	.85
7	937823—Plate, Saratoga ...	.65
7	901718—Plate, N. Y. ....	.65
7	1159290—Plate, Crown Imp..	2.50
7	1239612—Plate, Traveler ...	3.50
8	1163920—Clock, pkg., C38, 9	17.50
8	1233516—Clock, C40 .....	17.50
9	1149608—Mould, C38, 9 .....	2.90
9	1158767—Mould, C40 .....	3.25
10	1149770—Frame .....	11.80
11	1163814—Knob .....	1.00
12	901163—Receiver .....	.95
13	951995—Plate, C38, 9 .....	1.15
13	1159541—Plate, C40 .....	1.25
14	1148842—Knob .....	1.00
15	945511—Shaft & wire .....	.70
16	908784—Housing .....	.75
17	1148844—Knob .....	1.00
18	974511—Shaft & wire .....	.70
19	908784—Housing .....	.75
20	1148845—Knob, C38, 9 .....	1.00
20	1232653—Knob, C40 .....	1.00
21	1148841—Knob, C38, 9 .....	1.00
21	1232652—Knob, C40 .....	1.00
22	1122159—Switch .....	1.75
23	1163581—Switch .....	2.40
24	935699—Lens .....	1.15
25	903437—Switch, C38, 9 .....	1.35
25	1232764—Switch, C40 .....	1.50
26	1154761—Mould., maroon, C38, 9 .....	1.55
26	1154762—Mould., green, C38, 9 .....	1.55
26	1154763—Mould., blue, C38, 9 .....	1.55
26	1154764—Mould., beige, C38, 9 .....	1.55
26	1154765—Mould., neutral ..	1.55
26	937768—Mould., F. walnut, C40 .....	1.85
27	734814—Mould., C38, 9 .....	.60
27	1159304—Mould., C40 .....	.65
28	1161393—Panel, C38, 9, F. walnut .....	19.25

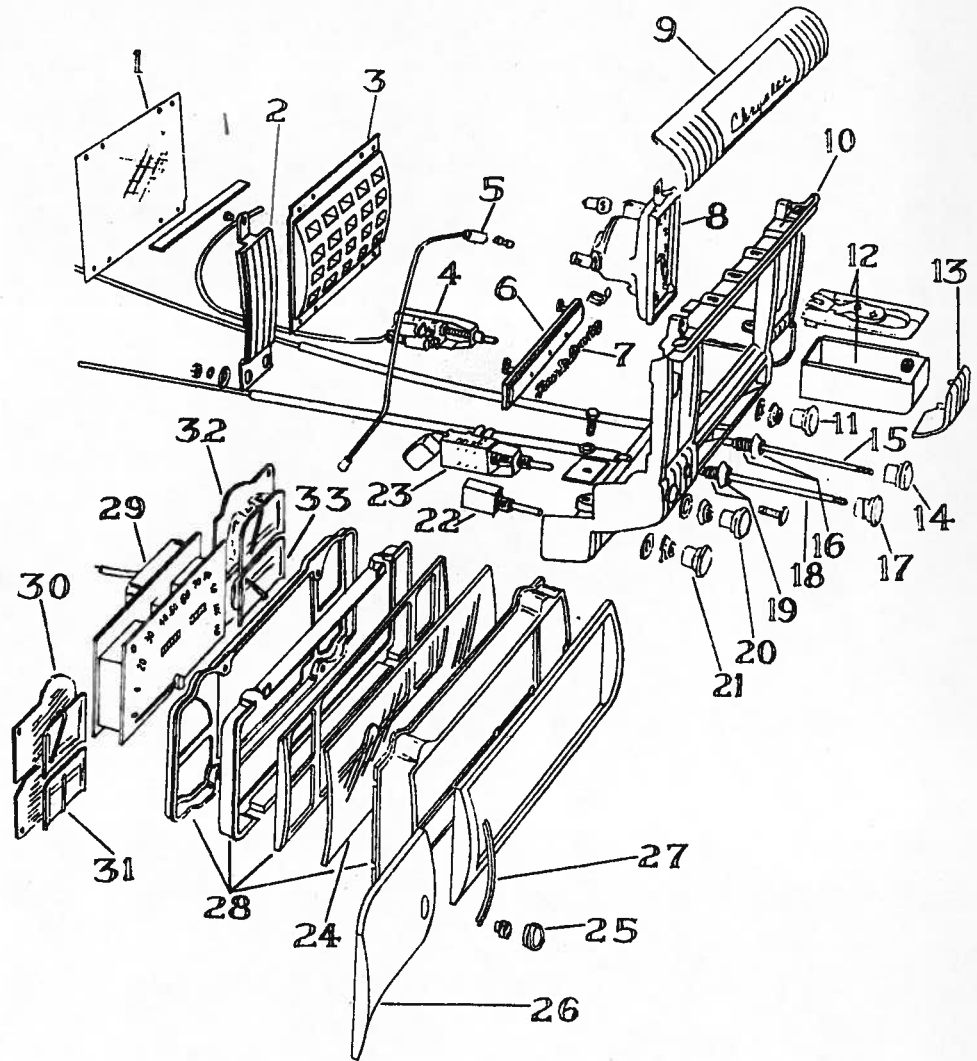

Item Part No.	Description	Price	Item Part No.	Description	Price	Item Part No.	Description	Price
28	1161395—Panel, C38, 9, walnut .....	19.25	28	1158797—Panel, C40, 4D, 7sd, Limo .....	29.75	29	1233821—Speed., C38, 9 (mile) .....	17.25
28	1154161—Panel, C38, 9, white .....	15.50	29	1233821—Speed., C38, 9 (mile) .....	17.25	29	1233825—Speed., C40 (mile) .....	17.25

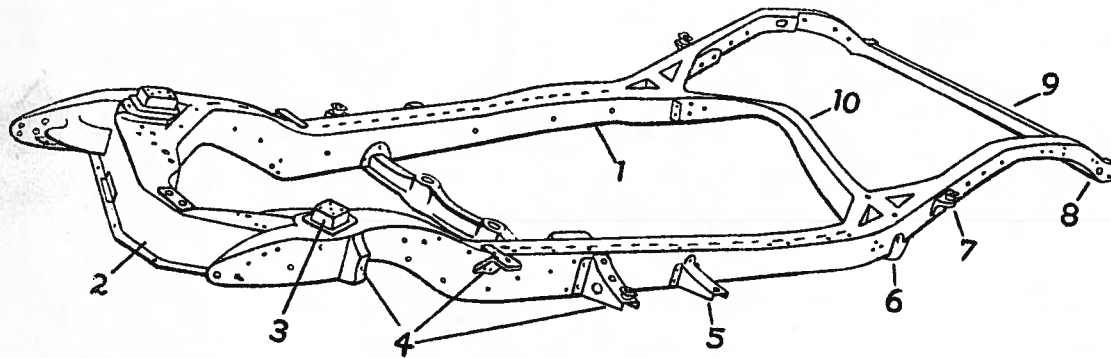

### FRAME ASSEMBLY

Item Part No.	Description	Price	Item Part No.	Description	Price	Item Part No.	Description	Price
1	952370—Frame, ex. 7sd, Limo less F.D., C38 .....	80.50	1	954545—Frame, less F.D., 7sd, Limo, C38 .....	132.25	1	952390—Frame, C39, ex. cv. cp. ....	103.50

Item Part No.	Description	Price
1	953090—Frame, F.D., ex. 7sd, Limo, C38 .....	86.25
1	954734—Frame, F.D., 7sd, Limo, C38 .....	132.25
1	952900—Frame, C40 .....	184.00
2	959346—Crossmember, F. ...	17.25
3	856177—Support, L. ....	.75
4	864372—Bracket (No. 1) ...	.60
4	952948—Bracket (No. 2), ex. conv. ....	2.00
4	953074—Bracket (No. 3), L., 4D .....	1.00
5	954719—Bracket, C39, 40 (No. 4) .....	.70
6	864322—Hanger, C38, 9 .....	1.40
6	864353—Hanger, C40 .....	1.55
7	865599—Bracket (No. 5), ex. conv. ....	.35
8	862899—Hanger, L., C38, 9 ..	1.00
8	864882—Hanger, L., C40 ...	1.95
9	862705—Crossmember, rear ..	4.05
10	864337—Intermed. C.M., C39 ..	5.50
10	864337—Intermed. C.M., C38, ex. 7sd, Limo .....	5.50

# BODY PARTS 1946 to 1948 CHRYSLER

## Series C38, C39 and C40. SEDAN BODIES

### CAR BODY (4-DOOR)

Item	Part No.	Description	Price
1	977147	Trough, C38, 9	1.30
1	115317	Trough, C40	1.55
2	1163439	Door, front L., C38, 9	46.00
2	1163443	Door, front L., 7 sdn., limo.	48.90
2	1159113	Door, front L., C40	72.50
3	943768	Panel, rep. L., C38, 9	36.80
3+	1151902	Panel assy., L., C38, 9	36.80
3+	1151903	Panel assy., L., C40	77.65
4	976899	Door, rear L., C38, 9	34.50
4	976903	Door, rear L., 7 sdn.	37.40
4	976905	Door, rear L., limo.	37.40
4	1159125	Door, rear L., C40	62.50
4	1159127	Door, rear L., limo., C40	62.50
5	1163499	Door, rep.	10.50
6	1152665	Panel, side, L., C38, 9	14.65
6	1159144	Panel, side, L., C40	19.50
8	1155838	Panel, dash, C38, 9	9.20
8	1159282	Panel, dash	13.25
9	1149937	Sill assy., L., C38, 9	8.65
9	1149900	Sill assy., L., C40	5.00
10	992473	Pillar, cent., C38, 9	8.35
10	943131	Pillar, cent., C38, 40	8.35
11	942885	Panel, rear rep.	5.70

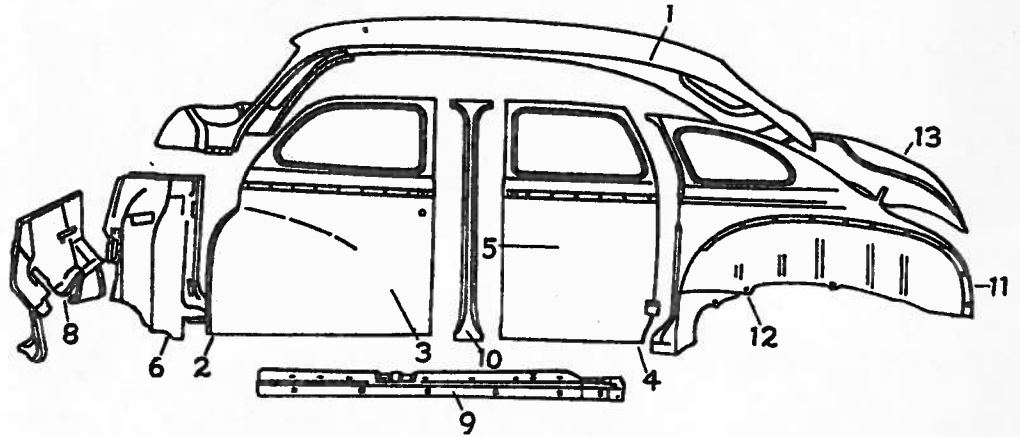

Body Sheet Metal

### QUARTER PANEL ASSEMBLY

Item	Part No.	Description	Price
12	1161273	Panel, rear L.	43.15
13	1296209	Lid assy., early	31.50

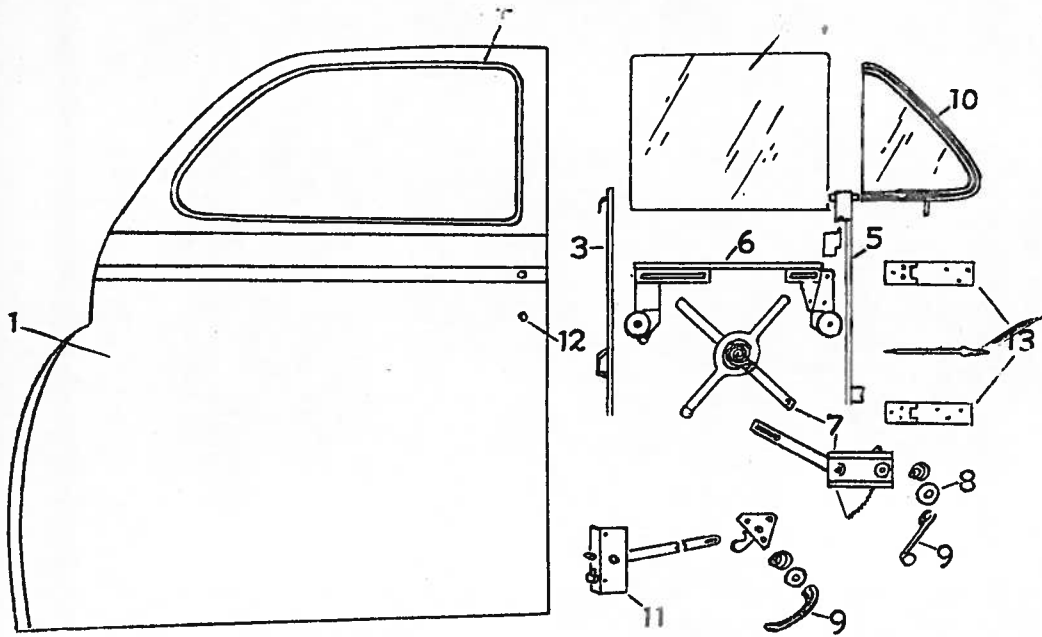

### FRONT DOOR ASSEMBLY

Item	Part No.	Description	Price
1	1163439	Door, front L., 4D, C38, 9, Trav.	46.00
1	1163443	door, F., 2D, 7sd, Limo, C38, 9	48.90
1	1159113	Door, F., 4D, 7sd, Limo, C40	72.50
2	848611	Glass, L., 4D, C38, 9, Trav.	P.O.A.
2	892224	Glass, L., 2D, 7sd, Limo, C38, 9, C40	P.O.A.
3	1152264	Bar, div., L.	2.30
4	977233	Wthstp., vent., L.	1.15
4	1161035	Wthstp., pillar, L.	.80
4	883909	Wthstp., glass	.50
5	1151805	Chan., 4D, Trav., C38, C39	1.00
5	1151813	Chan., 2D, 7sd, Limo, C38, 9, 40	.80
6	944528	Roller assy., L.	.55
7	1152968	Regitr. assy., 4D, Trav, C38, 9, L.	1.90
7	115027	Regitr. assy., 2D, 7sd, Limo, C38, 9, L.	1.90
7	1233001	Regitr. hyd., 4D, 7sd, Limo, C40, L.	11.25
8	1156240	Escutcheon, C38, 9	.75
8	1159165	Escutcheon, C40	1.05
9	893669	Handle, vent., C38, L.	.60
9	1159187	Handle, vent., C40, L.	.85
9	1161323	Handle, out., 4D, C38, 9, L.	2.40
9	1161329	Handle, out., 2D, C38, 9, L.	2.40
9	1161329	Handle, out., 4D, 7sd, Limo, C40, L.	2.40
9	901268	Handle, R.C., C38, 9	1.30
9	1159163	Handle, R.C., C40	1.45
10	1151973	Mould., L., 4D, C38, 9	1.50
10	1151979	Mould., L., 4D, 2D, 7sd, Limo, C40, C38, 9	1.85
10	893708	Mould., L., C38, 9, 4D	2.55
10	893710	Mould., L., C38, 9, 2D	3.00
11	945893	Lock, 4D, L., C38, 9	2.45
11	945897	Lock, L., 2D, 7sdn, Limo, C38, 9	2.45
12	992586	Cyl. lock pkg.	1.65
13	1151053	Hinge, L., up.	1.75
13	1151857	Hinge, L., low.	1.30

### PARKING LAMP ASSEMBLY

Item	Part No.	Description	Price
1	1161114	Frame	1.25
2	1161485	Gasket	.06
3	1161484	Housing	1.25
4	1161500	Cable, 85"	2.40
4	1154387	Cable, 27"	1.50
5	1161486	Gasket	.30
6	1161482	Lens	.45

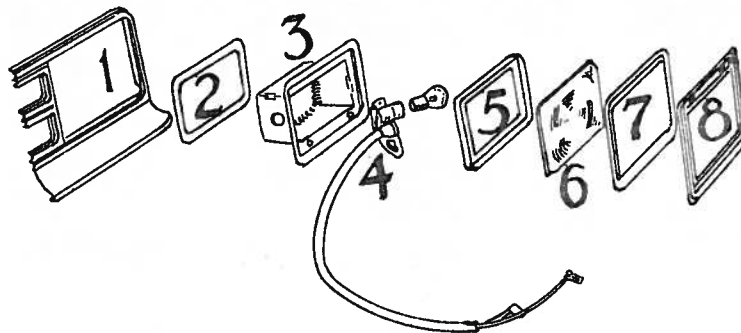

# CHRYSLER 1946 to 1948 BODY PARTS

## Series C38, C39 and C40. SEDAN BODIES

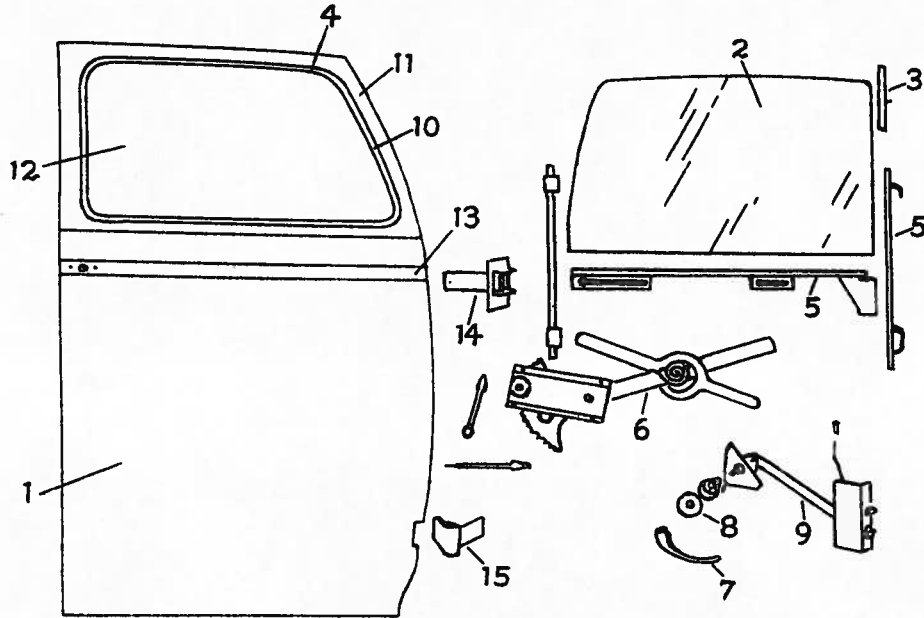

### REAR DOOR ASSEMBLY

Item Part No.	Description	Price
1 976899	Door, L., 4D, C38, 9	34.50
1 976903	Door, L., 7sd, C38	37.40
1 976905	Door, L., Limo, C38	37.40
1 1159125	Door, L., 4D, 7sd, C40	62.50
1 1159127	Door, L., Limo, C40	62.75
2 848647	Glass, 4D, C38, 9..P.O.A.	

Item Part No.	Description	Price
2 892248	Glass, 7sd, Limo, C38, 9 P.O.A.	
2 892248	Glass, 4D, 7sd, Limo., C40 P.O.A.	
3 1162437	Wthstp., pillar, L., C40, 4D, 7sd, Limo	2.20
3 945779	Wthstp., pillar, 4D, C38, 9	5.20

Item Part No.	Description	Price
3 945781	Wthstp., pillar, L., C38, 40	1.75
4 883908	Wthstp., D. glass, C40, 4D, 7sd, Limo	.50
5 977155	Chan., 4D, C38, 9, L.	.80
5 944245	Chan., 7sd, C38, L., C40	.80

Item Part No.	Description	Price
5 944528	Chan. roller	.55
5 944503	Chan. roller	.40
6 1154124	Regitr., 4D, 7sd, Limo, C38, 9	3.15
6 1156779	Regitr., L., hyd., C40	11.25
7 1161823	Handle, out., 4D, 7sd, Limo, C38, 9, L.	2.40
7 1155542	Handle, out., 4D, 7sd, Limo, C40, L.	2.90
7 911925	Handle, R.C., C38, 9	1.30
8 1156240	Escutcheon	.75
8 1156241	Escutcheon, C38, 9	3.10
8 1159165	Escutcheon, C40	1.05
8 1159164	Escutcheon, C40	.75
9 945955	Remote con., L., C38, 9	.65
9 946733	Remote con., L., C40	.75
10 1154839	Mould. (white), 4D	4.90
10 1154953	Mould. (F. walnut), 4D	7.20
10 1154955	Mould. (walnut-buri), 4D	7.20
10 1154848	Mould. (white), 4D	4.75
10 1154849	Mould (white), 7sd, Limo	4.75
10 1160232	Mould. (F. walnut), 7sd, Limo	14.50
10 1160234	Mould. (walnut-buri), 7sd, Limo	14.50
10 1159222	Mould., 4D, 7sd, Limo	65.00
11 1151976	Mould, out., 4D, L.	1.35
11 1151981	Mould., out., 7sd, Limo, C38, 9, 40	1.50
12 893713	Mould., rev., 4D, C38, 9	2.70
12 893715	Mould, rev., 7sd, Limo, C38, 9	3.15
13 893517	Mould., belt., 4D, C38, 9	.45
13 893519	Mould., belt., 7sd, Limo, C38, 9	.60
14 892286	Hinge, L., up., 4D, 7sd, Limo	2.00
15 944149	Hinge, L., low., 4D, 7sd, Limo, D.H.	.60
15 944151	Hinge, L., low., 4D, 7sd, Limo, B.H.	.75

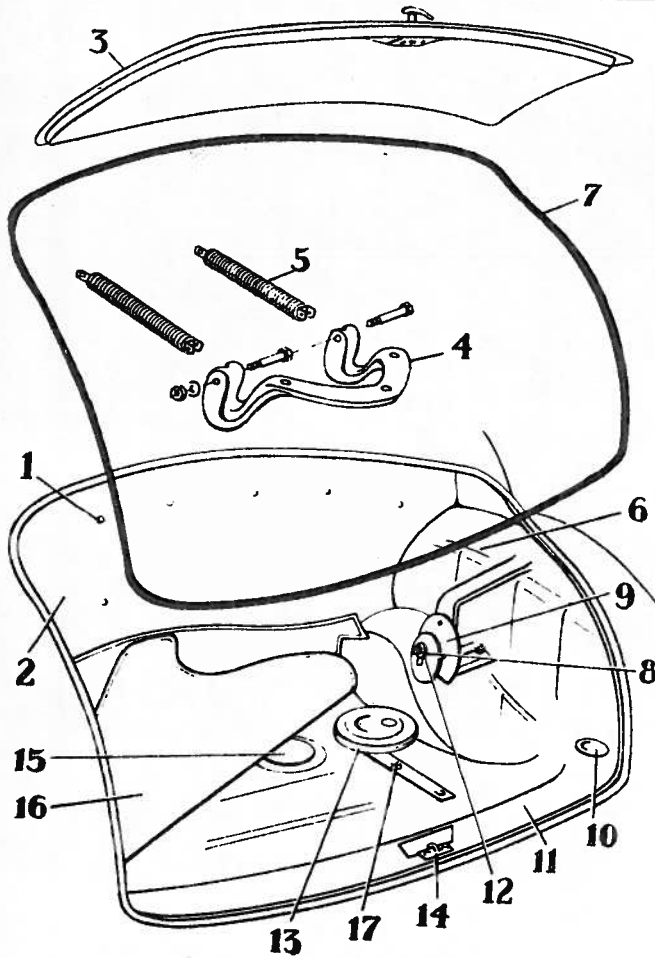

### REAR FENDER ASSEMBLY

Item Part No.	Description	Price
1 976384	Welt	1.75
2 1154165	Fender, C38, C39..	15.50
2 1155933	Fender, C40	15.50
3 637625	Cover	.30
4 1163276	Strip, L.	.60

Item Part No.	Description	Price
5 1153990	Mould.	2.70
6 1121323	Cover, L., ex. T. & C. 4D, 6 pass.	.60
7 981106	Brace, L., ex. 3 cp. C. cp.	.35

### DECK LIDS

Item Part No.	Description	Price
1 910752	Fastener, C38, 9	2.30
1 886582	Fastener, C40	3.45
2 905506	Panel	1.75
3 1236209	Lid, early	31.50
3 1236209	Lid, late	21.30
4 893223	Hinge	1.30
5 1233180	Prop. assy., C38, 9	1.75
5 895139	Prop., C40	1.75
6 1161273	Panel, L., C38, 9.	43.15
6 1159281	Panel, L., C40	56.95

Item Part No.	Description	Price
7 892305	Wthstp.	2.60
9 868897	Plate	.50
9 849065	Plate	.30
10 867711	Cover	.15
11 942885	Panel	5.70
15 874920	Seal	.06
16 890898	Mat. lining, C38, 9.	4.00
900011	Cover, front, C40..	4.90
900010	Cover, rear, C40..	6.35

# CHRYSLER 1946 to 1948 BODY PARTS

## Series C38, C39 and C40. SEDAN BODIES

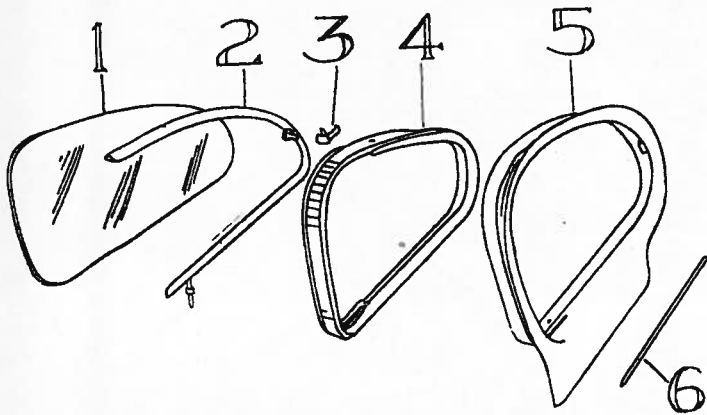

### REAR QUARTER WINDOW

Item Part No.	Description	Price	Item Part No.	Description	Price
1 892436	Glass, ex. 2D	P.O.A.	3 893669	Handle, 2D	.60
1 892401	Glass, 2D	P.O.A.	3 1159232	Handle, ex. 2D	1.00
2 892668	Frame, 4D, 7sd, Limo, L.	3.30	4 892673	Wthstp., ex. 2D	1.90
2 893014	Frame, 2D, L.	2.45	4 977237	Wthstp., 2D	1.25
8 893671	Handle, 4D, 7sd, Limo	.60	5 969048	Mould., 4D, 7sd	53.75
			6 1161041	Orna., ex. 2D	2.15
			6 1154793	Orna., 2D	6.35

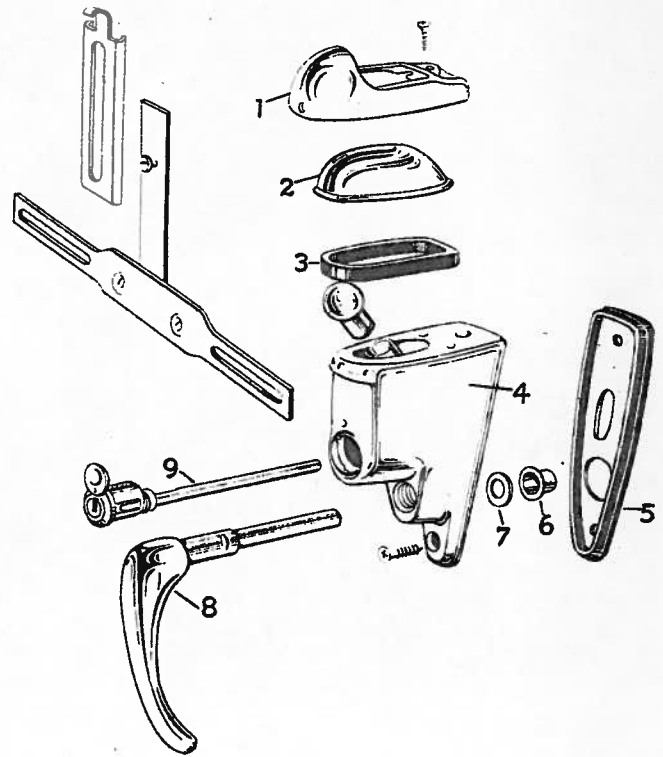

### LICENSE LAMP

Item Part No.	Description	Price	Item Part No.	Description	Price
1 1154287	Cover	1.10	6 877038	Sleeve	.06
2 974934	Lens	.30	7 905206	Washer, C38, C39...	2.30
3 974936	Gasket	.15	8 975779	Handle	1.95
4 938987	Body asy.	4.95	9 892587	Cyl. Pkg. (BP ser.)	1.60
5 1149304	Pad	.25			

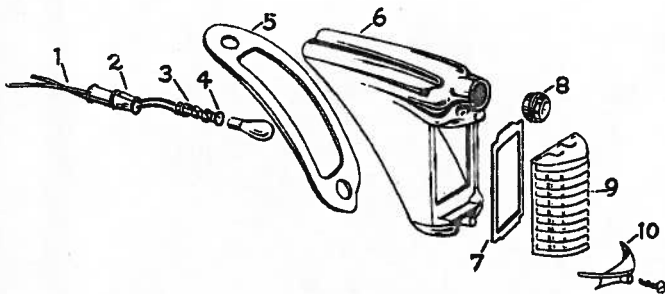

### REAR LAMP ASSEMBLY

Item Part No.	Description	Price	Item Part No.	Description	Price
1 830814	Cable, Tailamp	12.00	6 1161554	Body	4.80
2 903502	Socket	.15	7 902586	Gasket	.10
3 44758	Spring	.08	8 1163607	Button, reflector...	.30
4 657572	Contact	1.15	9 902585	Lens, early	.75
5 903850	Pad, early	.35	9 1235538	Lens, late	.85
5 1232626	Pad, late	.35	10 934589	Retainer	.70

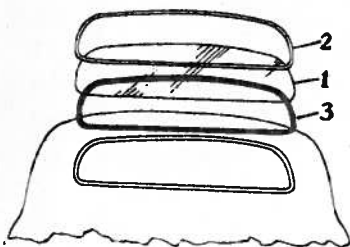

### REAR WINDOW

Item Part No.	Description	Price
1 892546	Mould., out.	2.30
3 892195	Glass, 4-D, Trav, 2D, 7sd, Limo	P.O.A.
2 892661	Mould. (white), C38, 9	2.00
2 984833	Mould. (F. wainut), C38, 9	4.05
2 951388	Mould. (wainut- burl), C38, 9	8.00
2 937738	Mould. (wainut- burl), C40	.15

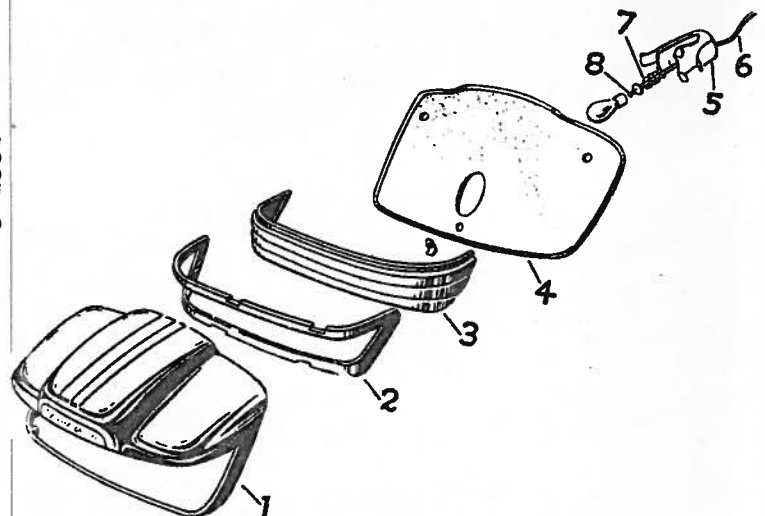

### STOP LIGHT

Item Part No.	Description	Price	Item Part No.	Description	Price
1 1161411	Shell, with F. D...	6.05	4 1161414	Pad, C40	.75
1 1237145	Shell, without F. D.	6.05	5 902592	Socket	.40
2 1161478	Gasket	.60	6 830813	Cable	9.00
3 1161412	Lens	2.15	7 44758	Spring	.06
4 903475	Pad, C38, C39	.80	8 657572	Contact	1.15

# BODY PARTS 1946 to 1948 CHRYSLER

## Series C38, C39 and C40. SEDAN BODIES

### CAR BODY (2-DOOR)

Item	Part No.	Description	Price
1	977147	Trough, L., C38, 9..	1.30
2	1163443	Door, front L., C38, 9	48.90
3	943768	Panel, rep., C38, 9..	36.80
3	1151902	Panel, assy., L., C38, 9	68.45
6	1152665	Panel, side cowl, C38, 9	14.65
6	1159144	Panel, side cowl, C40	19.50
8	1155838	Panel, dash, C38, 9	9.20
9	1149959	Sill assy., L., C38, 9	8.65
11	942885	Panel, rear, rep...	5.70

### QUARTER PANEL ASSEMBLY

12	1158419	Panel, L.	51.75
13	1236209	Lid assy., early	31.50

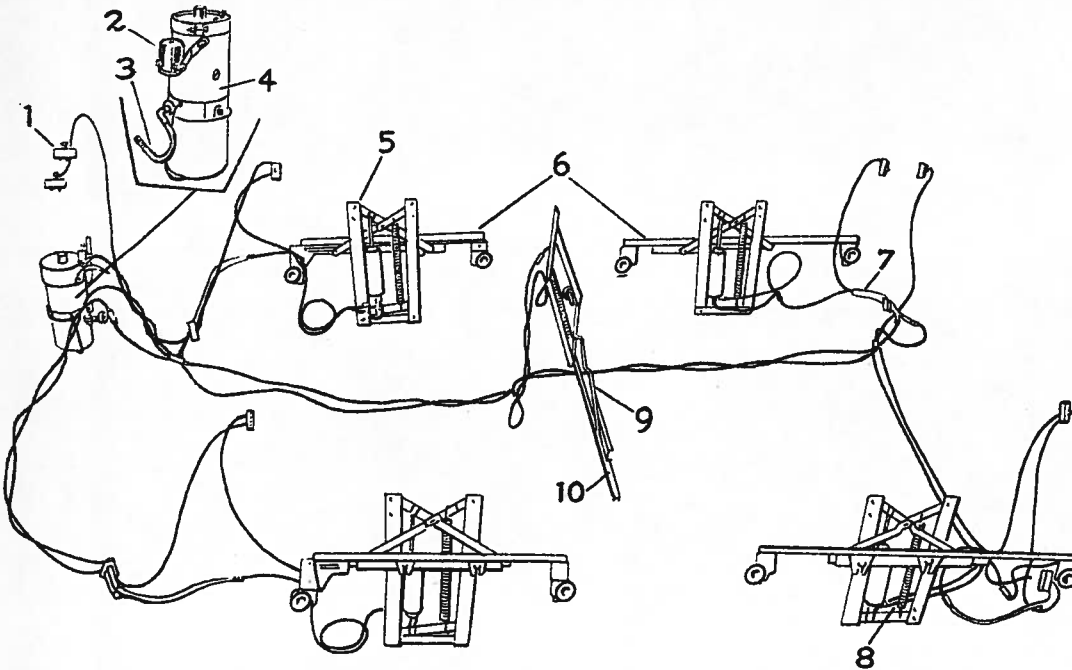
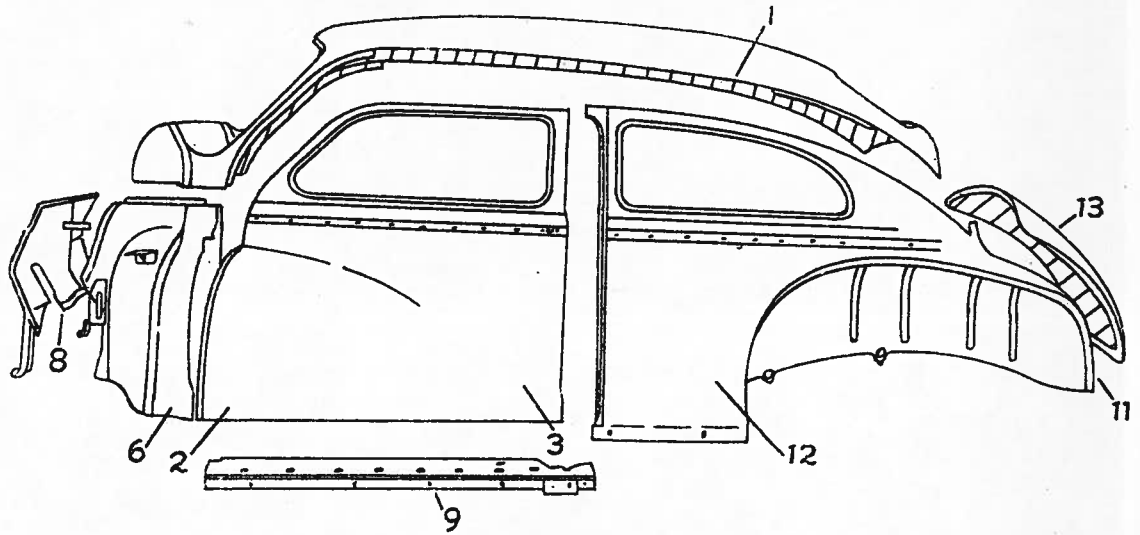

### HYDRAULIC WINDOW LIFT (C40 Model)

Item	Part No.	Description	Price
1	1158793	Switch, 4D, 7sd, Limo	1.50
2	1241040	Switch, 4D, 7sd, Limo	3.90
3	1159065	Hose	2.00
4	1233018	Motor assy.	46.00
5	1233001	Regltr., front L.	11.25
5	1158779	Regltr., rear L.	11.25
6	1151813	Chan., front L.	.80
6	944106	Chan., rear L.	.80
7	1233023	Conduit, door window	.70
8	1159033	Spring, regltr.	.80
9	1233013	Regulator	16.75
10	1233036	Chan.	2.00

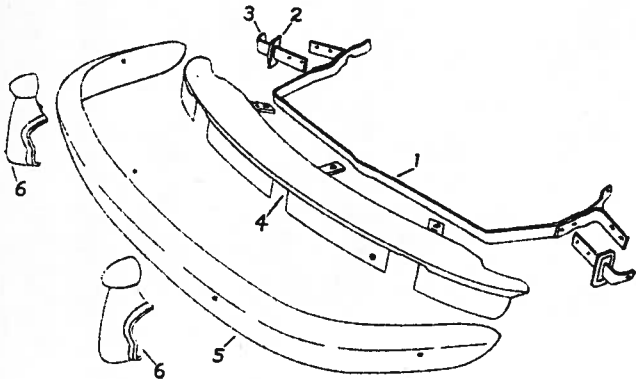

### REAR OF CAR REAR BUMPER ASSEMBLY

Item	Part No.	Description	Price	Item	Part No.	Description	Price
1	1122115	Support, T. & C., ex. cv. cp.	11.50	4	1238271	Deflector (3 cp. C. cp.)	5.35
1	1122131	Support, T. & C., cv. cp.	7.50	4	1181167	Deflector, early	5.35
1	1125777	Support, ex. T. & C.	7.50	4	1238267	Deflector, late	5.35
2	1121323	Cover, ex. T. & C. 4D, 6 pass.	.60	5	1115784	Bar, face, ex. T. & C.	39.70
3	1115806	Support, L.	1.15	5	1115784	Bar, face, C39, C40	39.70
				6	1115457	Plate, guard, L.	7.75

# CHASSIS WIRING 1946 to 1948 CHRYSLER

## Series C38, C39. SEDAN BODIES

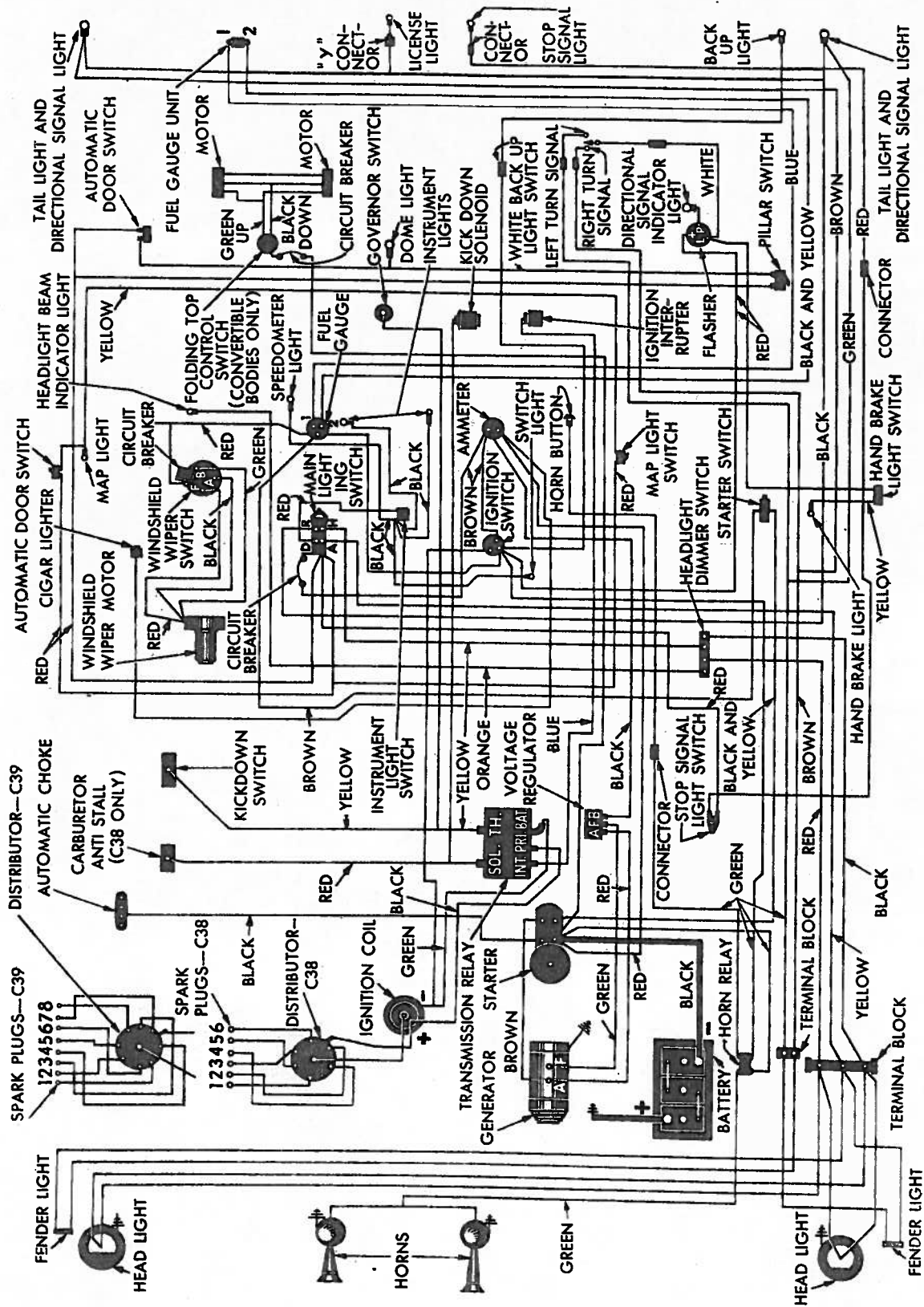





# FRAME 1946 to 1948 CHRYSLER

## Series C38, C39. SEDAN BODIES

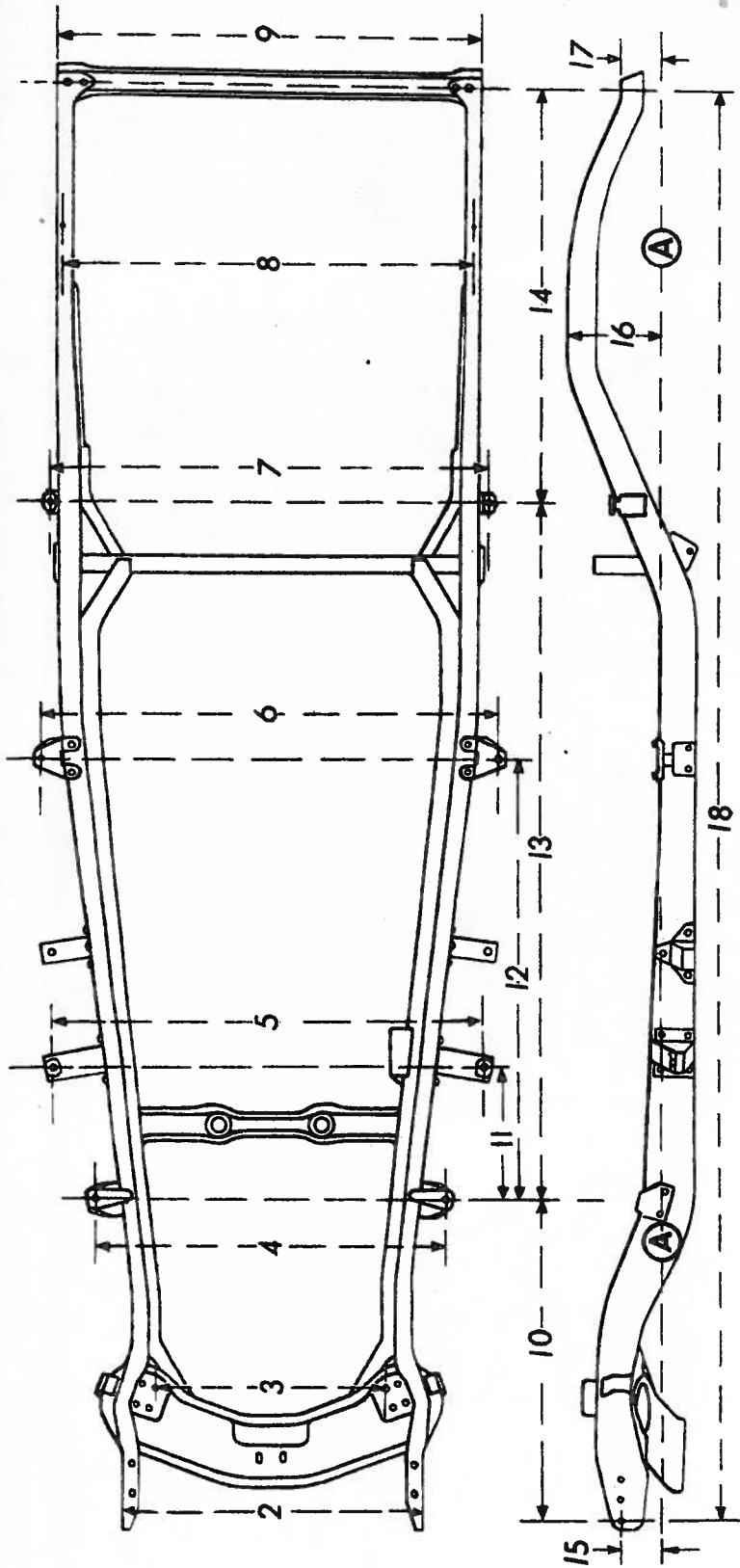

Frame Alignment (Dimensions given in inches)  
A—Top Line of Frame

	2	3	4	5	6	7	8	9	10	11	12	13	14	15	16	17	18
C38	34	26 5/32	40 17/32	50 3/4	52 11/16	50 1/2	46 3/4	48 1/4	40 31/32	15 29/32	51 59/64	81 29/32	48 7/8	3 55/64	30 13/16	4 7/8	171 3/4
C38 2-Door	34	26 5/32	40 17/32	50 3/4	53 7/8	50 1/2	46 3/4	48 1/4	40 31/32	15 29/32	60 31/32	81 29/32	48 7/8	3 55/64	30 13/16	4 7/8	171 3/4
C38 7-Pass	34	26 5/32	40 5/8	50 3/4	53 7/8	50 19/32	46 3/4	48 1/4	40 31/32	15 29/32	60 31/32	99 29/32	48 7/8	3 55/64	30 13/16	4 7/8	189 3/4
C39	34	26 5/32	40 19/32	50 3/4	52 3/4	50 9/16	46 3/4	48 5/16	46 31/32	14	51 59/64	81 29/32	48 7/8	3 7/8	30 13/16	4 7/8	177 3/4
C39 2-Door	34	26 5/32	40 19/32	50 3/4	53 15/16	50 9/16	46 3/4	48 5/16	46 31/32	14	60 31/32	81 29/32	48 7/8	3 7/8	30 13/16	4 7/8	177 3/4

# CHRYSLER 1946 to 1948 FRAME

## Series C40. SEDAN BODIES

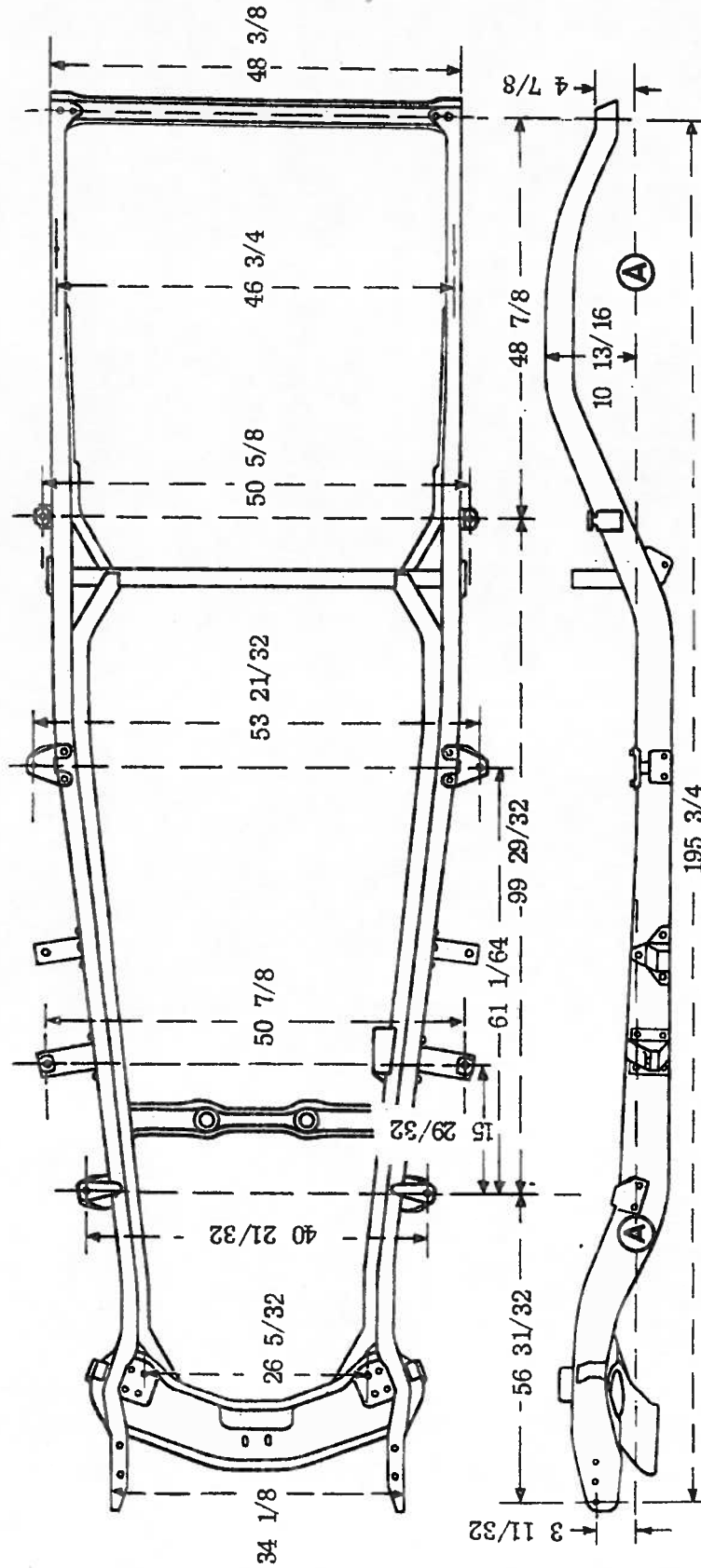

Frame Alignment (Dimensions given in inches)  
 A—Top Line of Frame

