

BUICK 1946 to 1948 BODY PARTS

Series 50. ALL BODY STYLES

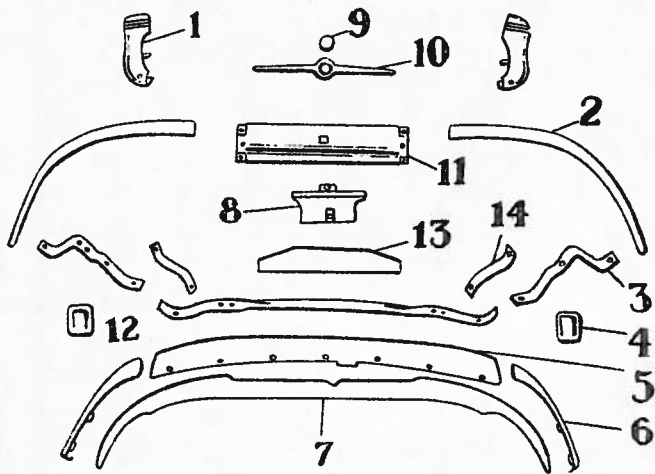

FRONT BUMPER ASSEMBLY

Item	Part No.	Description	Price	Item	Part No.	Description	Price
1	1332453	Guard	\$7.75	8	927422	Lamp	5.60
2	1328361	Plate, out. L.	16.25	9	1331654	Monogram	1.25
3	1328763	Bar, out. L.	2.25	10	1328322	Rail	3.90
4	1331374	Grommet	.30	11	1328359	Plate, center	12.85
5	1328685	Deflector	2.35	12	1330650	Bar, front	3.75
6	1324393	Deflector, L.	1.00	13	1331389	Rail	4.75
7	1328786	Deflector B. sec.	1.50				

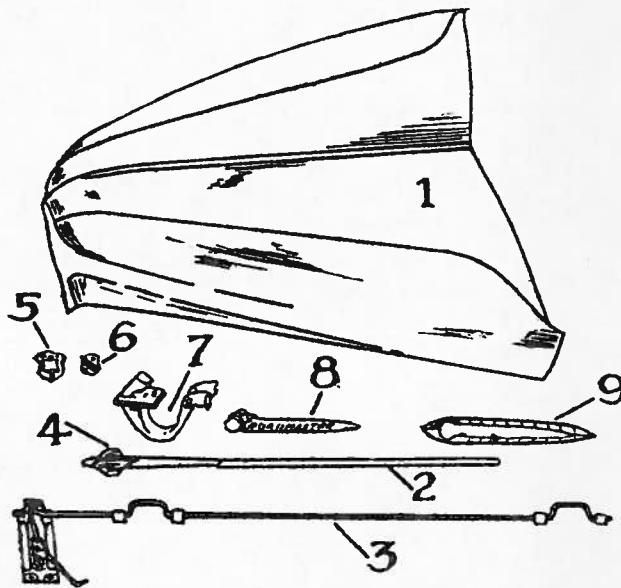

HOOD ASSEMBLY

Item	Part No.	Description	Price	Item	Part No.	Description	Price
1	1338198	Panel	51.75	5 & 6	1393606	Base & emblem	9.50
2	1323559	Molding	1.35	7	1336019	Hinge	1.75
3	1324205	Fastener, L.	1.35	8	1328619	Handle, L.	3.85
4	1393721	Ornament	8.55	9	1328630	Body	3.35

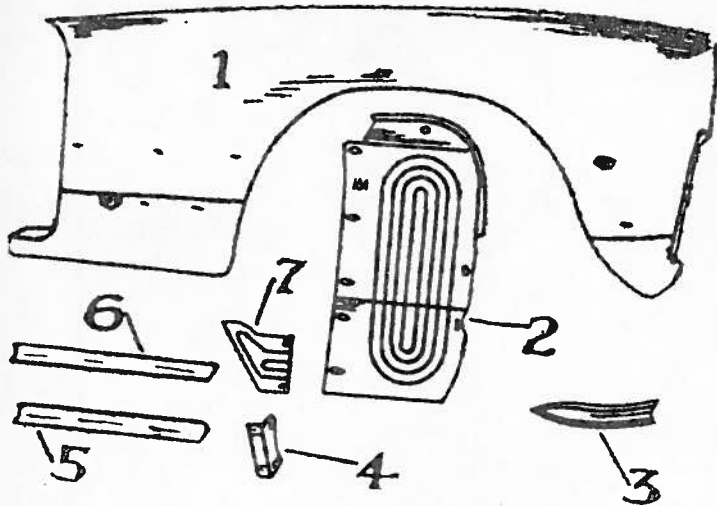

FRONT FENDER ASSEMBLY

Item	Part No.	Description	Price	Item	Part No.	Description	Price
1	1336867	Fender, L.	47.75	5	1328436	Molding, S.	2.10
2	1328703	Deflector, L.	2.00	6	1323654	Molding, T.	2.00
4	1328947	Bracket	1.65	7	1324995	Support, L.	.70

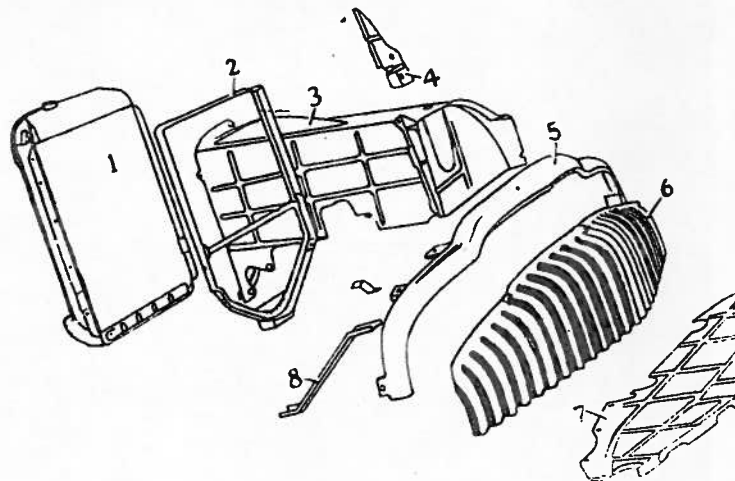

GRILL ASSEMBLY

Item	Part No.	Description	Price	Item	Part No.	Description	Price
1	3119868	Rad. core	61.40	6	1328888	Body, 1946	36.70
2	1323667	Strap	6.90	7	1331852	Body, 1947-48	36.70
3	1328235	Skirt, L.	6.75	7	1328787	Pan	4.25
4	1324941	Baffle, L.	1.45	8	1325846	Brace	.50
5	1328844	Frame, 1946	12.25	9	1326573	Bracket, L.	.30
5	1331750	Frame, 1947-48	15.00				

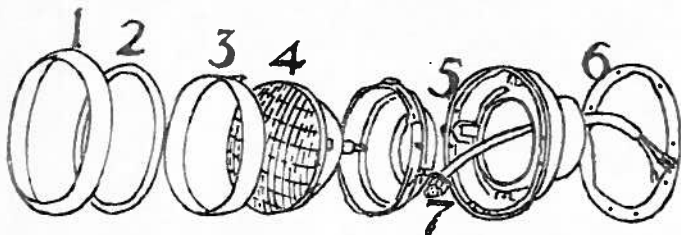

HEADLIGHT ASSEMBLY

Item	Part No.	Description	Price	Item	Part No.	Description	Price
1	5932753	Rim	2.20	5	5931849	Body	4.15
2	5932210	Gasket	.20	6	1320452	Gasket	.60
3	924534	Ring	.65	7	5933232	Wiring	1.10
4	925000	Sealed B. unit	1.35				

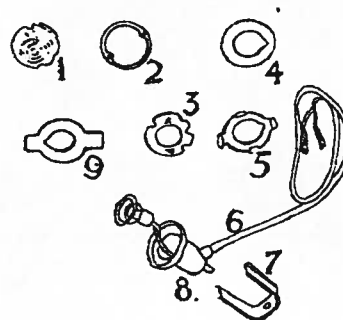

PARKING LIGHT ASSEMBLY

Item	Part No.	Description	Price
1	5935956	Lens	.20
2	5933049	Door	.05
3	5935956	Gasket	.15
4	1328935	Pad	.40
5	1328936	Retainer	.10
6	5933205	Socket & wiring	1.10
7	1328934	Clamp	.15
8	5935950	Body	2.55
9	1328936	Seal	.10

BODY PARTS 1946 to 1948 BUICK

Series 50. ALL BODY STYLES

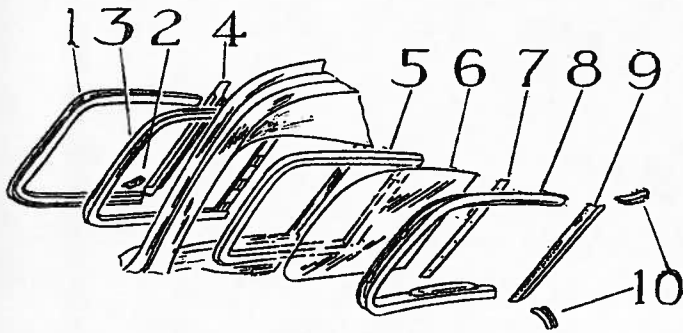

WINDSHIELD

Item	Part No.	Description	Price	Item	Part No.	Description	Price
1	4125651	Molding, 51, L....	3.50	6	4125238	Glass, 56S	13.10
1	4125768	Molding, 56C, L....	.60	7	4114718	Retainer, 51	.80
1	4125533	Molding, 56S, L....	3.50	7	4125801	Retainer, 56C	1.00
2	4144444	Molding	1.15	7	4125240	Retainer, 56S	1.00
3	4112599	Channel, 51	3.20	8	4148158	Molding, 51, L....	4.50
3	4125785	Channel, 56C	3.40	8	4131618	Molding, 56C, L....	10.25
3	4125415	Channel, 56S	3.20	8	4149950	Molding, 56S, L....	5.30
4	4125364	Molding, 51	1.90	9	4148155	Molding, 51	1.15
4	4125800	Molding, 56C	2.05	9	4125804	Molding, 56C	3.00
4	4125355	Molding, 56S	1.75	9	4149955	Molding, 56S	2.05
4	4125800	Molding, 56C, 56S.	2.05	10	4146891	Escutcheon, 51	.25
5	4112600	Channel, 51	4.90	10	4143492	Escutcheon, up., 56C	.25
5	4125798	Channel, 56C	6.00	10	4145758	Escutcheon, low., 56S	.25
5	4125416	Channel, 56S	3.80	10	4148156	Escutcheon, 56S.	.25
6	4125236	Glass, 51	14.70				
6	4131885	Glass, 56C	13.10				

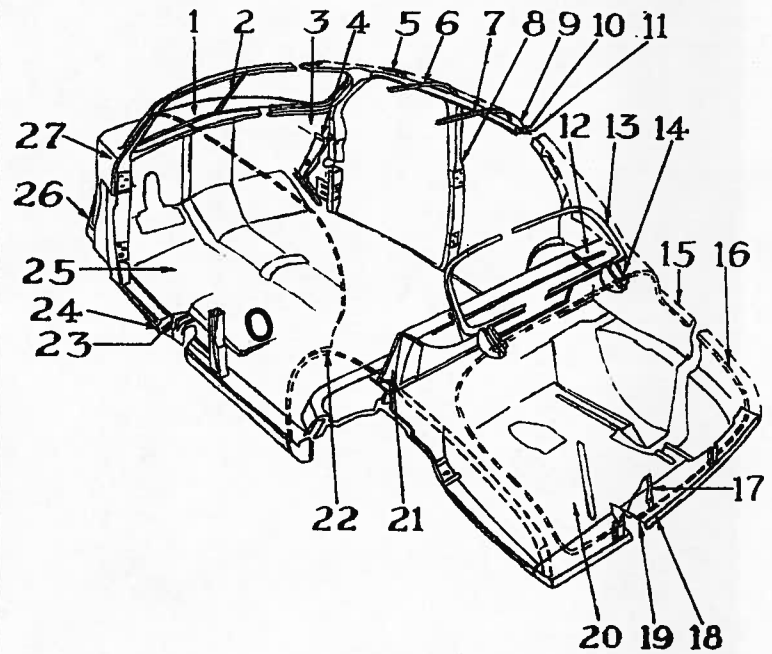

CAR BODY

Item	Part No.	Description	Price	Item	Part No.	Description	Price
1	4136992	Cowl & dash assy., 51	91.75	15	4148107	Panel, R.Q. 51	44.85
1	4147983	Cowl & dash assy., 56C & S	91.75	15	4141694	Panel, R.Q. 56C	51.00
2	4104096	Reinforcement, 51	.15	15	4148105	Panel, R.Q. 56S	52.35
2	4132768	Reinforcement, 56C	.20	16	4132679	Gutter, 51, L....	1.10
2	4132758	Reinforcement, 56S	.15	16	4132733	Gutter, 56C, L....	1.10
3	4141641	Brace, frame	1.30	16	4132717	Gutter, 56S, L....	1.10
4	4136970	Brace, low 51, 56S	.80	17	4133528	Lid, 51	35.00
4	4139639	Brace, low, 56C	.90	17	4141656	Lid, 56C	37.50
5	4125348	Bow 1, 51, 56S	2.30	17	4133530	Lid, 56S	3.30
6	4125351	Bow 2, 51	2.30	18	4148058	Panel, rear 51, 56C	4.90
6	4125350	Bow 2, 56S	2.30	18	4148060	Panel, rear 56S	2.80
7	4125352	Bow 3, 51	2.30	19	4115676	Panel, rear 56C	9.75
8	4148117	Pillar, 51	19.45	20	4136982	Pan., R. compt. 51	28.85
9	4136988	Panel, roof 51	23.95	20	4136985	Pan., R. compt. 56C & S	23.95
9	4136990	Panel, roof 56S	53.30	21	4161473	Brace, 51	.85
10	4133521	Rail, out. L. 51	5.30	21	4132703	Brace, 56S	.80
10	4133523	Rail, out. L. 56S	1.50	22	4350690	Panel, L.	4.50
11	4133519	Rail, in. 51	2.80	23	4133060	Panel, rock. in. L. 51	4.50
11	4132757	Rail, in. 56S	.95	23	4133062	Panel, rock. in. L. 56C & S	4.50
12	4133067	Panel, B. compt. 51	5.80	24	4148058	Panel, R. out.	4.50
12	4133066	Panel, B. compt. 56S	6.40	25	4136975	Panel, floor 51 L.	74.75
13	4133063	Panel, B. wind. in. 51	6.40	25	4141666	Panel, floor 56C	78.52
13	4133068	Panel, B. wind. in. 56S	6.80	25	4136978	Panel, floor 56S	74.75
14	4181406	Box, hinge 51	2.80	26	4141641	Brace, 51, 56S	1.30
14	4131409	Box, hinge 56C	2.30	26	4147940	Brace, 56C	1.95
14	4131404	Box, hinge 56S	2.30	27	4136961	Panel, C. side 51-56S, 56C, R.S.	6.00

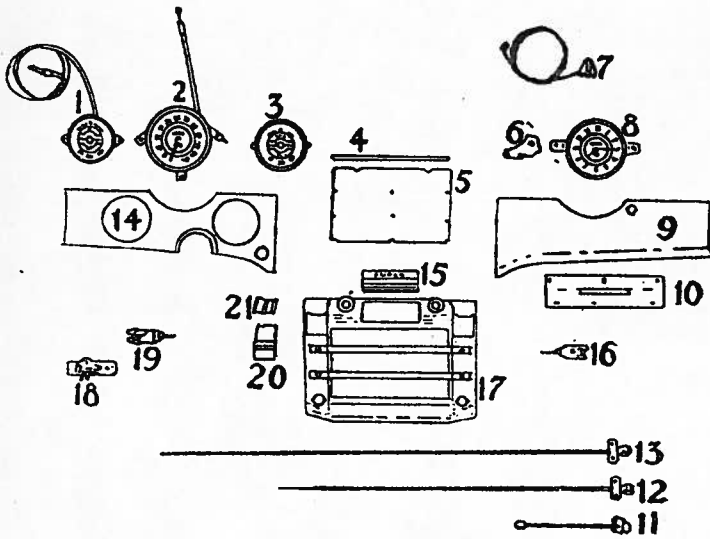

INSTRUMENT PANEL

Item	Part No.	Description	Price	Item	Part No.	Description	Price
1	See Attached Slip	Ammeter & Thermo. Gauge.		12	1327125	Button & wire	1.30
2	1566478	Speed., 1946 & 47..	20.00	13	1328307	Button & wire, 1946-47	1.30
2	1569717	Speed., 1948	23.50	13	1336854	Button & wire, 1948	1.15
3	U.M.S.	Gas & oil gauge..		14	1330884	Plate, 51, 56S, '46-'47	5.15
5	1326923	Grill	1.45	14	1336916	Plate, 51, 56S, 1948	5.00
6	4131785	Striker	.25	15	1324771	Plate	.85
7	1997771	Switch	.75	16	1997764	Switch	1.65
8	980791	Clock, 1946 & 47..	17.25	17	1323316	Grille	12.75
8	980794	Clock, 1948	17.25	18	1995016	Switch	2.50
9	4149981	Door, 51, 56S	12.00	19	1997762	Switch	1.65
9	4148241	Door, 56C	12.00	20	1323324	Receiver	1.50
10	4125935	Hinge	.95	21	1323331	Support	.30
11	1328266	Rod, 1946-47	1.15				
11	1333305	Rod, 1948	.35				

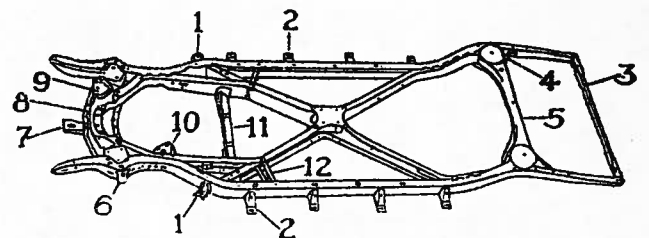

FRAME ASSEMBLY

Item	Part No.	Description	Price	Item	Part No.	Description	Price
1	1323315	Bracket	1.00	8	1393997	Member, 1946 & 47	14.50
2	1322927	Bracket	.60	8	1393887	Member, 1948	14.25
3	1317219	Member	1.75	9	1313801	Bracket, front L.	.45
4	1322021	Brace, L.	1.75	10	1328827	Bracket	.75
5	1320116	Member	7.50	11	1317265	Member	4.25
6	1317358	Stop	.60	12	1322860	Brace, 51, 56S	1.15
7	1319705	Bracket	1.15	12	1323699	Brace, 56C	.80

BUICK 1946 to 1948 BODY PARTS

Series 50. ALL BODY STYLES

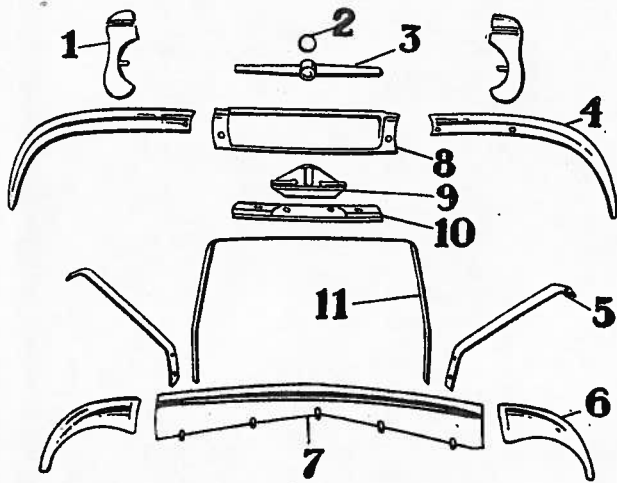

REAR BUMPER ASSEMBLY

Item	Part No.	Description	Price	Item	Part No.	Description	Price
1	1336987	Guard, L.	6.25	7	1328786	Shield, center	1.50
2	1331654	Monogram	1.25	8	1328376	Plate, center	11.75
3	1331389	Rail	4.75	9	1328392	Bracket	1.25
4	1328373	Plate, L.	20.75	10	1331389	Rail	4.75
5	1330653	Bar, out.	2.10	11	1328649	Bar, L.	1.25
6	1328765	Shield, out. L.	1.25				

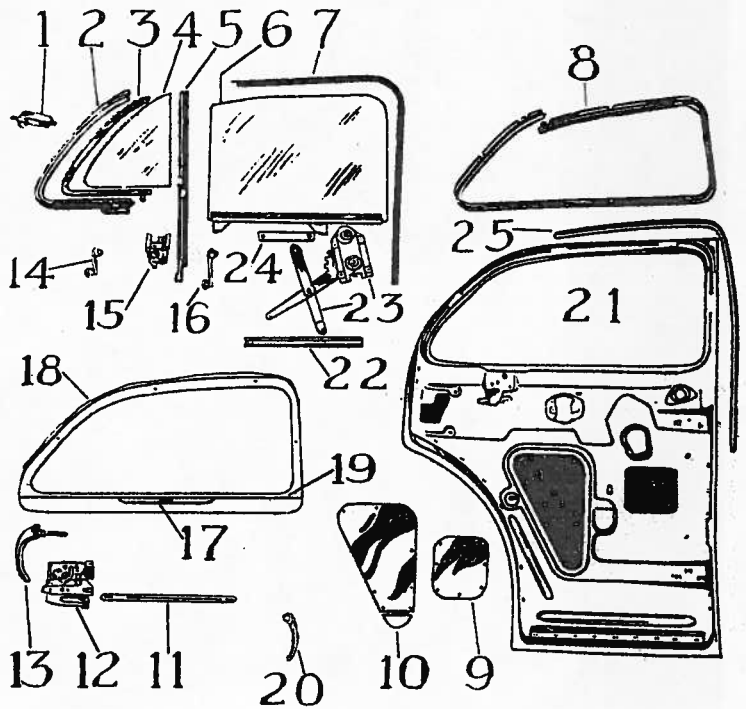

REAR DOOR

Item	Part No.	Description	Price	Item	Part No.	Description	Price
1	4128868	Lock	.60	13	4115302	Handle, out., 56S.	8.50
2	4125908	Weatherstrip	1.30	14	4125668	Handle, in.	1.45
3	4125904	Channel	4.70	15	4147130	Regulator, L., 51.	2.80
4	4125253	Glass, 51	3.50	16	4115747	Handle, reg., 51.	1.70
5	4131247	Channel, 51, L.	4.10	18	4147786	Handle, reg., 56S.	2.40
6	4125259	Glass, 51	11.25	17	4145747	Medallion	1.50
7	4045914	Channel, 51, 56S.	1.85	18	4148165	Molding, 51	10.10
8	4125384	Molding, L., 51.	9.00	19	4116743	Bead	1.00
9	4132687	Cover, front, 51 & 56S.	.60	20	4131636	Handle	1.30
10	4132759	Cover, rear, 51 & 56S.	.60	21	4147060	Door, L., 51	45.50
11	4181493	Link	.30	22	4149747	Cam, 56C	1.15
12	4125892	Lock	3.95	22	4099974	Cam, 51	.35
13	4143148	Handle, out., 51.	8.00	22	4099974	Cam, 56S	.35
13	4181302	Handle, out., 56C.	2.50	23	4114249	Regulator, L., 51.	4.50
				24	4091252	Cam, 51	.40
				25	4125547	Weatherstrip, 51.	1.90

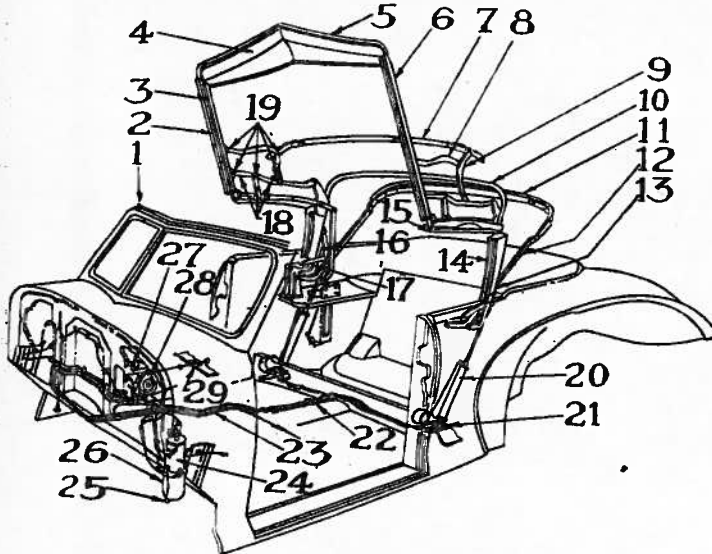

HYDRAULIC TOP

Item	Part No.	Description	Price	Item	Part No.	Description	Price
1	4131515	Stud, sides	.60	19	4141067	Screw	.17
1	4131516	Stud, center	.60	19	4112689	Bushing	.12
2	4130959	Weatherstrip, L.	1.15	19	4133646	Washer	.06
3	4161976	Retainer, L.	1.80	20	4149728	Cyl. assy.	10.35
3	4161976	Retainer, cent., L.	2.30	21	4149727	Support	1.40
4	4141662	Rail, front	23.90	22	4149724	Clip	.06
5	4141735	Weatherstrip, L.	1.50	23	384984	Tube	3.25
5	4145428	Weatherstrip, rear	3.40	24	4149729	Power unit assy., L.	52.35
6	4161982	Rail, front L.	10.85	24	4161766	Power unit assy., H.	43.50
6	4161980	Rail, rear L.	23.55	25	4161897	Ball, 1946	.35
7	4141731	Bow, front	6.75	25	4161897	Ball, 1947-48	.35
8	4147284	Link, front L.	3.40	26	4161898	Reservoir, 1946	2.30
9	4147280	Iron, L.	4.00	26	4161898	Reservoir, 1947-48.	2.30
10	4141735	Bow, front	40.35	27	4149734	Breaker	1.75
11	4141730	Bow, rear	10.85	28	4149731	Val. & sw. assy., early	6.90
12	4147282	Iron, rear L.	7.50	28	4161041	Val. & sw. assy., late	7.75
13	4133591	Bumper, low, L.	.20	29	4149737	Knob	1.90
14	4144548	Weatherstrip, L.	1.30				
15	4144556	Weatherstrip, L.	2.45				
16	4147277	Link, up.	3.00				
17	4147278	Link, low.	3.60				
18	4147286	Link, L.	14.35				

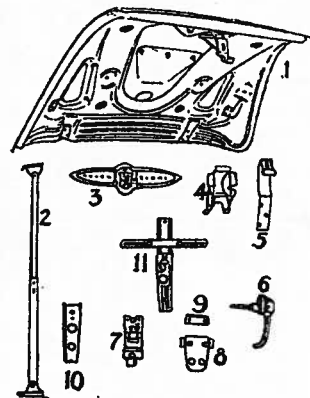

DECK LIDS

Item	Part No.	Description	Price
1	4133528	Lid, 51	35.00
1	4141656	Lid, 51C	37.50
1	4133530	Lid, 51S	37.50
2	4131757	Support	3.40
3	1323136	Emblem	.12
4	4131409	Box hinge, 51C, L.	2.30
4	4131406	Box hinge, 51	2.30
4	4131404	Box hinge, 51S	2.30
5	4131402	Strap, 51, 56S	1.75
5	4131407	Strap, 56C	2.30
6	4148245	Handle	8.50
7	4129651	Lock, 56S	2.75
7	4131433	Lock, 51, 56C	3.00
8	4146714	Plate, 51, 56C	.60
9	4131037	Striker, lock	.40
10	1317884	Pad	.23
11	927422	Lamp assy.	5.60

BODY PARTS 1946 to 1948 BUICK

Series 50. ALL BODY STYLES

REAR FENDER ASSEMBLY

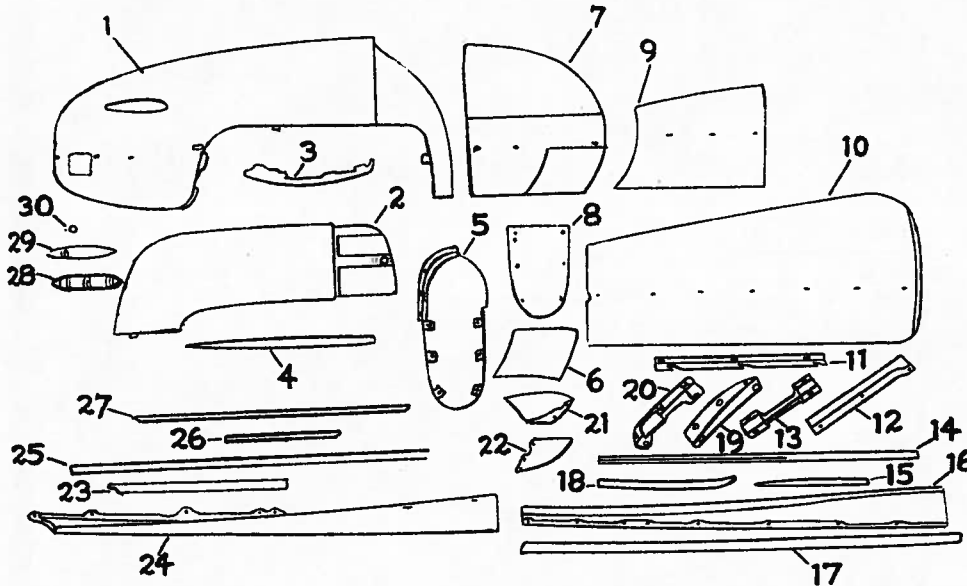

Item	Part No.	Description	Price
1	1330253	Fender, L.	18.05
2	1328805	Shield, L.	13.50
3	1324393	Deflector, L.	1.00
4	1328443	Moulding	2.25
5	1325513	Deflector, L.	1.65
6	1330777	Shield, L.	7.25
7	1328761	Extension, L.	8.25
8	1325513	Deflector, L.	1.65
9	1328869	Extension, 51	6.25
9	1328877	Extension, 56C L.	4.65
9	1328875	Extension, L. 56S.	4.65
10	1328868	Extension, L. 51...	6.25
10	1328856	Extension, L. 56C.	12.25
10	1328857	Extension, L. 56S.	12.25
11	1328747	Support, L.	.70
12	1328939	Bracket	.40
13	1325002	Bracket	.12
14	1328438	Molding, 51	3.50
14	1328840	Molding, 56C	3.85
14	1328841	Molding, 56S	8.85
15	1328441	Molding, 51	1.75
15	1328842	Molding, 56C	1.75
15	1328843	Molding, 56S	1.75
16	1328835	Mat, 51	4.25
16	1328821	Mat, 56C	4.50
16	1328819	Mat, 56S	4.50
17	1328633	Molding, 51	1.75
17	1328815	Molding, 56C	1.45
17	1328813	Molding, 56S	1.45
18	1330004	Molding, 51	1.85
18	1333866	Molding, 56C, 56S	5.25
19	1328921	Support, rear 51...	5.25
19	1328899	Sup., R. 56C, 56S	.75
20	1328861	Support, F. 51 L.	.60
20	1328895	Sup., F. 56C, 56S, L.	.60
21	1336219	Extension, L. 51	4.25
21	1328825	Extension, L. 56C	4.25
21	1328823	Extension, L. 56S	5.25
22	1336216	Plate, 51	1.15
23	1399923	Welt	.12
24	1328891	Extension, L.	4.25
25	1399923	Welt	.12
26	1330383	Edging	.70
27	1324762	Edging, 51	.80
27	1330390	Edging	.80
28	5933242	Reflex, gasket	.15
29	5933200	Reflex, B. plate	1.10
30	5932852	Reflex, lens	.95

FRONT DOOR

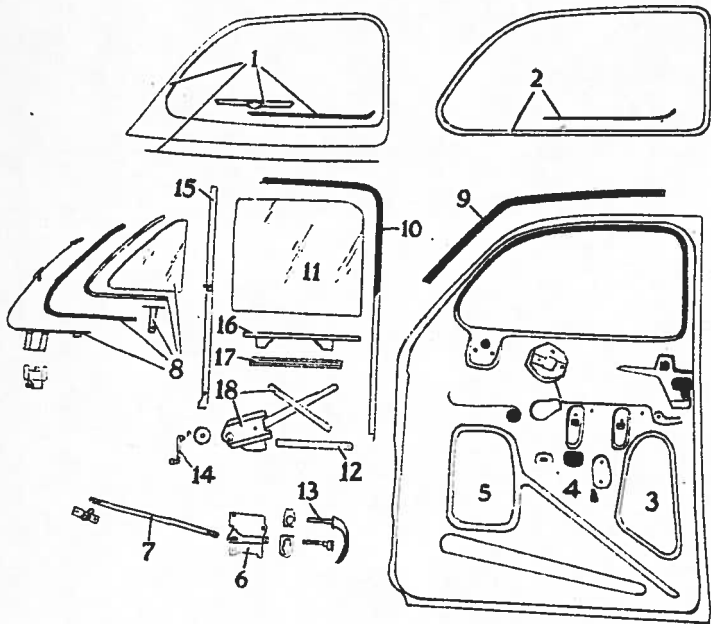

Item	Part No.	Description	Price
1	4148163	Mold. assy., 51, L.	7.75
1	4131820	Mold. assy., 56C, L.	7.75
1	4149969	Mold. assy., 56S, L.	11.25
2	4125560	Mold. assy., 51, 56C	7.85
2	4125558	Mold. assy., 56S...	14.95
3	4132720	Cover, rear	.80
4	4149782	Door, 51	45.50
4	4147281	Door, 56C	48.00
4	4149802	Door, 56S	48.00
5	4132687	Cover, front	.60
6	4118800	Lock, L.	4.25
7	4131493	Link, 51	.30
7	4114741	Link, 56C	.30
7	4114548	Link, 56S	.30
8	4125697	Vent. assy., L., 51	17.95
8	4133659	Vent. assy., L., 56C	48.85
8	4143150	Vent. assy., L., 56S	16.45
9	4147568	Weatherstrip, 51C.	2.05
9	4132022	Weatherstrip, 51, 56S.	2.30
10	4045914	Channel, 51, 56S.	1.65
10	4133576	Channel, 56C	2.30
11	4125257	Glass, 51	11.25
11	4125258	Glass, 56C	14.00
11	4125256	Glass, 56S	13.10
12	4078937	Cam, 51	.50
12	4078936	Cam, 56C & S	.35
13	4114734	Handle, 51	3.75
13	4131302	Handle, 56C	2.50
13	4115302	Handle, 56S	3.50
14	4125669	Handle	2.30
15	4146900	Channel, 51, L.	4.50
15	4133668	Channel, 56C, L.	9.00
15	4146957	Channel, 56S, L.	4.50
16	4125928	Channel, L., 51	.95
16	4131058	Channel, L., 56C	4.10
16	4125926	Channel, L., 56S.	1.30
17	4099974	Cam, 51	.35
17	4099974	Cam, 56C & S	.35
18	4113790	Regulator, 51	4.90
18	4125848	Regulator, 56C & S	5.60

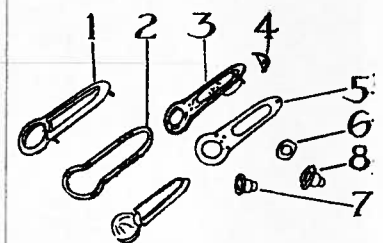

REAR LIGHT ASSEMBLY

Item	Part No.	Description	Price
1	5933032	Frame	2.85
2	1327674	Pad	.50
3	5933029	Body	.75
4	1325152	Reinforcement	.66
5	5932821	Gasket	.45
6	5937190	Gasket, signal	.05
7	5932818	Socket, J.L.	.65
8	5937287	Socket, signal	1.30
9	5932819	Lens	1.30

BUICK 1946 to 1948 FRAME

Series 50. ALL BODY STYLES

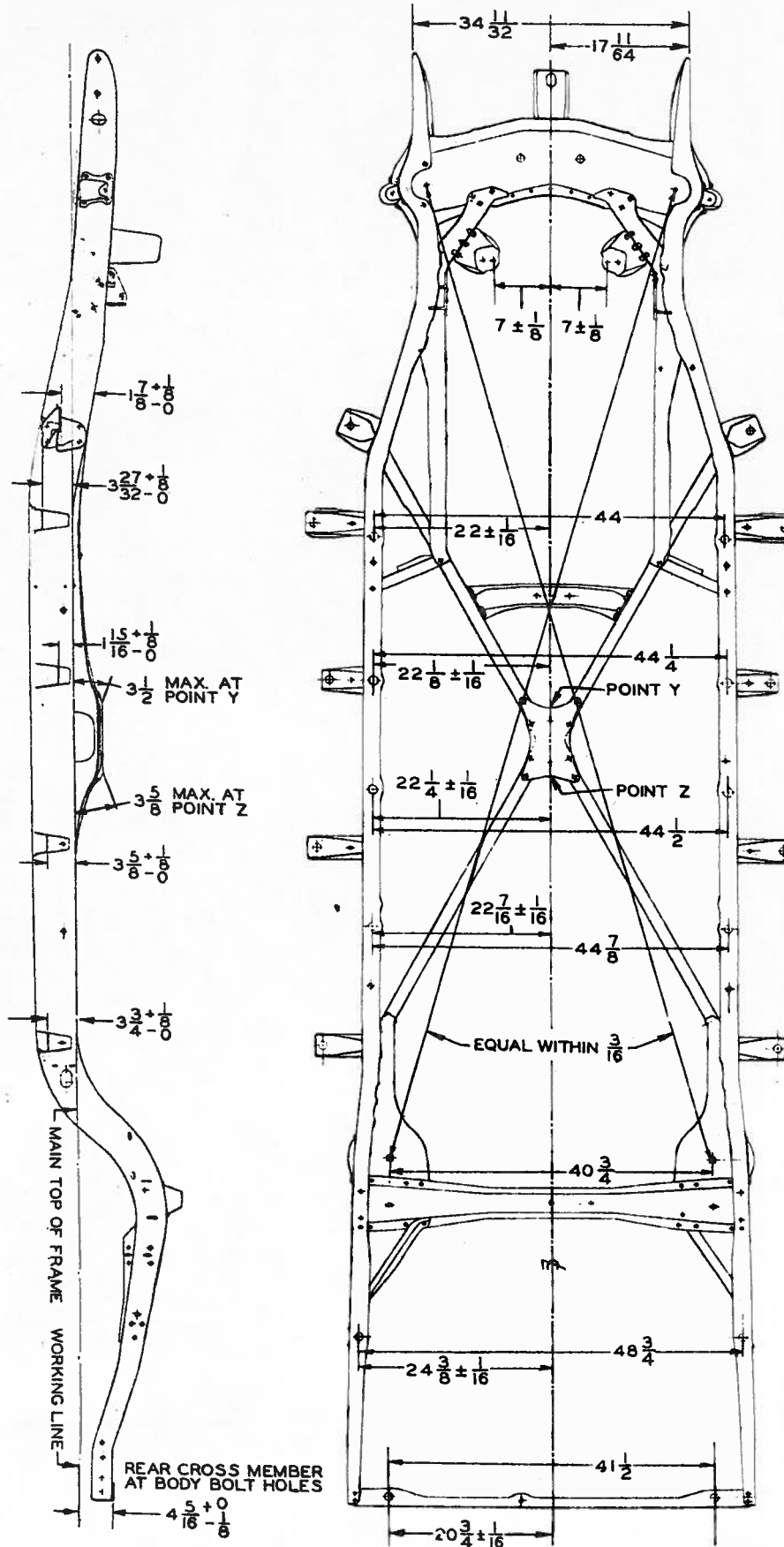

WIRING 1946 to 1948 BUICK

Series 50. ALL BODY STYLES

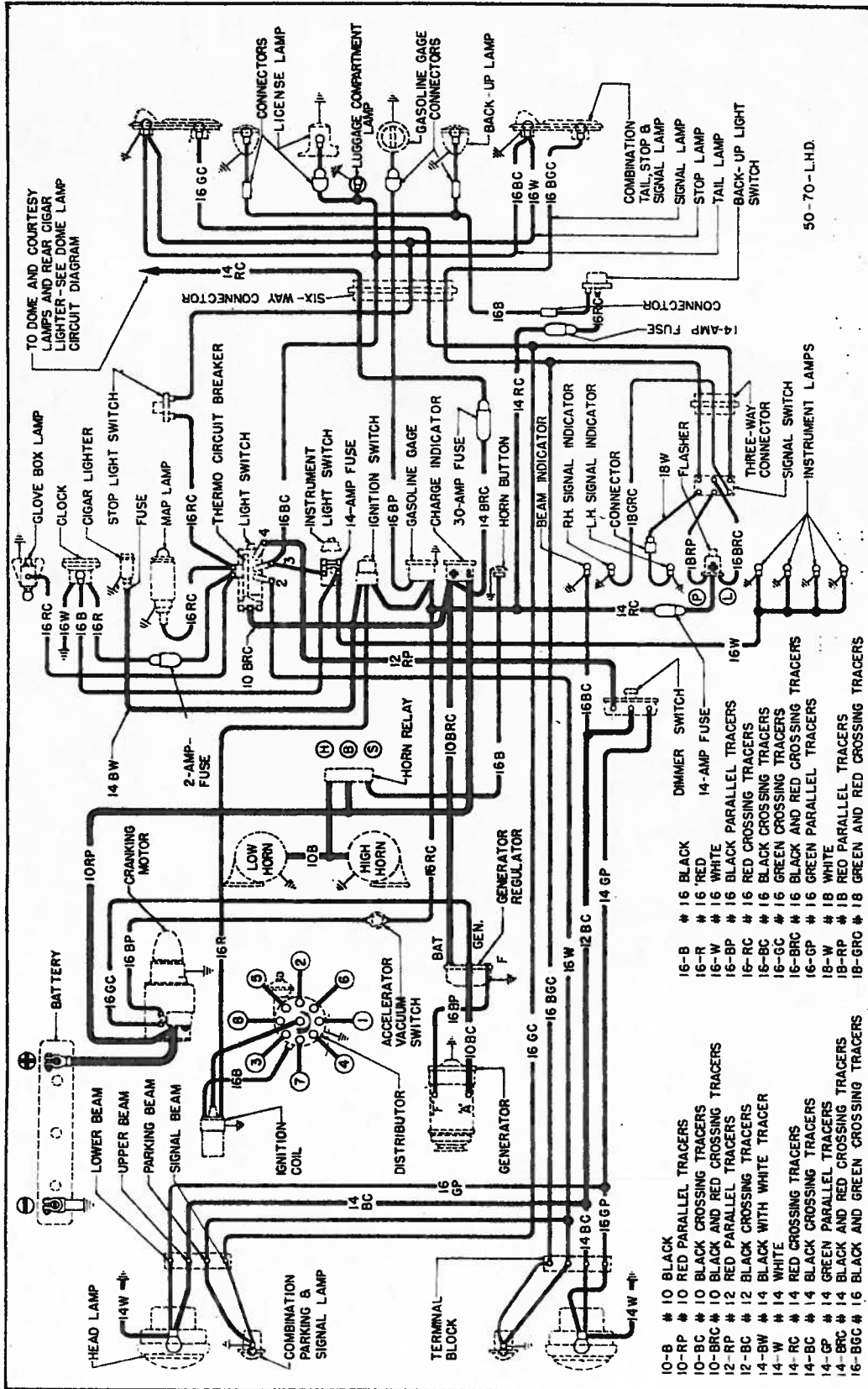

Wiring Diagram 1948 Series 50

BUICK 1946 to 1948 WIRING

Series 50. ALL BODY STYLES

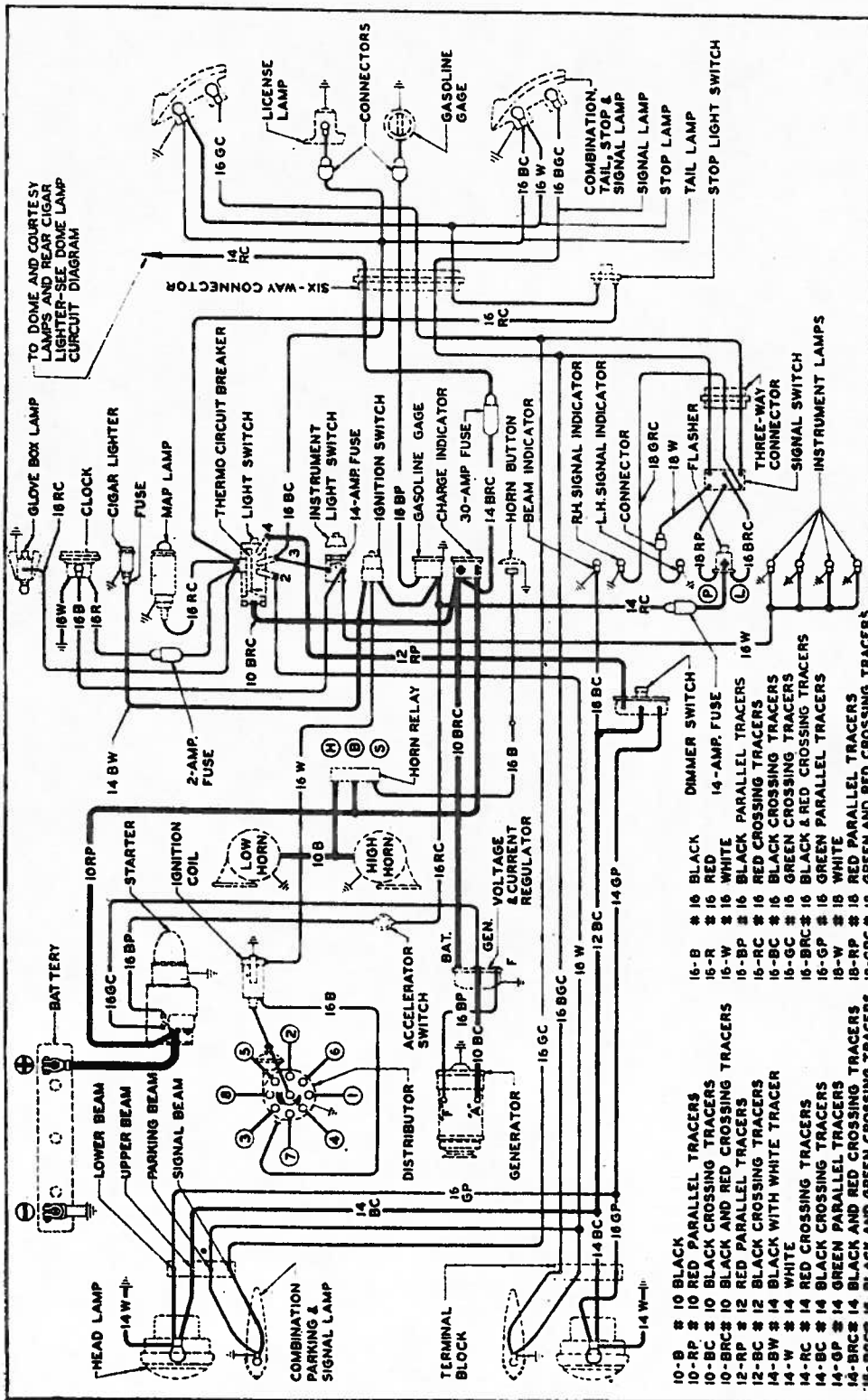

Wiring, 1946-47 Series 50

FLAT RATE 1946 to 1948 BUICK

Series 50. ALL BODY STYLES

Chilton Job No.	Chilton Labor Price	Chilton Job No.	Chilton Labor Price	Chilton Job No.	Chilton Labor Price	Chilton Job No.	Chilton Labor Price	Chilton Job No.	Chilton Labor Price	Chilton Job No.	Chilton Labor Price	Chilton Job No.	Chilton Labor Price	Chilton Job No.	Chilton Labor Price	Chilton Job No.	Chilton Labor Price			
A		A—continued		A—continued		B—continued		C—continued		D		E—continued		E—continued		F—continued		G		
1.....	4.00	6.....	20.00	20.....	4.00	9.....	3.00	4.....	3.00	1.....	4.00	3.....	32.50	13.....	120.00	3.....	32.50	1.....	110.00	
1a.....	3.50	7.....	3.00	20x.....	7.00	10.....	4.50	5.....	4.00	1a.....	3.50	4.....	32.50	14.....	105.00	4.....	2.00	2.....	28.00	
2.....	2.50	8.....	3.00			11.....	3.50	6.....	2.00	2.....	3.00	5.....	32.00	15.....	80.00	5.....	5.00	3.....	32.50	
3.....	6.50	9.....	4.00	B		12.....	4.00	7.....	2.00	3.....	6.50	6.....	30.00	16.....	60.00	6.....	7.00	4.....	32.00	
4.....	18.50	10.....		1.....	4.00	13.....	12.00	8.....	3.00	4.....	12.00	7.....	16.00	17.....	60.00	7.....	2.00	5.....	16.00	
4a.....	3.00	11.....	3.00	1a.....	7.00	14.....	3.00	9.....		7.....	16.00	7x.....		18.....	20.00	8.....	3.75	6.....		
4b.....	3.00	12.....		2.....	24.00	15.....	1.25	10.....	3.50	7x.....		8.....	70.00	19.....	12.00	9.....		7x.....		
4c.....	6.00	13.....		3.....	32.50			11.....	3.50	19.....	12.00	8x.....	80.00			10.....	4.50	8.....	75.00	
4e.....	6.00	14.....		4.....	3.00	C		12.....	4.00	20.....	4.00	8y.....	75.00	F		11.....	3.50	9.....	45.00	
5.....	12.75	15.....		5.....	3.75	1.....	4.00	13.....	10.00	1.....	110.00	9.....	45.00	1.....	4.00	12.....	4.00	10.....	50.00	
5a.....	4.00	16.....	4.00	6.....	4.50	1a.....	7.00	14.....	3.00	2.....	28.00	10.....	50.00	1a.....	6.50	13.....	12.00	11.....	50.00	
5b.....	4.00	17.....		7.....	2.00	2.....	24.00	15.....	3.00	3.....	32.50	11.....	50.00	2.....	24.00	14.....	3.00	12.....	12.00	
5c.....	4.00	18.....	10.00	8.....	3.75	3.....	32.50	16.....	1.25			12.....	12.00					13.....	12.00	
5d.....	4.00																	14.....	3.00	
5e.....	6.00																		19.....	12.00

STEERING GEOMETRY

1946-1947 MODELS

CASTER: $\frac{3}{8}$ degree positive desired. Limits: $\frac{1}{8}$ degree positive to zero degree.

CAMBER: $\frac{3}{8}$ degree positive desired. Limits: $\frac{1}{8}$ degree positive to $\frac{5}{8}$ degree negative.

TOE-IN: $\frac{1}{16}$ to $\frac{1}{8}$ inches.

TOE-OUT: Outer 20 degrees. Inner turns $21\frac{1}{2} \pm \frac{3}{4}$ degree.

KING PIN INCLINATION: $4\frac{1}{4}$ degree at $\frac{3}{8}$ degree camber.

1948 MODELS

CASTER: $\frac{3}{4}$ degree positive desired. Limits: $\frac{1}{4}$ degree to $1\frac{1}{2}$ degree positive.

CAMBER: $\frac{3}{8}$ degree positive desired. Limits: $\frac{1}{8}$ degree positive to $\frac{5}{8}$ degree negative.

TOE-IN: $\frac{1}{16}$ to $\frac{1}{8}$ inches.

TOE-OUT: Outer 20 degrees. Inner turns $21\frac{1}{2} \pm \frac{3}{4}$ degree.

KING PIN INCLINATION: $4\frac{1}{4}$ degree at $\frac{3}{8}$ degree camber.

ALL MODELS

CASTER: Is controlled by **FULL TURNS** of the upper eccentric pin.

CAMBER: Is controlled by eccentric upper pin and full range is obtained in one half turn.

TOE-IN: Should be adjusted at both tie rods to centralize the steering. Turn both rods in direction of forward wheel rotation to decrease toe-in.

